

General Information

Project Name: _____

Consultant: _____

Item #: _____

Model #: _____

Quantity: _____



Model #WTS-2842

Specifications

WTS Mobile Serving Tables are constructed of 14GA or 16GA type 300 series S/S top & 18GA type 300 series S/S undershelf.

16GA S/S top w/ S/S reinforcement channels come standard. An 18GA S/S 6" apron is placed on all (4) sides of the table.

Legs are constructed of 16GA 1¼" x 1¼" square tubing that is fully welded to the top & apron.

An integrated 16GA S/S 12" wide "V" tray slide is mounted on drop down brackets & easily folds down when ready to move table.

Unit comes with 5" casters, (2) with brakes.

Sound deadening is standard on all Model #WTS units.

Product Guide

Mobile Serving Tables are designed to conveniently maneuver around your facility & aid in your meal service.

Large worktop enables you to showcase & serve your most desirable foods.

The built-in tray slide can accommodate most tray sizes.

Welded undershelf provides extra storage space as needed.

Options

- ☐ **BAC** - Brakes on All Casters
- ☐ **AH** - Accessory Holder
- ☐ **LDS** - Drawer 20" x 20" x 5" or 15" x 20" x 5" w/ S/S Liner
- ☐ **UMD** - Drawer
- ☐ **US-16** - 16GA S/S Undershelf Upgrade
- ☐ **MTT** - Tubular Tray Slide (Specify Size)
- ☐ Custom Size Available



DRAWINGS

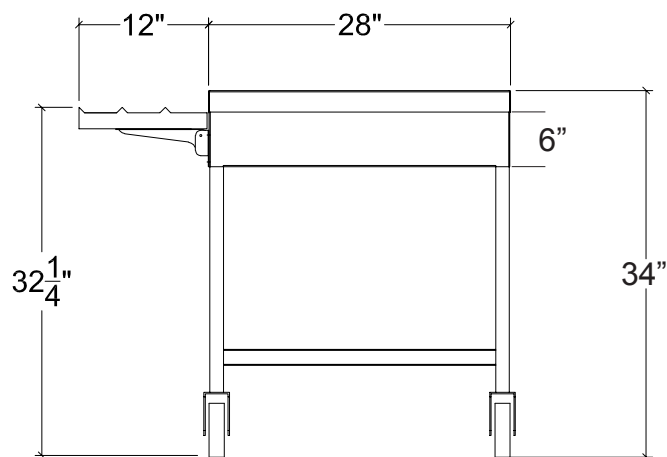

SECTION

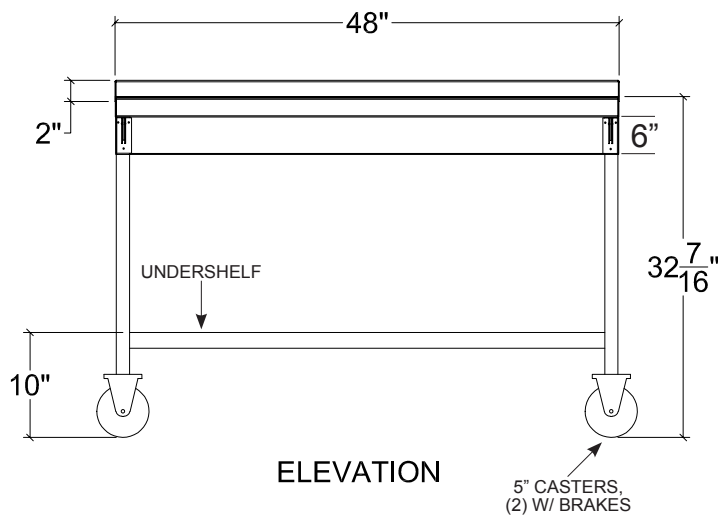

ELEVATION

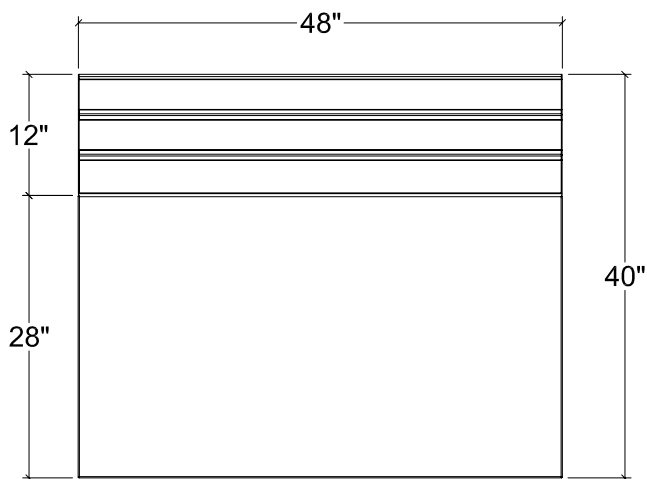

PLAN

MOBILE SERVING TABLE

14GA Model	16GA Model	Size (W x L x H)
□ WTS-2836	□ WTS-2836-16	28" x 36" x 34"
□ WTS-2842	□ WTS-2842-16	28" x 42" x 34"
□ WTS-2848	□ WTS-2848-16	28" x 48" x 34"
□ WTS-2854	□ WTS-2854-16	28" x 54" x 34"

Specifications subject to change without notice.

WTS-20 1023