

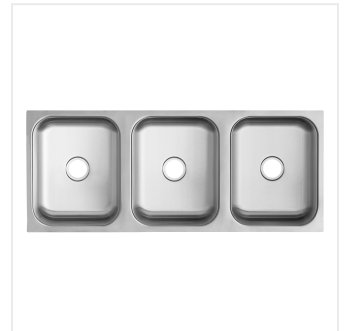

Waterloo 16" x 20" x 12" 18 Gauge Stainless Steel Three Compartment Undermount Sink

#750UMB31620

Item #: 750UMB31620 Qty: _____
 Project: _____
 Approval: _____ Date: _____



Features

- Undermount design enables sleek installation for a seamless surface
- Deep drawn 18 gauge type 304 stainless steel construction
- 3 1/2" drain opening
- Comes with sound deadening patches to reduce ambient noise in your kitchen
- Features 2" radius corners for ease of cleaning

Certifications



Technical Data

Length	55 1/2 Inches
Width	22 1/2 Inches
Height	12 Inches
Bowl Depth	12 Inches
Bowl Front to Back	20 Inches
Bowl Left to Right	16 Inches
Color	Silver
Corner Radius	2 Inches
Edge Style	Flush
Features	NSF Listed

Technical Data	
Gauge	18 Gauge
Installation Type	Undermount
Material	Stainless Steel
Number of Compartments	3 Compartments
Stainless Steel Type	Type 304
Type	Undermount Sinks

Plan View

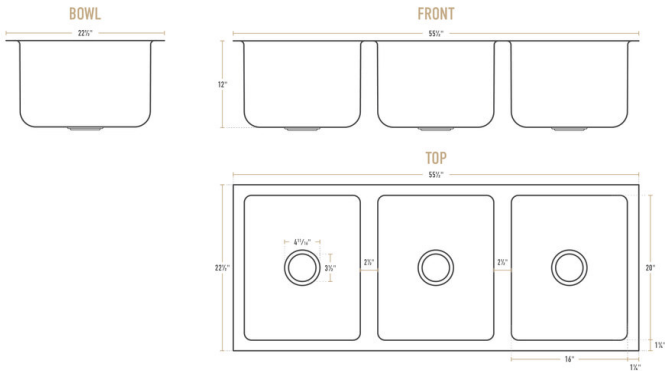

Notes & Details

Equip your kitchen, prep area, or bar with this Waterloo 16" x 20" x 12" 18 gauge stainless steel three compartment undermount sink. This sink features an undermount design. That means it is secured to the bottom of the countertop for a clean, professional, seamless installation. It's perfect for use in a front of the house bar area for washing, rinsing, and sanitizing your glassware, or as an addition to a kitchen area where you need additional dishwashing capacity.

Designed for durability, corrosion-resistance, and sanitation, each sink compartment is made of deep drawn 18 gauge, type 304 stainless steel. This sink features 2" radius corners that prevent grimy build-up and allow clean rinsing. To help reduce ambient noise in your busy kitchen or bar, this sink comes with sound deadening patches that are ready to install. Plus, the 3 1/2" drain openings are ready for installation so you can get your new sink up and running.

To get your sink up and running as quickly as possible, this unit comes with the required installation hardware.



WARNING: This product can expose you to chemicals including Lead and Nickel, which are known to the State of California to cause cancer and birth defects or other reproductive harm. For more information, go to www.p65warnings.ca.gov.