



BEVERAGE-AIR®

PROJECT: _____
ITEM # _____ QTY: _____
MODEL # _____
AIA # _____ SIS # _____
APPROVED: _____

VUEMAX™ OPEN-AIR MERCHANDISER

Model: VMHCSL-18-1-W

SLIM MODEL / WHITE EXTERIOR



3 Year Parts/Labor Warranty
5 Year Compressor Warranty

CABINET CONSTRUCTION

- White vinyl wrapped exterior
- Interior is painted steel for easy cleaning
- Electronic temperature control
- LowE double-pane glass tempered thermal sides
- Foamed in place CFC free polyurethane insulation enhances the structural strength of the cabinet and helps increase energy efficiency
- Shelves included can be installed in 2 positions for display flexibility
- Price tag molding
- Night curtain comes standard and helps save energy and maintain cabinet temperature
- Intended for use in rooms having ambient condition or 75°F/55% humidity
- LED lighting standard
- Certified for bottled beverages and packaged food product
- 6" Adjustable legs



OPTIONS & ACCESSORIES

- Front display merchandiser
- WonderBar/peg bar merchandiser
- 3" Casters
- 5" Casters
- Security cage with lock

REFRIGERATION SYSTEM

- Uses environmentally friendly, energy efficient R290 refrigerant, and meets all regulatory requirements for CARB, SNAP, DOE & more
- Maintenance free condenser slides out for easy service
- Automatic defrost
- Maintains product temperature between 36°F and 40°F



BEVERAGE-AIR®

VUEMAX™ OPEN-AIR MERCHANDISER

Model: VMHCSL-18-1-W

PLAN VIEW

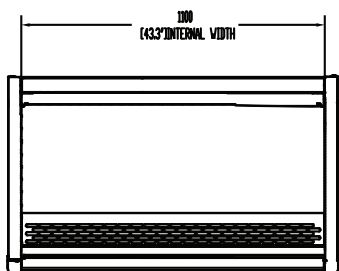

ELEVATION VIEW

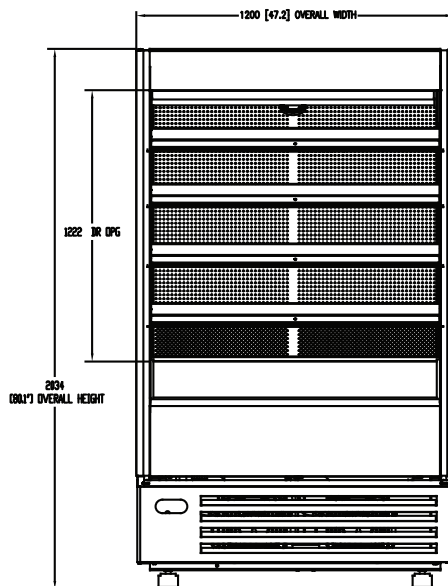

SIDE VIEW

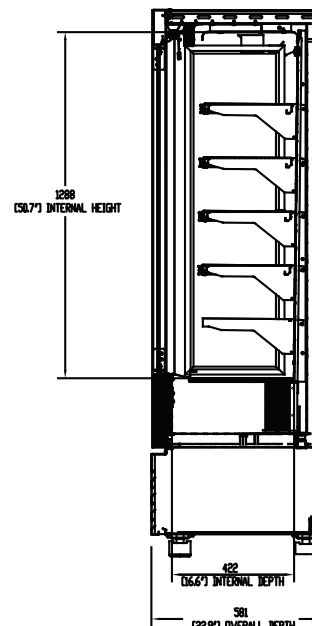

EXTERNAL DIMENSIONAL DATA	
Width Overall (in)	47 1/16"
Depth Overall (in)	24 9/32"
Height Overall (in)	83 1/2"
INTERNAL DIMENSIONAL DATA	
NET Capacity (cubic ft.)	23
Internal Width Useable (in)	43 5/32"
Internal Depth Overall (in)	22 25/32"
Internal Height Overall (in)	50 3/4"
Number of Shelves	5
Shelves Depth	12"
Shelves Width	42 1/5"

We reserve the right to change specifications and product design without notice. Such revisions do not entitle the buyer to corresponding changes, improvements, additions or replacements for previously purchased equipment. Dimensional tolerances +/- 1/4". Metric dimensions (MM).

ELECTRICAL DATA	
Full Load Amps	12
Voltage	120/60/1
Nema Plug (8' cord)	5-20P
REFRIGERATION DATA	
Horsepower	120/60/1
Capacity (BTU/Hr)	5400
Heat Rejection (BTU/Hr)	8250
Charge (lbs/grams/ounces)	0.5732 / 260 / 9.2
SHIPPING DATA	
Gross Weight - Crated	500 lbs.
Height - Crated (in)	83"
Width - Crated (in)	50"
Depth - Crated (in)	27"

ELECTRICAL CONNECTION



120/60/1
NEMA 5-20P

Unit pre-wired at factory and include 8' long cord and plug set.

3779 Champion Blvd., Winston-Salem, NC 27105 | 888-845-9800 | Fax: 336-245-6453 | Beverage-Air.com | Sales@bevair.com

Date Issued 8/25 | Printed in U.S.A.