

# CROSS-OVER LADDER - COL-4-36-23-HDG

APPROX WEIGHT: 325.59 lbs.  
DOES NOT INCLUDE WEIGHT OF POWER OR PACKAGING!!!

\*\*\* ANY ADDITIONS, DELETIONS, OR OMISSIONS MUST BE CORRECTED ON THIS DRAWING AS THIS DRAWING WILL BE CONSIDERED ALL INCLUSIVE \*\*\*

ALL GRAPHICS PROVIDED ARE FOR REFERENCE ONLY. IF CERTAIN DIMENSIONS ARE CRITICAL PLEASE VERIFY THOSE DIMENSIONS WITH YOUR SALESPERSON

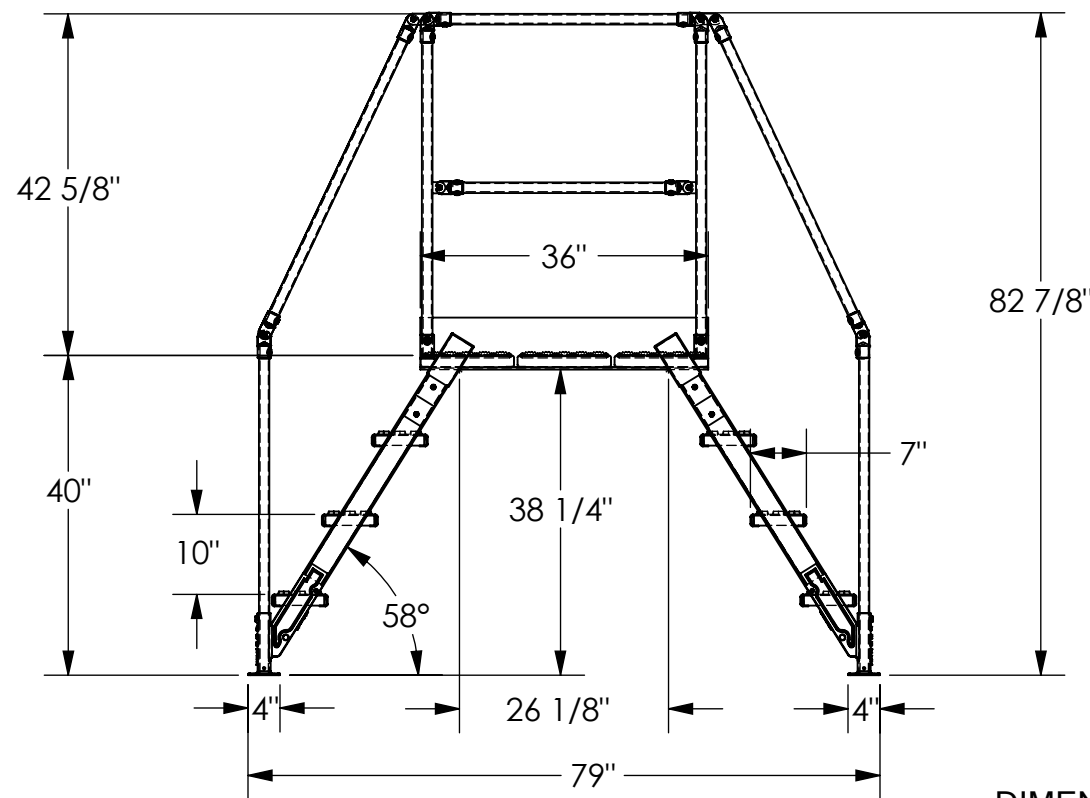
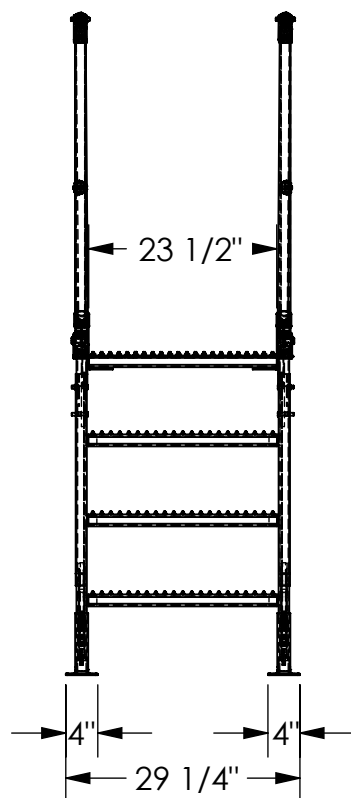

DIMENSION TOLERANCE  $\pm 1/4"$

## STANDARD FEATURES

MODEL NUMBER: COL-4-36-23-HDG  
OVERALL SIZE:

29 1/4" W x 79" L x 82 7/8" H

CLEARANCE SPAN:

26 1/8" W x 38 1/4" H

TOP PLATFORM HEIGHT: 40"

STEP HEIGHT SPACING: 10"

STEP DEPTH: 7"

STEP & PLATFORM WIDTH 23 1/2"

CLIMB ANGLE: 58°

HOT DIPPED GALVANIZED FINISH

ALL STEPS & PLATFORM ARE  
SERRATED STEEL

KNOCK-DOWN HANDRAILING  
(UNIT SHIPS KNOCKED DOWN,  
ASSEMBLY REQUIRED)

## SPECIAL FEATURES

NONE

### NOTE

UNIT MUST BE ANCHORED TO  
THE FLOOR!!!

Ø7/16" MOUNTING HOLES

8 TOTAL MOUNTING HOLES PER  
STANDARD UNIT

2 MOUNTING HOLES PER CORNER  
BRACKET

APPROVAL

I, THE UNDERSIGNED, AGREE THAT THE PRODUCT AS  
REPRESENTED SATISFIES DESIGN AND DIMENSION  
REQUIREMENTS. I ALSO ACKNOWLEDGE MY DUTY TO  
CONFIRM PRODUCT AND INSTALLATION  
COMPLIANCE WITH ALL APPLICABLE FEDERAL, STATE  
AND LOCAL REGULATIONS AND STANDARDS.

**UNITS REQUIRING APPROVAL DRAWINGS OR  
MODIFIED ARE NON-RETURNABLE**

[ ] As drawn [ ] As marked

Signed: \_\_\_\_\_ Date: \_\_\_\_\_

Printed Name: \_\_\_\_\_

LEAD TIME WILL START UPON RECEIPT OF SIGNED APPROVAL DRAWING

DISTRIBUTOR'S NAME:		P.O.#
VESTIL MANUFACTURING		X
DRAWN BY: BCN		W.O.#
DATE: 4/29/2016		X
REFERENCE: X	SCALE: 1:24	SALES: X
QUOTED LEAD TIME: X	QUOTE #	FILE NAME:
	X	44-007-733