



Project \_\_\_\_\_

Item 522EBTKD3060D Quantity \_\_\_\_\_

Approval \_\_\_\_\_ Date \_\_\_\_\_

# Steelton 30" x 60" 16 Gauge Type 430 Stainless Steel Enclosed Base Sliding Door Table

Item #522EBTKD3060D

### Special Features

- Durable 16 gauge type 430 stainless top with an 18 gauge type 430 stainless steel cabinet body
- Ships knocked down, saving on shipping costs
- 2 sliding doors with recessed handles fully conceal the cabinet base's contents
- Stainless steel legs, sockets, and bullet feet
- Large 30" x 60" worktop

### Technical Data

Length	60 Inches
Width	30 Inches
Height	34 Inches
Backsplash Height	Without Backsplash
Work Surface Height	34 Inches
Backsplash	Without Backsplash
Color	Silver
Door Style	Sliding
Features	NSF Listed With Undershelf



### Certifications



NSF Listed

Technical Data

Gauge	16 Gauge
Leg Construction	Stainless Steel
Material	Stainless Steel
Number of Doors	2 Doors
Number of Legs	4 Legs
Stainless Steel Type	Type 430
Table Style	Enclosed Base
Tabletop Material	Stainless Steel
Top Capacity	800 lb.
Type	Work Tables

Technical Drawing

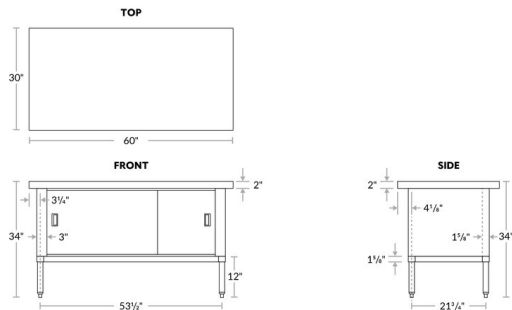

**⚠ WARNING:** This product can expose you to chemicals including lead, which are known to the State of California to cause cancer and birth defects or other reproductive harm. For more information, go to [www.p65warnings.ca.gov](http://www.p65warnings.ca.gov).