



Item No. _____

Quantity _____

Model No. SMC100

Mezzaluna Cutter



The perfect way to make a chopped salad. Place the meat and cheese into the bowl and add requested vegetables. Use the Stainless steel Mezzaluna Cutter, rock back and forth to chop the salad to the desired size. It will take approximately 6 to 8 passes. This is a simple and quick way to build a Chopped Salad.



Standard Features:

- Stainless steel blade
- High Density Polyethylene handle
- NSF Listed

NEMCO Food Equipment, Ltd.
301 Meuse Argonne Ave.
Hicksville, OH 43526
Phone 419-542-7751
FAX 419-542-6690
www.nemcofoodequip.com

Mezzaluna Cutter
Model No.
SMC100

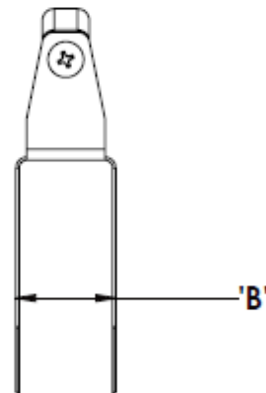
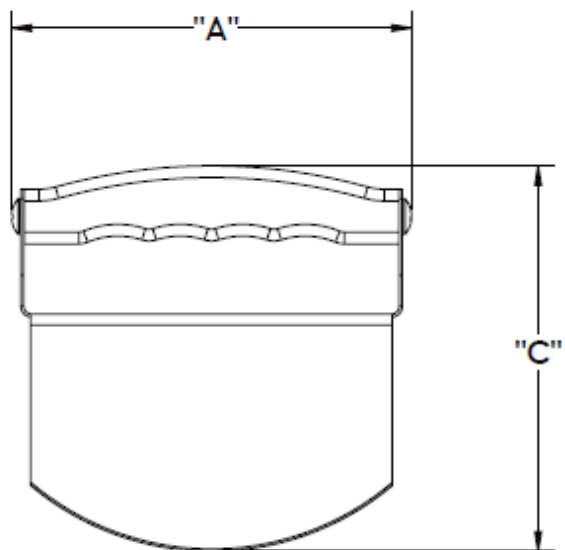

SPECIFICATIONS

Model No.	Width Inches/(cm) A	Depth Inches/(cm) B	Height Inches/(cm) C	Unit Weight lbs./(Kg)	Shipping Weight lbs./(Kg)
SMC100	6 3/8" (16.2)	1 5/8" (4.1)	6 13/16" (15.7)	0.8 (0.36)	1 (0.45)

TYPICAL SPECIFICATIONS

Mezzaluna Cutters are constructed of stainless steel blades and high density polyethylene handle. Cutters are Listed with the National Sanitation Foundation.



NEMCO Food Equipment, Ltd.
301 Meuse Argonne Ave.
Hicksville, OH 43526
Phone 419-542-7751
FAX 419-542-6690
www.nemcofoodequip.com

11/14 Printed in U.S.A.