

Floor Mount Stainless Steel Sink

Model
7250

Product Specifications

Built to last using 16-gauge, type 304 stainless steel.
Exposed surfaces have a satin finish.

Outside Dimensions	20" x 17-1/2" x 43-1/2" High
Inside Bowl Size	17" x 14" x 7" Deep
Back Splash Height	9-1/2"
Faucet Mounting Hole	7/8"
Drain Opening	2"
Finish	Satin
Strainer	1-1/2" Dia. Duo Basket Assembly

Includes

- (1) Floor mount sink
- (1) Leg assembly set
- (4) Washers and nuts for connecting sink to leg assembly set
- (1) Strainer assembly with basket

Product Compliance

NSF/ANSI 2 Food Equipment



Part: _____ Quantity: _____

Project: _____

Contact: _____

Date: _____

Approval: _____

Notes:



Floor Mount Stainless Steel Sink
Model 7250

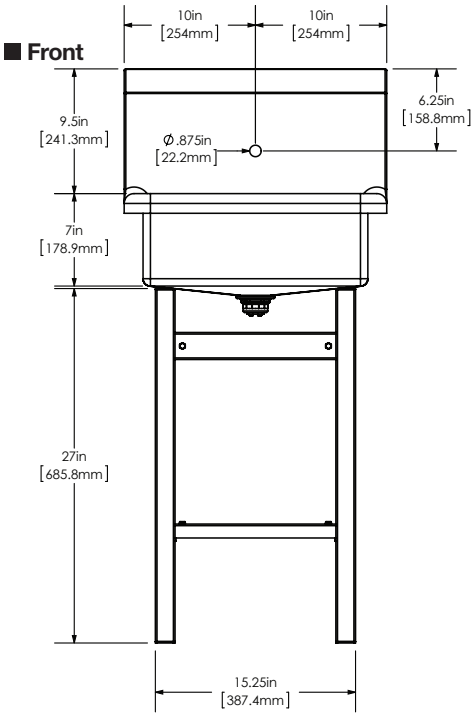
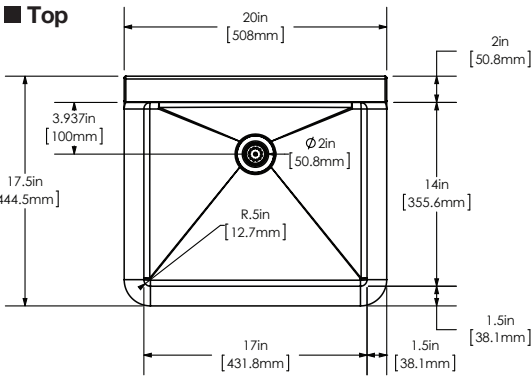

■ Hole Configuration

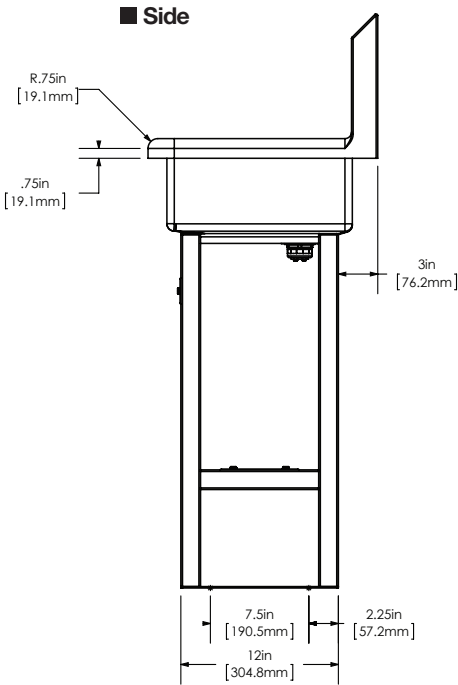
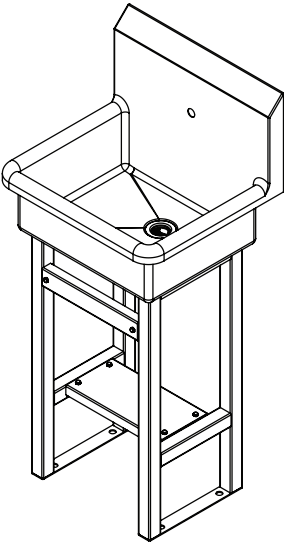
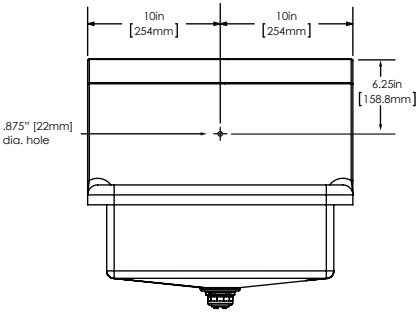

■ Floor Mounting Detail

