

Hands-Free Floor Mount
Stainless Steel Scrub Sink

Model	Flow-Rate
531F1	Standard 2.0 GPM
531F1-0.5	Low-Flow 0.5 GPM

Product Specifications

Seamless welded construction of 14-gauge type 304 stainless steel with a 1-1/2" rolled rim on front and sides. Exposed surfaces have a uniformed satin finish. Specially designed foot valve provides easy access to working parts without disconnecting mount or plumbing.

Outside Dimensions	25" x 20" x 45-1/2" High
Inside Bowl Size	22" x 16-1/2" x 10-1/2" Deep
Back Splash Height	8"
Water Activation	Single Foot Pedal Valve
Spout Mounting Hole	7/8"
Flow Rate	2 GPM
Inlet Connections	3/8" Male Compression
Drain Opening	3-1/2"
Finish	Satin
Strainer	Basket Type

Includes

- (1) Floor mount sink
- (1) Leg assembly set
- (4) Washers and nuts for connection sink to leg assembly set
- (1) Single foot pedal valve (bottom mount) with 2 nuts
- (1) Swivel gooseneck spout with aerator
- (1) Connecting tube for valve to spout connection
- (2) Fittings, brass, 0.375" male compression and 0.375" male NPT
- (1) Mixing check valve
- (1) Strainer assembly with basket

Product Compliance

NSF/ANSI 2 Food Equipment
NSF/ANSI 372 Low-Lead



Part: _____ Quantity: _____

Project: _____

Contact: _____

Date: _____

Approval: _____

Notes:

Hands-Free Floor Mount Stainless Steel Scrub Sink
Models 531F1 and 531F1-0.5

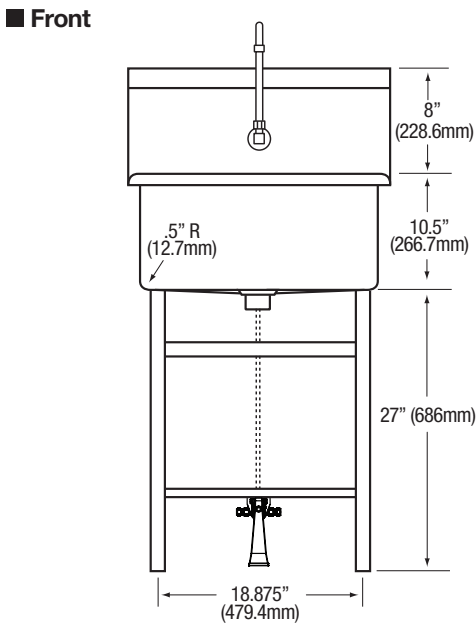
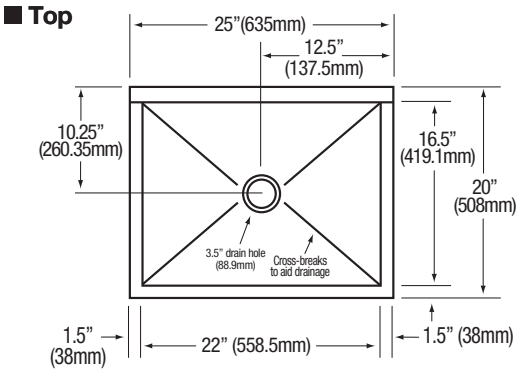

■ Hole Configurations

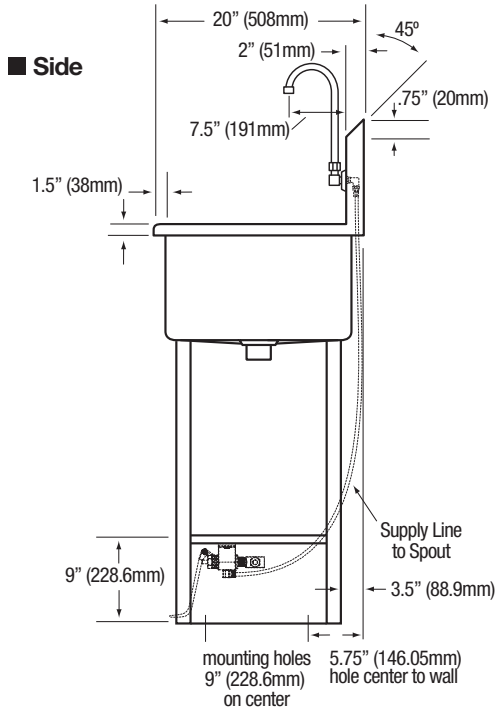
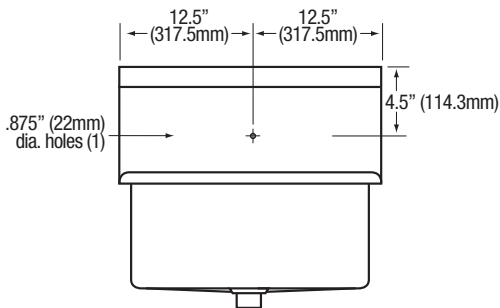

■ Floor Mounting Detail

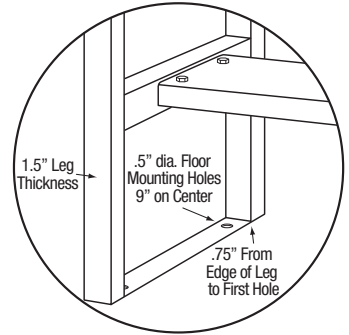

■ Plumbing Detail

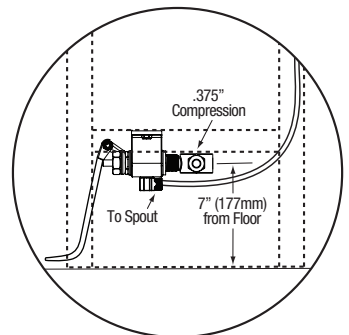

■ Supply Line Detail

