

Hands-Free Wall Mount Stainless Steel Sink

| Model | Flow-Rate |
|----------|------------------|
| 5051 | Standard 2.0 GPM |
| 5051-0.5 | Low-Flow 0.5 GPM |

Product Specifications

Hands-Free operation is ideal for use in food service applications. Deep drawn from heavy duty 18-gauge type 304 stainless steel with large rounded corners. Exposed surfaces have an electropolished finish to enhance resistance to corrosion, reduce any bacterial growth and make for easier cleaning. Specially designed knee valve provides easy access to working parts without disconnecting mount or plumbing.

| | |
|-----------------------|---------------------------------|
| Outside Dimensions | 19" x 18" x 16-1/2" High |
| Inside Bowl Size | 17" x 14" x 7" Deep |
| Back Splash Height | 9-1/2" |
| Water Activation | Single Knee Pedal Valve |
| Flow Rate | 2 GPM |
| Inlet Connections | 3/8" Male Compression |
| Drain Opening | 2" |
| Finish | Electropolished |
| Strainer | 1-1/2" Dia. Duo Basket Strainer |
| Wall Mounting Bracket | 1/4" Dia. Mounting Holes |

Includes

- (1) Wall mount sink
- (1) Single knee pedal valve with 2 nuts
- (1) Swivel gooseneck spout with aerator
- (1) Connecting tube for valve to spout connection
- (2) Fittings, brass, 0.375" male compression and 0.375" male NPT
- (1) Mixing check valve
- (1) Wall-mounting bracket
- (1) Strainer assembly with basket

Product Compliance

NSF/ANSI 2 Food Equipment
NSF/ANSI 372 Low-Lead



Part: _____ Quantity: _____

Project: _____

Contact: _____

Date: _____

Approval: _____

Notes:

Hands-Free Wall Mount Stainless Steel Sink
Models 5051 and 5051-0.5

Top

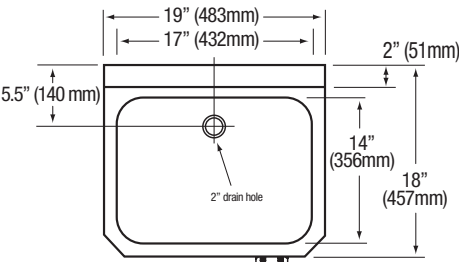

Front

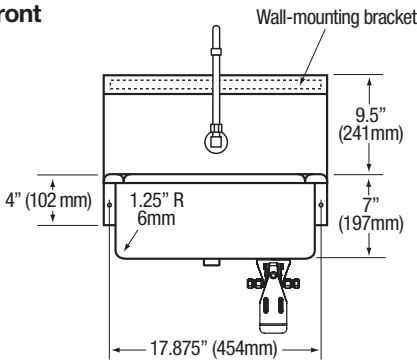

Side

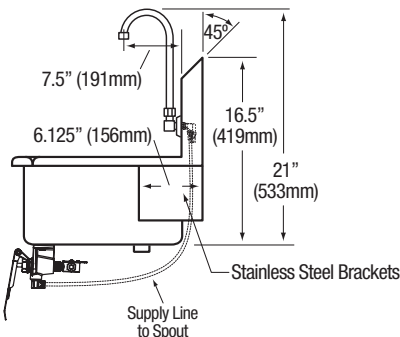

Hole Configuration

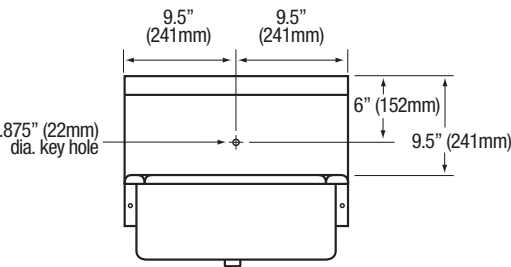

Wall Mounting Detail

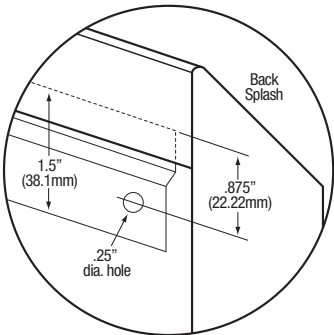

Supply Line Detail

