



Regency 20" x 20" x 5" Double-Stacked Drawer Set with Stainless Steel Front

#600DR2020ST2



Technical Data

Length	25 1/8 Inches
Width	24 Inches
Height	13 3/4 Inches
Drawer Insert Length	20 Inches
Interior Length	20 Inches
Drawer Insert Width	20 Inches
Interior Width	19 1/2 Inches
Drawer Height	6 7/8 Inches
Drawer Insert Height	5 Inches
Interior Height	5 Inches

Features

- Features a removable insert for easy cleanup
- Smooth operation thanks to ball-bearing slides
- Durable stainless steel and galvanized steel construction
- Easy to install with the included Z brackets; stacked 2 drawers high
- Works with 24", 30", and 36" deep Regency tables that are at least 36" long

Certifications



Technical Data

Color	Silver
Features	NSF Listed
Material	Galvanized Steel Stainless Steel
Number of Drawers	2 Drawers
Type	Drawers

Plan View

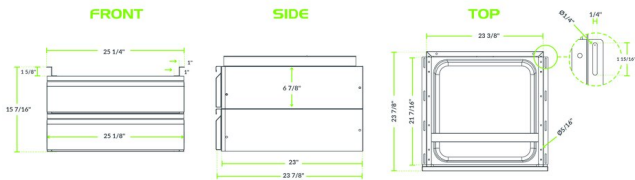

Notes & Details

Keep your kitchen organized by mounting this Regency Tables and Sinks 20" x 20" x 5" galvanized steel drawer to the hat channels under your work table. Each drawer features an easy-to-clean 20 gauge, type 430 stainless steel frame and moves on ball-bearing sides. The drawer pan is made of 22 gauge, type 304 stainless steel.

The drawer set contains 2 drawers, allowing you to increase storage capacity with ease. Installation is easy thanks to the pre-drilled Z-brackets - to mount the top drawer, simply drill through the table's hat channels and secure the drawer with screws. To install any additional drawers, drill into the bottom of the top drawer's frame, and use screws to mount the lower drawer.

This drawer is compatible with all 24", 30", and 36" deep Regency tables that are at least 36" long. It includes the screws and hex nuts necessary to mount the Z-brackets to the table, and to attach the drawers together.