



Regency Wall Mount Sink Faucet with 3 1/2" Swivel Gooseneck Spout and 4" Centers

#600FW44G



Technical Data

Spout Length	3 1/2 Inches
Faucet Height	8 1/2 Inches
Faucet Centers	4 Inches
Features	NSF/ANSI 372 NSF/ANSI 61
Finish	Chrome
Flow Rate	2 GPM
Handle Type	Lever
Material	Brass
Mounting Style	Wall Mounted

Features

- 3 1/2" long x 8 1/2" tall swivel gooseneck spout, 2 GPM flow rate
- 4" centers, 1/2" NPS inlets
- Wall mounted base, attractive chrome-plated brass construction
- 140 degree maximum water temperature
- Lever handle design

Certifications



NSF/ANSI 61 & 372



NSF Listed



CSA, US and Canada



1/2" Water Connection

Technical Data

Mounting Type	Workboard
Rough In	4 Inches
Spout Clearance	5 1/8 Inches
Spout Type	Gooseneck
Temperature Rating	140 Degrees F
Thread Size	55/64"-27 UNS
Type	Faucets
Water Inlet Size	1/2 Inches

Plan View

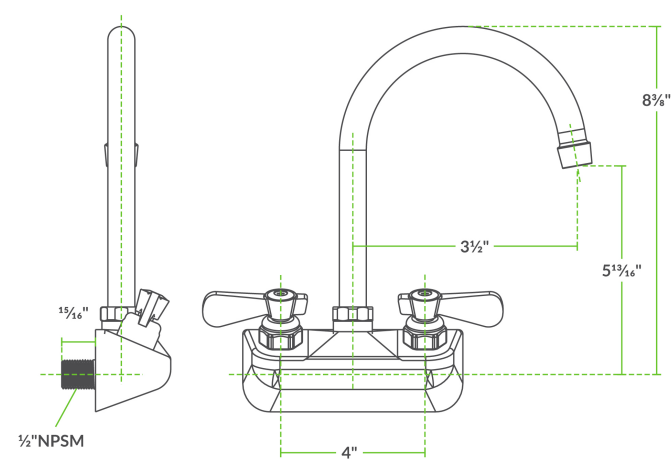

Notes & Details

Perfect for busy commercial kitchens, this Regency wall mount sink faucet with 3 1/2" swivel gooseneck spout is an excellent choice when you need a reliable, affordable water fixture for your facility! Designed to be easy to install and easy to maintain, it's easy to see why Regency faucets are a great solution for any business. Thanks to a 3 1/2" long and 8 1/2" tall swivel gooseneck spout, this faucet delivers water exactly where you need it. The hinged design provides excellent functionality for filling pots and pans, and it can be folded out of the way when not in use.

Water exits the faucet with a 2 GPM flow rate, which creates a soft flow pattern with minimal splashing. The faucet installs on your wall or sink backsplash on a pair of 4" centers and connects to the facility water lines with a set of 1/2" NPS inlets. The faucet body is made from chrome-plated brass that complements nearly any design aesthetic, and the water flow is controlled by a pair of simple lever handles. An installation kit is required for setup (sold separately).

 **WARNING:** This product can expose you to chemicals including lead, which are known to the State of California to cause cancer and birth defects or other reproductive harm. For more information, go to www.p65warnings.ca.gov.