

Job \_\_\_\_\_

# Metro® Mightylite™ Insulated Food Carrier Accessories



We put space to work.®

## Heater (MLH1, MLHX1)

Stainless steel, add-on carrier heater with polymer handles and rubber feet. Great for applications where carriers are frequently accessed or not 100% full, or simply when added heat is desired to keep food hotter, safer, and more appetizing. Thermostatically controlled, reaches max temperature in approximately 10 minutes. Approximate top-center surface temperature range from 150°F (66°C) to 200°F (94°C). 72" long, permanently attached power cord with cord wrap. Power indicator lights up when plugged in.

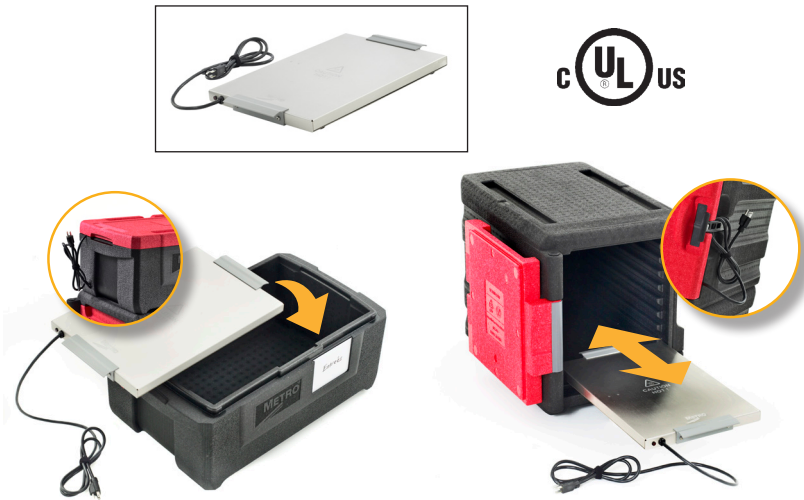

Cat. No.	Description	Electrical Specifications	Dimensions (W x D x H)		Shipping Weight	Shipping Volume
			(in)	(mm)		
MLH1	120V Heater for ML300, 400, 180, 180XL	120V, 200W, NEMA 5-15P	20.6 x 12.4 x 1.6	524 x 315 x 40	9.2 lbs (4.2 kg)	0.3 ft³ (0.01 m³)
MLHX1	240V Heater for ML300, 400, 180, 180XL	240V, 200W, NEMA 6-15P	20.6 x 12.4 x 1.6	524 x 315 x 40	9.2 lbs (4.2 kg)	0.3 ft³ (0.01 m³)

## Serving Ring (MLW1)

For use with top-load carriers and heater to transport & serve with a single solution that does not require water or canned fuel. Wire serving ring can also be used without carrier with chaffing pan and canned fuel. Accommodates full & fractional sized pans, and non-pan items such as individually portioned meals. Epoxy coated wire construction.

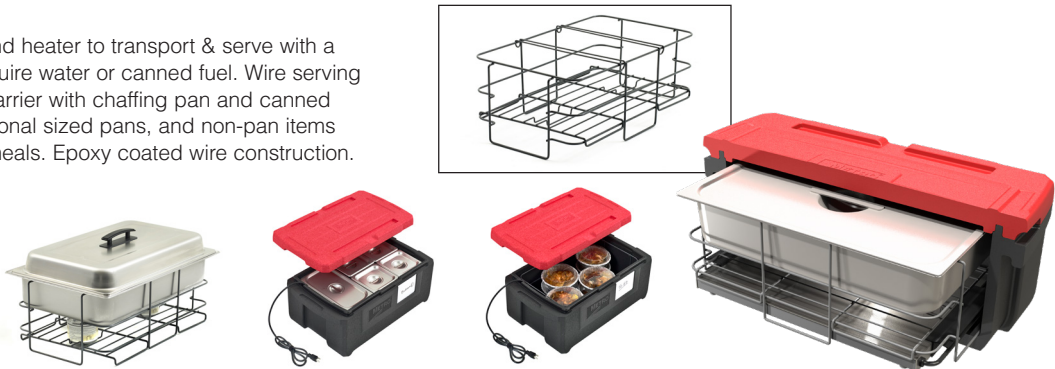

Cat. No.	Description	Dimensions (W x D x H)		Product Weight	Shipping Weight	Shipping Volume
		(in)	(mm)			
MLW1	Serving Ring ML180, 180XL	21.7 x 12.8 x 7.8	551 x 325 x 199	3.7 lbs (1.7 kg)	4.7 lbs (2.1 kg)	1.4 ft³ (0.04 m³)

## Carrying Strap (MLS1)

Heavy-duty adjustable strap, designed to work with top-load and front-load carriers. Detachable handles can be quickly re-configured for one-handed or two-person carrying. 1" (25mm) wide, high-strength polyester webbing with low water absorption properties. Box sewn stitch pattern with durable polymer / metal hardware



Cat. No.	Description	Shipping Weight	Shipping Volume
MLS1	Carrying Strap for ML300, 400, 180, 180XL	0.5 lbs (0.23 kg)	0.2 ft³ (0.005 m³)

an Ali Group Company



The Spirit of Excellence