

F

E

D

C

B

A

ITEM NO.	QTY.	PART NO.	DESCRIPTION
3	1	4498-B SH-GP # 4 WM	SMALL GOAL POST (SEE DRAWING#4498-B)
4	2	16363-C GRO LOCK PLT SB	LOCKING DEVIDE FOR GROCERY SIDEKICK (DWG # 16363-C)
	1	16363-1	2" X 3" 12 GA. CRS
	2	S0187F00187	3/16" X 3/16" FLAT HEAD STEEL RIVETS
	1	S0187F00750	3/16" X 3/4" FLAT HEAD STEEL RIVETS

NOTE
ADD HARDWARE KIT ZC255 TO THIS UNIT WHICH INCLUDES:

(QTY 2) GRO-LOCK PLT BV
(QTY 2) ZM1666
(QTY 2) ZC361
(QTY 2) ZA378

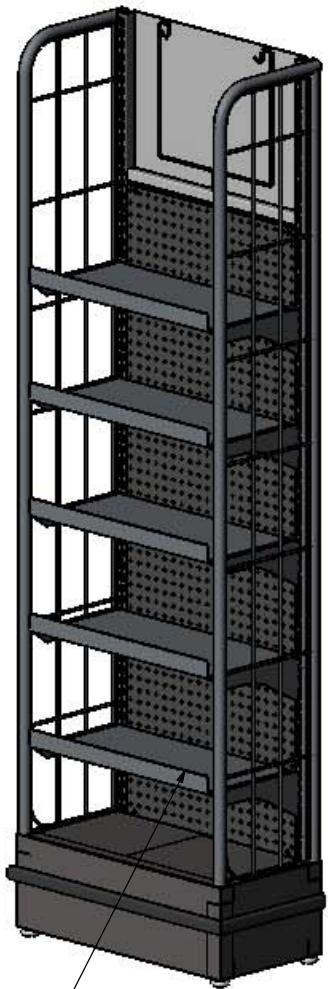

ALL SHELVES
ADJ/ REMOVABLE

WEIGHT: 108 LBS

ITEM NO.	QTY.	PART NO.	DESCRIPTION
1	1	7869 BASE STAND	BASE STAND ASSEMBLY
	1	7869 FRAMES ASSEMBLY	ALL METAL FRAMES ASSEMBLY
	1	7869 BASE	METAL BASE ASSEMBLY
	4	TUBE-1	1 1/2" X 1 1/2" X 6 1/2" TUBING
	2	TUBE-2	1 1/2" X 1 1/2" X 23 7/8" TUBING
	5	TUBE-3	1 1/2" X 1 1/2" X 8 7/8" TUBING
	2	BASE SIDE	8" X 11 7/8" 16 GA. CRS
	2	BASE FRONT & BACK	8" X 24" 16 GA. CRS
	1	TOP BASE	10 3/4" X 21 7/8" 16 GA. CRS
	4	7869 WELD NUT	WELD NUT FOR GLIDES
	1	WELD NUT PLATE	WELD NUT TAB 1 3/8"X1 3/8" 12 GAUGE CRS
	1	ZD070	3/8-16 WELD NUT
	4	ZM638	3/8-16X1 1/2" GLIDES
	1	7869 BACK FRAME	BACK FRAME ASSEMBLY
	2	UPRIGHT STANDARD	1"X1 1/8"X69 3/16" 12 GA. CRS FROMED CHANNEL
	3	TUBE-1	3/4" X 3/4" X 20" 16 GA. TUBING
	1	TOP TUBE	1" X 1" X 20" 16 GA. TUBING
	1	7869 TAB	3/4" X 3/4" 12 GA. CRS
	4	16363-2	1" X 3" X 12 GA. CRS
	1	BACK PANEL	14" X 20 1/4" 16 GA. CRS
	2	7869 SIDE FRAME	SIDE PANEL WITH GRIDS ASSEMBLY
	1	WIRE FRAME	WIRE GRID
	1	WIRE FRAME	3/16" DIA. X 153 5/16" LONG
	2	WIRE-1	3/16" DIA. X 67 23/32" LONG
	7	WIRE-2	3/16" DIA. X 10" LONG
	1	TUBE-2	1" DIA. X 68 11/16" 16 GA. TUBE
	1	TUBE-3	1" DIA X 78 7/8" APPROX. 16 GA. TUBE
	1	HDPE PEBBLE 1/2	FRONT BUMPER 1/2" X 1 1/8" X 25" (1/4" RADIUS ON OUTSIDE EDGES)
	2	HDPE PEBBLE 1/2	END BUMPER 1/2" X 1 1/8" X 12 1/2" (1/4" RADIUS ON OUTSIDE EDGES)
	1	PEG BOARD	1/4" X 20" X 54 7/16" PEG BOARD
	1	ZN100	NAME PLATE 1 1/2" X 2 1/2" .020 BRASS OVAL W/2 HOLES
	6	ZB030	SCREW 10-16X1" PAN PHIL TEK
2	5	7869 SHELF	NON-ANGLED SHELF ASSEMBLY
	1	SHELF	22 1/8"X12 5/8" 18 GA. CRS
	1	5134 GRO BRKT RS 11"	NON-ANGLED SHELF RIGHT (DWG# 5134)
	1	5133 GRO BRKT LS 11"	NON-ANGLED SHELF LEFT (DWG# 5133)



DWG#	7869	REV.	L
------	------	------	---

ITEM(S)	GRO-011 WM
---------	------------

DWG TYPE:	PRODUCTION
-----------	------------

TITLE:	FREE STANDING SADDLE BAG FOR GOURMET SNACKS-ONE SIDE ONLY 25" X 12" X 78" (H)
--------	--

MATERIAL:	METAL/ WOOD
-----------	-------------

FINISH:	SEE ORDER
---------	-----------

DRAWN BY:	TN	DATE	4/19/2006
-----------	----	------	-----------

CHECKED BY:	SC	DATE	4/19/2006
-------------	----	------	-----------

APPROVED BY:		DATE	
--------------	--	------	--

APPROVED BY:		DATE	
--------------	--	------	--

RELEASE FOR PRODUCTION	DATE		
------------------------	------	--	--

USED ON:			
----------	--	--	--

SCALE: 1:13	SHEET # 1 OF 13
-------------	-----------------

SIZE: B	TITLE BLOCK: TB-2008
---------	----------------------

UNLESS OTHERWISE SPECIFIED DIMENSIONS ARE IN INCHES AND TOLERANCES ARE:		
FRACTIONS ±1/16"	DECIMALS .X ±.060 .XX ±.030 .XXX ±.015	ANGLES ±1°

THIS DOCUMENT CONTAINS INFORMATION PROPRIETARY AND CONFIDENTIAL TO THE MARCO COMPANY AND MAY NOT BE REPRODUCED, PUBLISHED, OR DISTRIBUTED IN ANY FORM OR DISCLOSED IN WHOLE OR IN PART WITHOUT THE AUTHORIZATION OF THE MARCO COMPANY. ALL RIGHTS RESERVED, COPYRIGHT 2007 THE MARCO COMPANY.		
--	--	--

DO NOT SCALE DRAWING

L	JS		ADDED THE ZC255 HARDWARE KIT NOTE.	PATRICK D.	11/11/15
K	TN	SC	BRING DOWN THE BACK PLATE 1/2" FROM 12 13/16" TO 12 5/16"		12-7-09
J	SC	TN	ADD LOCKING DEVICE FROM DRAWING # 16363	GARY D.	10-30-09
I	HH	SC	REPLACE SCREWS WITH FLAT RIVET HEAD ON THE BACK OF THE UNIT FOR EASY LOCK IN THE KEY HOLES	KATRINA L.	9-4-09
H	TN	SC	MOVE GOALPOST TO TOP OF UNIT; CHANGE GLIDES TO BE ZM638 INSTEAD ZM004.	KATRINA L.	11-25-08
G	TN	SC	CHANGE GAUGE OF SHELF FROM 16 GAUGE TO 18 GAUGE; CHANGE ALL WIRE FROM 1/4" DIA. TO 3/16" DIA.	KATRINA L.	8-11-08
F	JS	SC	RELOCATED MARCO LABEL TO THE BACK OF THE UNIT		1/24/08
REV.	BY	CHECKED	DESCRIPTION	APPROVED	DATE
REVISIONS					

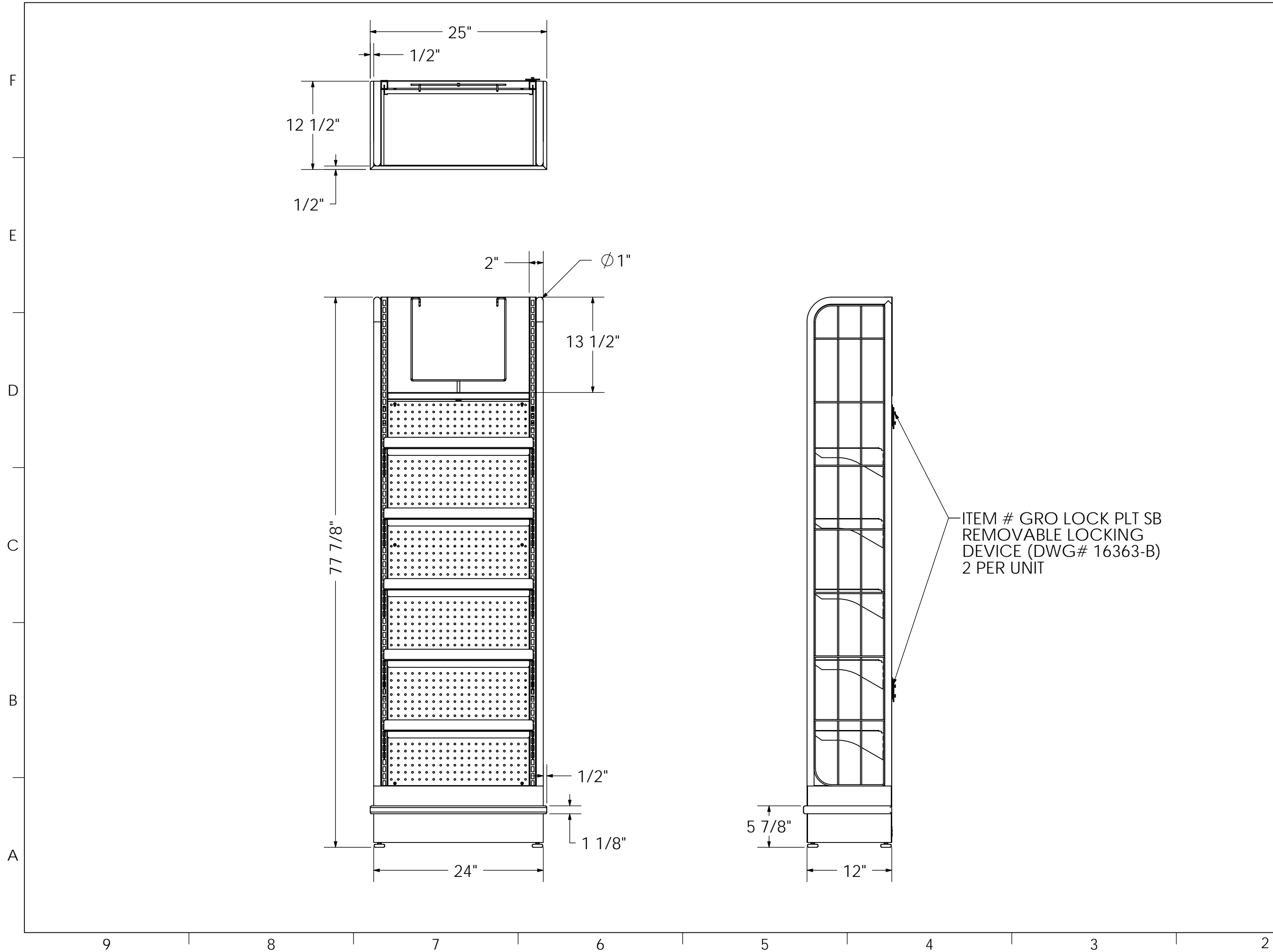

 3209 Marquita Drive Fort Worth, Texas 76116 PH: (817) 244-8300					
DWG# 7869		REV. L			
ITEM(S) GRO-011 WM					
DWG TYPE: PRODUCTION					
TITLE: FREE STANDING SADDLE BAG FOR GOURMET SNACKS-ONE SIDE ONLY 25" X 12" X 78" (H)					
MATERIAL: METAL/ WOOD					
FINISH: SEE ORDER					
DRAWN BY: TN		DATE 4/19/2006			
CHECKED BY: SC		DATE 4/19/2006			
APPROVED BY:		DATE			
APPROVED BY:		DATE			
RELEASE FOR PRODUCTION		DATE			
USED ON:					
SCALE: 1:13		SHEET # 2 OF 13			
SIZE: B		TITLE BLOCK: TB-2008			
DRAWN ON: SOLIDWORKS 2006					
UNLESS OTHERWISE SPECIFIED DIMENSIONS ARE IN INCHES AND TOLERANCES ARE: <table><tr><td>FRACTIONS ±1/16"</td><td>DECIMALS .X ±.060 .XX ±.030 .XXX ±.015</td><td>ANGLES ±1°</td></tr></table>			FRACTIONS ±1/16"	DECIMALS .X ±.060 .XX ±.030 .XXX ±.015	ANGLES ±1°
FRACTIONS ±1/16"	DECIMALS .X ±.060 .XX ±.030 .XXX ±.015	ANGLES ±1°			
THIS DOCUMENT CONTAINS INFORMATION PROPRIETARY AND CONFIDENTIAL TO THE MARCO COMPANY AND MAY NOT BE REPRODUCED, PUBLISHED, OR DISTRIBUTED IN ANY FORM OR DISCLOSED IN WHOLE OR IN PART WITHOUT THE AUTHORIZATION OF THE MARCO COMPANY. ALL RIGHTS RESERVED, COPYRIGHT 2007 THE MARCO COMPANY.					
DO NOT SCALE DRAWING					