



Project _____

Item 829GMC49W Quantity _____

Approval _____ Date _____

MainStreet Equipment GMC-49 52 3/4" White Swing Glass Door Merchandiser Refrigerator - 120V

Item #829GMC49W

Special Features

- Features 2 double-paned, glazed glass doors with an aluminum frame
- Interior LED lighting illuminates products
- 41.8 cu. ft. capacity with 10 shelves
- Easy-to-use digital temperature controls
- Includes casters with leveling feet for easy mobility

Technical Data

Width	52 3/4 Inches
Depth	31 1/2 Inches
Height	78 3/4 Inches
Power Cord Length	9 7/8 Feet
Interior Width	48 7/8 Inches
Interior Depth	25 Inches
Interior Height	59 7/16 Inches
Amps	7.3 Amps
Hertz	60 Hz
Phase	1 Phase



Certifications



5-15P



UL Certified

Technical Data

Voltage	120 Volts
Access Type	Doors
Capacity	41.8 cu. ft.
Casters	With Casters
Color	White
Compressor Location	Bottom Mounted
Door Style	Swing
Door Type	Glass
Exterior Material	Coated Steel
Features	Lighted Interior
Hinge Location	Left Right
Horsepower	1/2 hp
Installation Type	Freestanding
Interior Color	White
Interior Material	Coated Steel
Number of Doors	2 Doors
Number of Shelves	10 Shelves
Plug Type	NEMA 5-15P
Refrigerant Type	R-290
Sections	2 Sections
Temperature Range	32 - 40 Degrees F
Type	Merchandising Refrigeration

Technical Drawing

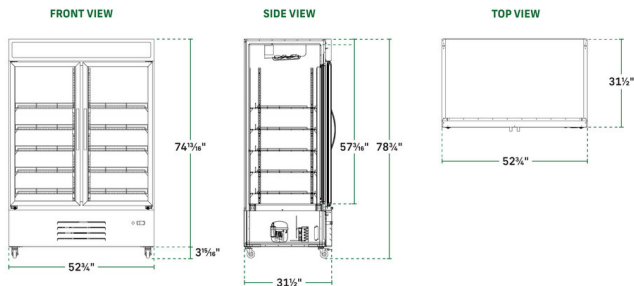

⚠ WARNING: This product can expose you to chemicals including lead, which are known to the State of California to cause cancer and birth defects or other reproductive harm. For more information, go to www.p65warnings.ca.gov.