

#164PBNAR48BK

Approval: \_\_\_\_\_ Date: \_\_\_\_\_



- Portable unit is ideal for outdoor events, weddings, catering, and hotels
- Lockable foldaway design with a removable tabletop for easy storage
- Made with a stylish, durable black laminate material
- Dual surfaces to prepare and serve drinks
- Spacious undershelf storage for coolers and drink supplies

Width	48 Inches
Depth	19 Inches
Height	42 1/2 Inches
Shelf Length	47 Inches
Shelf Width	17 1/2 Inches
Casters	Without Casters
Color	Black
Material	Laminate
Shape	Rectangle
Type	Bars

## Technical Data

### Features

Corner Guards  
Folding  
Locking Cabinet  
Portable

## Plan View

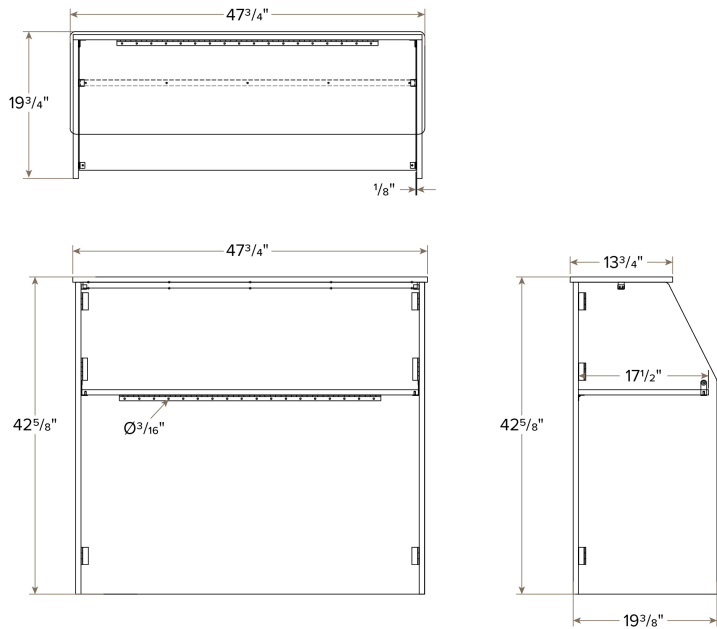

## Notes & Details

Be prepared to take your beverage service anywhere there's a party with this Lancaster Table and Seating foldaway bar with black laminate finish! This bar is built with a durable and stylish laminate material with a black finish that is perfect for mobile bartending in any setting. It's designed with a removable tabletop that allows for easy transportation and a foldable design that's great for storage between events! A built-in latch ensures this unit is easy to close and transport.

Your staff will love the dual surfaces for preparing and serving drinks that prevent patrons from taking their drinks before they're complete. The corners of the top of the bar are also equipped with edge protectors for added convenience. The spacious area underneath the shelf is perfect to store coolers and other drink supplies, too! This mobile bar's portable design is ideal for use at hotels, weddings, caterings, and outdoor events.

**⚠ WARNING:** This product can expose you to chemicals including lead, which are known to the State of California to cause cancer and birth defects or other reproductive harm. For more information, go to [www.p65warnings.ca.gov](http://www.p65warnings.ca.gov).