



# Jonti-Craft® 20 Section Mobile Backpack Cubbie - 3946JC

Item: 3946JC



This two-sided, mobile locker unit is ideal for backpack storage. Each side has 10 sections (20 in total). Each individual section is 11" wide x 13" deep x 21" high and contains a top-mounted, double coat hook. The 4" locking casters allow the mobile backpack cubbie to glide in and out of the classroom. KYDZSafe® edges. KYDZStrong® construction. KYDZTuff® finish. Heavy-duty, locking casters for mobility. GREENGUARD Gold certified. CARB II & CPSIA compliant.

60" W x 26.5" D x 48.5" H

Ship Weight: 203 lbs

Warranty: Lifetime

Fully Assembled

Made in United States

 KYDZ Safe.

 KYDZ Strong.

 KYDZ Tuff.





# JonTi-Craft® 20 Section Mobile Backpack Cubbie - 3946JC

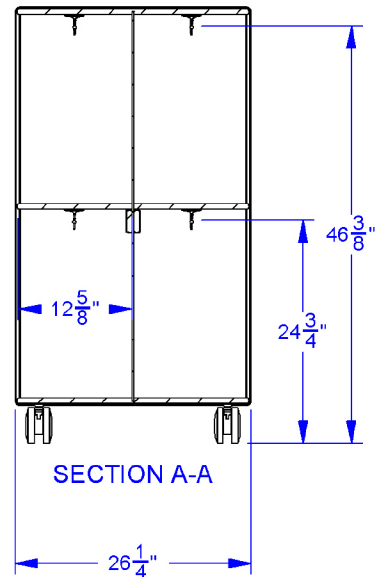
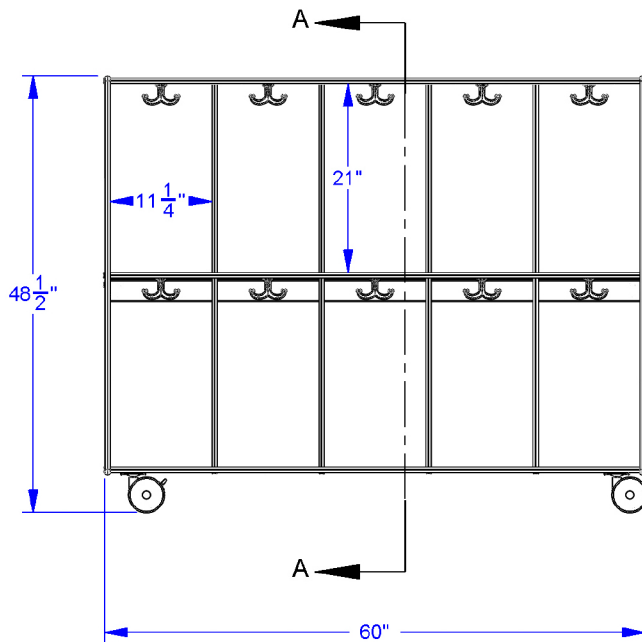

## JonTi-Craft Flagship Features Include:

KYDZSafe corners & edges are rounded to minimum of 1/2" radius. KYDZSafe kickplates prevent pinching & lost objects. KYDZSafe 15" depth adds increased stability & 25% more storage than competitor's 12" depth. KYDZStrong materials are guaranteed to last. KYDZStrong dowel-pin construction adds stability & strength. KYDZStrong Recessed backs give stability & structural integrity. KYDZTuff acrylic finish is ultra-long lasting and resists yellowing. The UV coating is environmentally friendly and easy to clean with an extra-strong resistance to daily wear and common cleaning products, like bleach and nail polish remover.