



# JonTi-Craft® Big Book Easel - Magnetic Write-n-Wipe - 0543JCMG



Item: 0543JCMG

24.5" W x 15" D x 30" H

Ship Weight: 58 lbs

Warranty: Lifetime

Fully Assembled

Made in United States



A Big Book language enrichment station on wheels! Easel folds down over storage space when not in use. Magnetic Write-n-Wipe front for adding to your story. Vertical big book partitions in back for storing a multitude of books. Overall approximately 43" high. KYDZSafe® edges. KYDZStrong® construction. KYDZTuff® finish. MAXBracket®.

**KYDZ Safe.**

**KYDZ Strong.**

**KYDZ Tuff.**

**MAX Bracket.**





# Jonti-Craft® Big Book Easel - Magnetic Write-n-Wipe - 0543JCMG

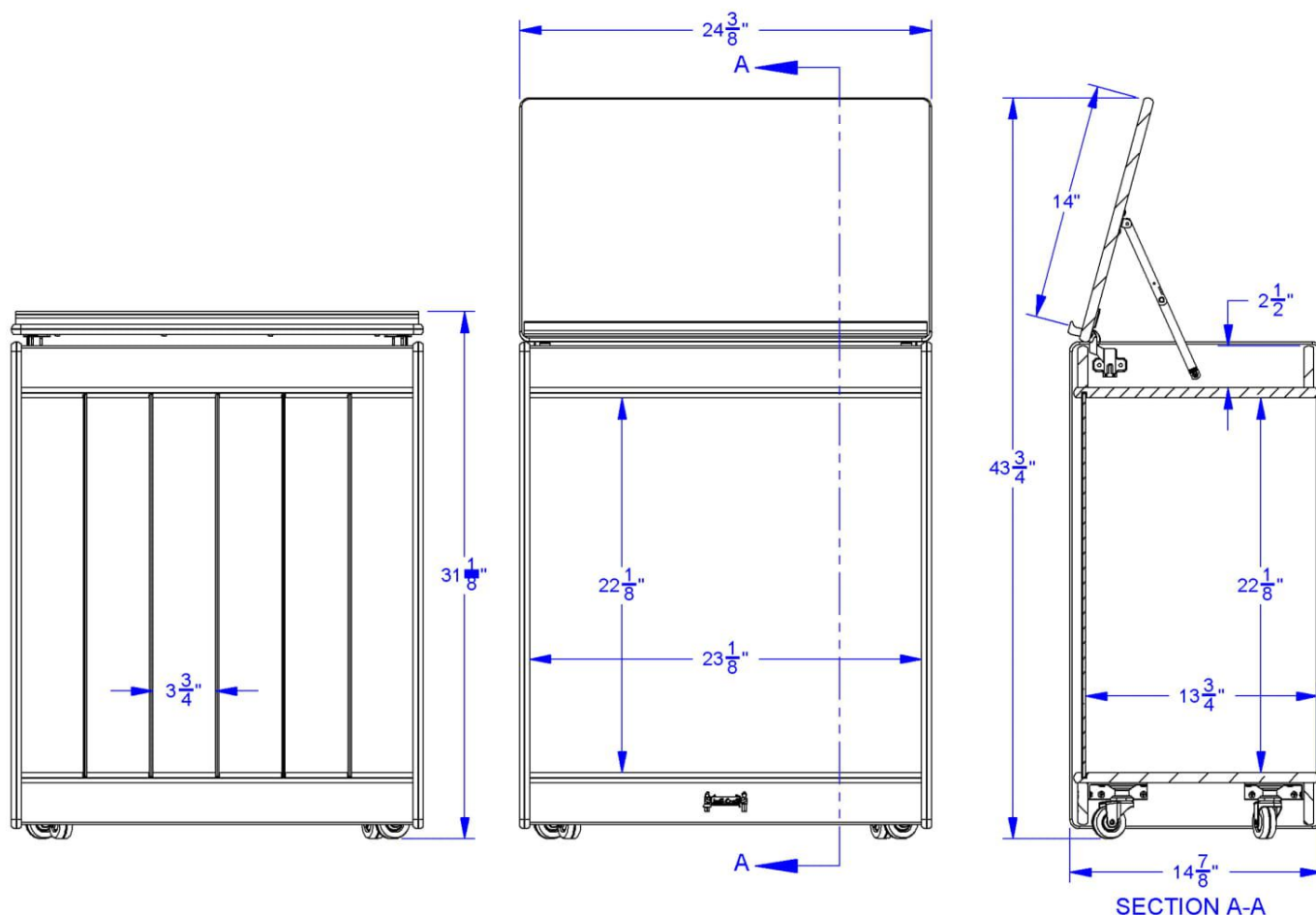

## Jonti-Craft Flagship Features Include:

KYDZSafe corners & edges are rounded to minimum of  $\frac{1}{2}"$  radius. KYDZSafe kickplates prevent pinching & lost objects. KYDZSafe 15" depth adds increased stability & 25% more storage than competitor's 12" depth. KYDZStrong materials are guaranteed to last. KYDZStrong dowel-pin construction adds stability & strength. KYDZStrong Recessed backs give stability & structural integrity. KYDZTuff acrylic finish is ultra-long lasting and resists yellowing. The UV coating is environmentally friendly and easy to clean with an extra-strong resistance to daily wear and common cleaning products, like bleach and nail polish remover. MAXBrackets are heavy-duty casters that make it easy to support and move furniture. Wheels are made of hard, non-marking rubber and a three-point-connection bracket adds triangular strength.