



Flav-R 2-Go® Locker System – Floor Mount

Models: F2G-24-A, -34-A
F2G-24-C, -34-C

The Hatco Flav-R 2-Go® Locker System - Floor Mount, designed specifically for your pick-up and third-party delivery needs, is capable of holding multiple orders of hot or ambient food with quick and secure access. By reducing congestion and allowing employees to focus on other functions, customers or delivery people can arrive, access their specific locker, and leave without waiting in line or disturbing the flow of other business.

Standard features

- Each locker unit has a large 10" (254 mm) touchscreen on the operator side and on the customer side. The operator puts in the name and code. The customer receives the code, enters it on the customer side, and the appropriate door unlocks and LED lights flash
- Available in two locker depth sizes; A models are 12" (305 mm) deep, while C models are 20.5" (521 mm) deep
- F2G-34 has customer facing controls on the left side of the unit. Operator controls will be on the right-hand side. Reverse control locations are available as an option.
- F2G-24 has customer facing controls in the center of the unit. Operator controls will be the same
- Each locker has a timer that will hold prepared and packaged food for up to 45 minutes
- Lockers come preset to 150°F (66°C) but can be adjusted up to 180°F (82°C) and individual lockers can have the heat turned off for ambient storage
- Internal lockers come standard in Gloss Smooth White with LED indicator lights that can be programmed to four different colors: blue (standard), red, green or magenta (all lockers will be one color)
- Available with pass-through or optional Back Panels create a one-sided access with the touchscreen only on the customer side
- Can be set up with four different claiming modes:
 - Name and Code: The system displays a list of names, customer selects their name and enters a code (up to 6 digits) to claim
 - Simple: The system displays a list of names. Customer selects their name and enters 1 to confirm
 - Name Only: The system prompts the customer to enter a name
 - Code Only: The system prompts the customer for pickup code (up to 6 digits)

• IFS anti-microbial coatings use naturally-occurring, environmentally sustainable, silver ions to help inhibit the growth of microbes on the powder coated surface. See www.hatcocorp.com/antimicrobial-paint for more information.

For operation, location and safety information, please refer to the Installation and Operating Manual.

Project _____
Item # _____
Quantity _____



F2G-34-A
shown from customers side, in
standard Designer Warm Red

Options (available at time of purchase only)

Designer Colors[®] –

Non-standard colors are non-returnable – Warm Red standard

- ☐ Black ☐ Gray Granite ☐ White Granite
☐ Navy Blue ☐ Hunter Green ☐ Antique Copper

- ☐ Right Side Control Panel on customer side (in lieu of left side control panel) – operator control panel would switch to left side (in lieu of right side control panel) – F2G-34 model only –
- ☐ Back panels – Creates a non-pass-through unit – (The power switch will move beside cord location) (subtract .58" [14 mm] to the depth) – Non-pass-through units have control panel only on customer side –
- ☐ Cord location: Side of unit, facing operator side, right side of unit, bottom corner closest to operator side – in lieu of standard: facing operator side, left side of unit, bottom corner closest to operator side –
- QR Code Reader –
- ☐ For non-pass-through units only. Must be combined with Back Panels
- ☐ For pass-through units only

Accessories

- ☐ Wall Mount Bracket (mounting hardware not included)
(Floor Mount Non Pass-Through models only)

NOTE: This unit is intended for stationary indoor, commercial use only—NOT for mobile applications.



HATCO CORPORATION | P.O. Box 340500 Milwaukee, WI 53234-0500 U.S.A. | (414) 671-6350



www.hatcocorp.com | support@hatcocorp.com | [Find a Hatco Rep](#) | [Image Library](#) | [Document Library](#) | [Patents](#) | [Chat](#)



Flav-R 2-Go® Locker System - Floor Mount

Models: F2G-24-A, -34-A F2G-24-C, -34-C

F2G-24

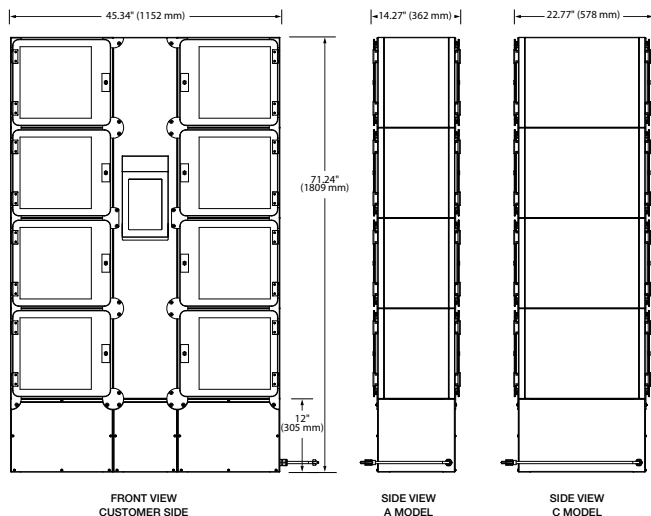

F2G-34

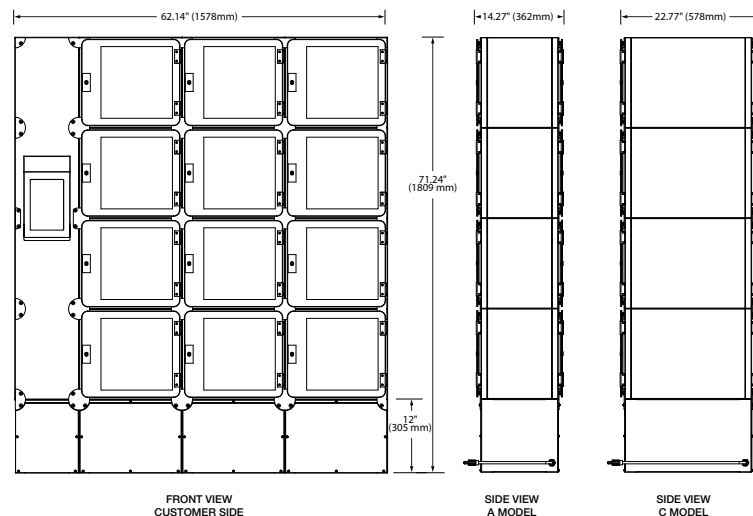

SPECIFICATIONS

Flav-R 2-Go® Locker Systems - Floor Mount

Model	Model Dimensions (W x D x H)	Number of Lockers	Internal Locker Dimensions	Volts	Watts	Amps	Approx. Ship Weight	Plug
F2G-24-A	45.34" x 14.27" x 71.24" (1152 x 362 x 1809 mm)	8 lockers	12" x 12" x 12" (305 x 305 x 305 mm)	120	831	7.3	542 lbs.	NEMA 5-15P
F2G-24-C	45.34" x 22.77" x 71.24" (1152 x 578 x 1809 mm)	8 lockers	12" x 20.5" x 12" (305 x 521 x 305 mm)	120	1087	9.4	628 lbs.	NEMA 5-15P
F2G-34-A	62.14" x 14.27" x 71.24" (1578 x 362 x 1809 mm)	12 lockers	12" x 12" x 12" (305 x 305 x 305 mm)	120	1239	10.8	735 lbs.	NEMA 5-15P
F2G-34-C	62.14" x 22.77" x 71.24" (1578 x 578 x 1809 mm)	12 lockers	12" x 20.5" x 12" (305 x 521 x 305 mm)	120	1623	14.0	838 lbs.	NEMA 5-15P*

*Canadian models use NEMA 5-20P.

CORD LOCATION

Facing operator side, left side of unit, bottom corner closest to operator side.

PLUG CONFIGURATIONS

NEMA 5-15P



NEMA 5-20P



PRODUCT SPECS

Flav-R 2-Go® Locker System

The Locker System shall be a Flav-R 2-Go® Model ... , rated at ... volts, and ... watts, by the Hatco Corporation, Milwaukee, WI 53234 U.S.A.

The lockers shall consist of magnetically locked hinged doors, heated base, a 10"

(254 mm) touchscreen controller on one or both sides of the unit, a Power on/off switch, LED lighting and a 6' (1829 mm) cord with plug attached.

Warranty consists of 24/7 parts and service assistance (U.S. and Canada only).

HATCO CORPORATION

P.O. Box 340500 Milwaukee, WI 53234-0500 U.S.A. | (414) 671-6350



www.hatcocorp.com

support@hatcocorp.com

[Find a Hatco Rep](#)

[Image Library](#)

[Document Library](#)

[Patents](#)

[Chat](#)