

## Galaxy CRG-3 Black Customizable Countertop Display Refrigerated Merchandiser - 2.5 cu ft.

Item #177CRG3B

### Special Features

- Bright LED interior lighting illuminates merchandise
- Adjustable shelves offer multiple layers of merchandising space
- Locking door for added security of merchandise
- Small, compact countertop design perfect for maximizing available merchandising space
- 115V; 1/10 hp; R-600a refrigerant

### Technical Data

Width	17 1/8 Inches
Depth	19 11/16 Inches
Height	27 5/16 Inches
Power Cord Length	66 3/4 Inches
Interior Width	13 3/8 Inches
Interior Depth	12 9/16 Inches
Interior Height	22 7/16 Inches
Amps	1.1 Amps
Hertz	60 Hz
Phase	1 Phase



### Certifications



5-15P



ETL, US & Canada



Customizable

Technical Data

Voltage	115 Volts
Access Type	Doors
Capacity	2.5 cu. ft.
Capacity (per Shelf)	33 lb.
Color	Black
Compressor Location	Rear Mounted
Display Case Type	Refrigerated
Door Style	Swing
Door Type	Glass
Features	Customizable LED Lighting
Hinge Location	Right
Horsepower	1/10 hp
Installation Type	Countertop
Number of Doors	1 Doors
Number of Shelves	3 Shelves
Plug Type	NEMA 5-15P
Refrigerant Type	R-600a
Temperature Range	33 - 40 Degrees F
Type	Countertop Refrigerators

Technical Drawing

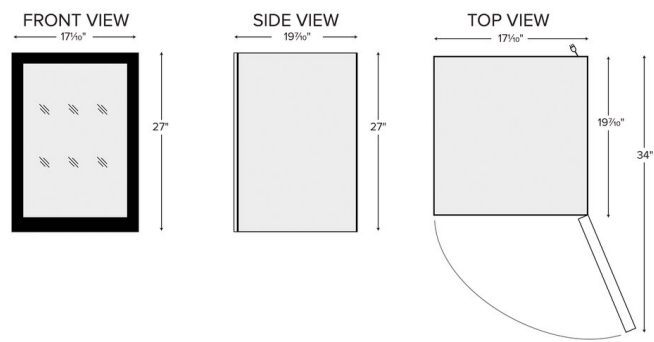

**⚠ WARNING:** This product can expose you to chemicals including lead, which are known to the State of California to cause cancer and birth defects or other reproductive harm. For more information, go to [www.p65warnings.ca.gov](http://www.p65warnings.ca.gov).