

# BASE MODEL FREEZER (0°F)

**Model:** FA60NBS

## 60" Worktop Freezer with Solid Doors and 6" Backsplash

Heavy gauge #300 Series stainless steel top, stainless steel front and end panels, galvanized steel rear and grill and aluminum interior.

**Designed to maintain NSF-7 temperatures in 100°F ambient.**



## Options and Accessories

(upcharge and lead times may apply)

|   |                                     |
|---|-------------------------------------|
| Stainless steel interior                                  | Different size casters              |
| Stainless steel back                                      | Adjustable legs                     |
| Additional epoxy coated steel shelves                     | Door locks                          |
| Stainless steel shelves                                   | Front breathing                     |
| Overshelves (single or double)                            | Compressor left (standard on right) |
| Pan slides (large section only)                           | Drawers in lieu of doors**          |
| Drawer in lieu of door section above the condensing unit* |                                     |

\*Drawer above condensing unit holds (1) 12 x 20 x 6 pan

\*\*Narrow Drawer holds (1) 12 x 20 x 6 pan per drawer

\*\*Large drawer holds (2) 12 x 20 x 6 pans per drawer

Consult factory for other model configurations, options and accessories.

**Continental**  
Refrigerator



**Project Name:**

**Model Specified:**

**Location:**

**Item No:**

**Quantity:**

**AIA #:**

**SIS #:**

## Standard Model Features

### REFRIGERATION SYSTEM

Performance rated refrigeration system

Environmentally safe R-290 refrigerant

Unique forced air design utilizes fans (approx. every 12") across the entire back of unit for even distribution of cold

Automatic, energy saving, non-electric condensate evaporator

Non-corrosive, plasticized fin evaporator coil

Expansion valve system

Easily serviceable, slide out condensing unit

### CABINET ARCHITECTURE

2" non-CFC polyurethane foam insulation

Spring loaded, self closing doors

Magnetic snap in Santoprene™ door gaskets

Heavy duty, epoxy coated steel shelves

Smooth, polished chrome door handles

5" casters

Completely enclosed, vented and removable rear and side grills

### MODEL FEATURES

Electronic control, automatic electric defrost

Refrigerated section with door above the condensing unit

Field rehingeable doors

<sup>1</sup> R-290 refrigerant meets all federal and state regulatory requirements.

**NOTE:** Models come standard with a door over the condensing unit. A drawer over the condensing unit is an option.

**APPROVAL:**

## Model Specifications

### DIMENSIONAL DATA

|  |                  |
|--|------------------|
| Net Capacity (cubic feet)                                | 19 (538 cu l)    |
| Width, Overall (inches)                                  | 60 (1524 mm)     |
| Depth, Overall (inches)<br>(including handles & bumpers) | 36 5/16 (922 mm) |
| Height, Overall (inches)<br>(including 5" casters)       | 40 1/2 (1029 mm) |
| Shelf Area (square feet)                                 | 7.1 (0.7 sq m)   |
| Number of Shelves  | 4                |
| Number of Full Doors                                     | 2                |
| Number of Half Doors                                     | 1                |
| Interior Depth (inches)                                  | 30 (762 mm)      |
| Interior Height (inches)                                 | 26 (660 mm)      |
| Interior Height (inches)<br>(above condenser)            | 12 1/2 (318 mm)  |
| Interior Width (inches)                                  | 56 (1422 mm)     |

### REFRIGERANT DATA

|                             |      |
|-----------------------------|------|
| Condensing Unit Size (H.P.) | 1/2  |
| Capacity (BTU per hour)*    | 2180 |

### ELECTRICAL DATA

|  |                     |
|--|---------------------|
| Voltage (International)                        | 115/60/1 (220/50/1) |
| Total Amps (International)                     | 7.0 (4.2)           |
| Defrost Amps (International)                   | 9.1 (4.8)           |
| 10 ft. Cord/Plug [attached]<br>(International) | Yes<br>(No)         |

### SHIPPING DATA

|                          |                  |
|--------------------------|------------------|
| Weight (pounds)          | 380 (173 kg)     |
| Height - Crated (inches) | 43 3/4 (1111 mm) |
| Width - Crated (inches)  | 62 (1575 mm)     |
| Depth - Crated (inches)  | 47 (1194 mm)     |

\* Rating @ -15°F evaporator, 90°F ambient  
Figures in parentheses reflect metric equivalents rounded to the nearest whole unit.



Equipped with one NEMA-5-15P Plug  
(varies by country)

## Model Plan Views

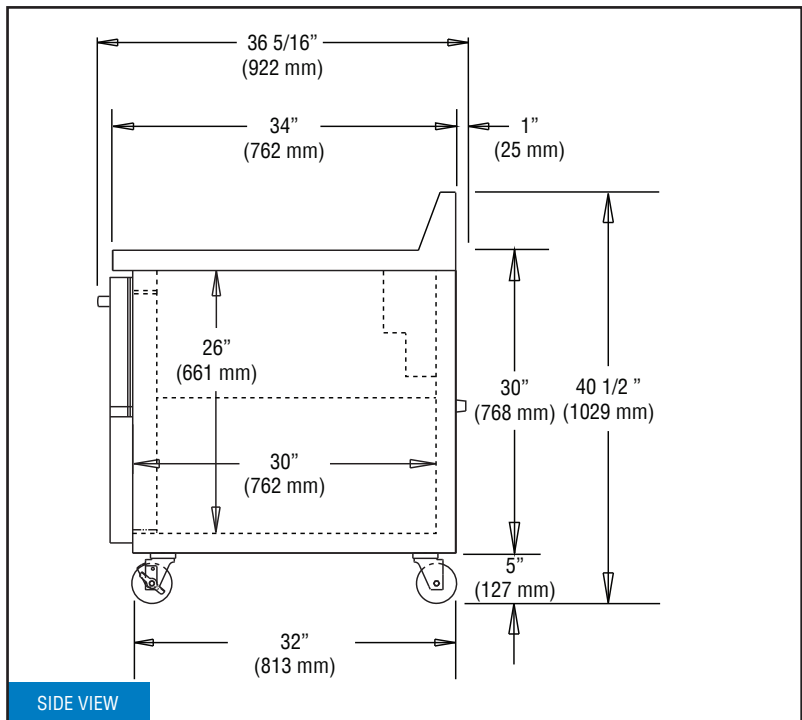
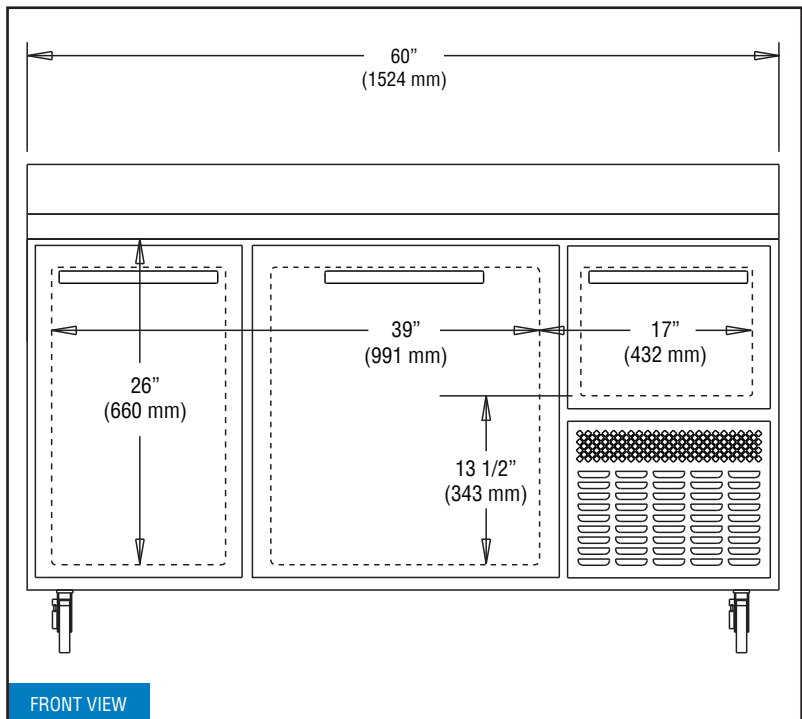

**Continental**  
Refrigerator

Toll-Free: 800-523-7138  
Phone: 215-244-1400  
Fax: 215-244-9579

539 Dunksferry Road  
Bensalem, PA 19020  
[www.continentalrefrigerator.com](http://www.continentalrefrigerator.com)

Due to our continued efforts in developing  
innovative products, specifications subject  
to change without notice.



PROUDLY  
DESIGNED & ASSEMBLED  
IN THE U.S.A.

Intertek

© Copyright 2024. Continental Refrigerator.  
A Division of National Refrigeration & Air Conditioning Products, Inc.

REVISED: 4/4/24