

Item #: 342WRC128DZ Project: \_\_\_\_\_

Qty: \_\_\_\_\_ Date: \_\_\_\_\_ Approval: \_\_\_\_\_

# AvaValley WRC-128-DZ Dual Temperature Full Glass Door Commercial Wine Cooler

Item #342WRC128DZ



## Technical Data

Width	23 1/2 Inches
Depth	26 3/4 Inches
Height	55 3/4 Inches
Power Cord Length	72 Inches
Interior Width	19 11/16 Inches
Interior Depth	21 3/16 Inches
Nominal Depth	Standard
Interior Height	48 Inches
Amps	2 Amps
Hertz	60 Hz

## Features

- Dual temperature zones allow for versatile usage
- Comes with 11 removable wooden shelves that hold up to 121 bottles
- Blue LED lighting provides a clear view of contents while giving off a high-end feel
- Included door lock ensures security
- Stainless steel door frame and handle for added durability

## Certifications



5-15P



ETL, US



Field-Reversible Doors

## Technical Data

Phase	1 Phase
Voltage	115 Volts
Access Type	Doors
Capacity	11.3 cu. ft. 121 Bottles
Color	Black
Door Style	Swing
Door Type	Glass
Exterior Finish	Black
Features	Dual Temperature Field-Reversible Doors LED Lighting
Installation Type	Freestanding
Number of Doors	1 Doors
Number of Shelves	11 Shelves
Plug Type	NEMA 5-15P
Refrigerant Type	R-600a
Sections	1 Section
Temperature Range	41 - 72 Degrees F
Temperature Zones	Dual
Type	Wine Refrigerator

## Plan View

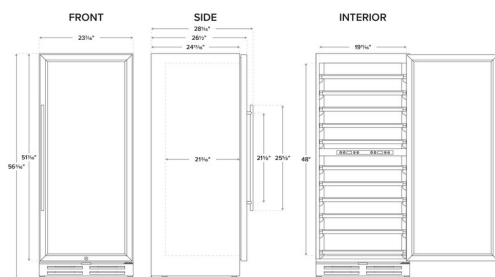

## Notes & Details

Safely store wine while having it perfectly chilled and ready to serve with this AvaValley WRC-128-DZ single-section, dual-temperature full glass door wine refrigerator. Its wide-ranging temperature capability makes this wine refrigerator a versatile addition. With a temperature range from 41-72 degrees Fahrenheit, it's simple to store either white or red wine in the refrigerator for added convenience.

The versatile dual temperature design allows you to maintain different temperatures in the upper (41-54 degrees Fahrenheit) and lower (54-72 degrees Fahrenheit) zones simultaneously, so that you can create optimal drinking temperatures for a range of wines all in the same, single-section unit. Multi-function digital temperature controls help manage the thermostatic cabinet. Best of all, it also includes a blue LED display light that adds aesthetic appeal and helps you identify the contents without emitting heat like a traditional bulb. This ensures that the refrigerator stays at its intended temperature.

Plus, the 11 wooden shelves can easily hold up to 121 bottles of various wines! Its full length glass door, which features a stainless steel frame, allows contents to be viewable and provides a more aesthetic presentation. The door has a lock to ensure contents remain secure during after-hours. Plus, the door frame and handle are made from stainless steel to guarantee durability in commercial environments while remaining easy to clean. This unit requires a 115V, 1 phase electrical connection.

**⚠ WARNING:** This product can expose you to chemicals including lead, which are known to the State of California to cause cancer and birth defects or other reproductive harm. For more information, go to [www.p65warnings.ca.gov](http://www.p65warnings.ca.gov).