

Avantco BCTD-60 60" Black 3-Shelf Curved Glass Dry Bakery Display Case with LED Lighting

Item #193BCTD60B



Technical Data

Width	60 11/16 Inches
Depth	27 1/16 Inches
Height	55 7/8 Inches
Power Cord Length	70 7/8 Inches
Interior Width	56 7/8 Inches
Interior Depth	22 3/8 Inches
Interior Height	32 3/4 Inches
Amps	0.4 Amps
Phase	1 Phase
Voltage	115 Volts

Features

- 3 adjustable glass shelves allow for an organized display; base may be used as a 4th shelf
- Double paned glass panels on 3 sides with sliding glass rear doors
- Bright, cool LED lighting effectively highlights baked goods
- Includes a set of casters to make it easy to move for cleaning and service
- 115V

Certifications



5-15P



ETL Sanitation

Technical Data

Access Type	Doors
Capacity	13.5 cu. ft.
Color	Black
Display Case Type	Dry / Unrefrigerated
Door Style	Sliding
Door Type	Glass
Features	LED Lighting Lighted Interior
Glass Style	Curved
Installation Type	Freestanding
Number of Shelves	3 Shelves

Plan View

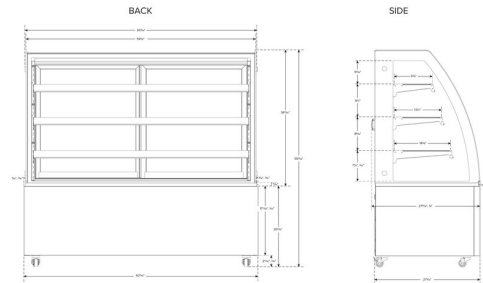

Notes & Details

Showcase everything from cakes and pies to eclairs and flan in this Avantco BCTD-60 60" black 3-shelf curved glass dry bakery display case! Perfect for bakeries, cafes, coffee shops, and diners, the unit includes 3 glass shelves with price tag holders to help display and organize product. In addition to the glass shelves, the base of the unit can be used as a fourth shelf or display area for extra capacity.

Designed with double paned glass panels on 3 sides and sliding glass rear doors, the case provides maximum product visibility, tempting customers by showing off your decadent desserts from every angle. The sleek frame ensures that the beautiful case fits seamlessly into your business while the curved front offers a clean presentation. Plus, LED lighting is built into each shelf, illuminating product for a bright, enticing display.

As a dry case, this unit doesn't come with a refrigeration system. It is perfect for non-refrigerated baked goods like breads, muffins, pastries, cookies, pies, and more! This unit includes a set of casters to make it easy to move for cleaning and service. A 115V electrical connection is required for operation.

⚠ WARNING: This product can expose you to chemicals including lead, which are known to the State of California to cause cancer and birth defects or other reproductive harm. For more information, go to www.p65warnings.ca.gov.