

Item #: 193BCD48B Project: \_\_\_\_\_

Qty: \_\_\_\_\_ Date: \_\_\_\_\_ Approval: \_\_\_\_\_

# Avantco BCD-48 48" Curved Glass Black Dry Bakery Display Case

Item #193BCD48B



## Technical Data

Width	47 7/8 Inches
Depth	26 1/2 Inches
Height	48 Inches
Power Cord Length	69 Inches
Interior Width	45 5/8 Inches
Interior Depth	22 9/16 Inches
Interior Height	25 3/16 Inches
Phase	1 Phase
Voltage	115 Volts
Capacity	18.7 cu. ft.

## Features

- Unrefrigerated design with bright, cool LED lighting for displaying un-chilled bakery items
- Features a curved double pane glass design for maximum product visibility
- Adjustable glass shelves with 44 lb. weight capacity; includes price tag holders
- Sliding glass doors for easy access without blocking walking areas
- Easy-to-use digital controls; 115V

## Certifications

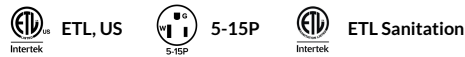

## Technical Data

Color	Black
Display Case Type	Dry / Unrefrigerated
Door Type	Glass
Features	LED Lighting Lighted Interior
Glass Style	Curved
Installation Type	Freestanding
Number of Shelves	2 Shelves
Plug Type	NEMA 5-15P
Service Type	Full Service

## Plan View

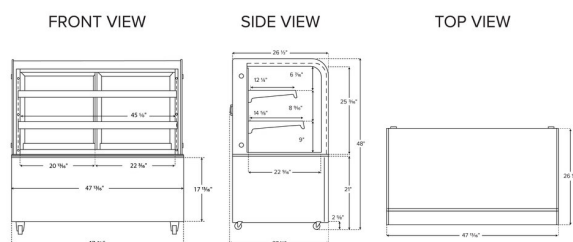

## Notes & Details

Showcase everything from cakes and pies to cookies and muffins in this Avantco BCD-48 48" curved glass black dry bakery display case! Perfect for bakeries, cafes, coffee shops, and diners, the unit includes 2 glass shelves to help display and organize product. Each shelf holds up to 44 lb. of weight.

Designed with double glass panels on 4 sides, the case provides maximum product visibility, tempting customers with sweet doughnuts, savory bagels, gluten-free muffins, and other baked goods. The rest of the exterior is black, so you can be sure that it draws attention to the treats on display. Plus, LED lighting is built-in, illuminating product for a bright, enticing display.

This unit includes a set of 2" casters to make it easy to move for cleaning and service. A 115V electrical connection is required for operation.

**⚠ WARNING:** This product can expose you to chemicals including lead, which are known to the State of California to cause cancer and birth defects or other reproductive harm. For more information, go to [www.p65warnings.ca.gov](http://www.p65warnings.ca.gov).