

Item #: 178UBB36GHCS Project: \_\_\_\_\_

Qty: \_\_\_\_\_ Date: \_\_\_\_\_ Approval: \_\_\_\_\_

# Avantco UBB-36G-HC-S 36" Stainless Steel Counter Height Glass Door Back Bar Refrigerator with LED Lighting

Item #178UBB36GHCS



## Technical Data

Width	36 13/16 Inches
Depth	24 3/8 Inches
Height	36 1/4 Inches
Power Cord Length	96 Inches
Interior Width	24 1/4 Inches
Left Door Opening Width	24 1/16 Inches
Packaging Width	39 1/8 Inches
Shelf Width	23 3/5 Inches
Depth with Door Open	49 Inches
Interior Depth	18 1/2 Inches

## Features

- Thick stainless steel countertop with stainless steel interior and exterior
- LED interior lighting
- Preprogrammed digital temperature controls with auto-defrost function
- Two adjustable epoxy-coated steel shelves can be removed to fit one 1/2 keg
- 115V; 1/4 hp; R290 refrigerant

## Certifications



5-15P



ETL Sanitation



ETL, US

## Technical Data

Nominal Depth	Narrow
Packaging Depth	27 1/2 Inches
Shelf Depth	17 9/10 Inches
Interior Height	30 1/2 Inches
Packaging Height	41 3/4 Inches
Amps	3 Amps
Hertz	60 Hz
Phase	1 Phase
Voltage	115 Volts
Wattage	280 Watts
Access Type	Doors
Capacity	(1) 1/2 Kegs 7.8 cu. ft.
Capacity (per Shelf)	88 lb.
Compressor Location	Left Side Mounted
Compressor Style	Side / Rear Breathing
Countertop Type	Stainless Steel
Door Style	Swing
Door Type	Glass
Exterior Finish	Stainless Steel
Features	Automatic Electric Defrost Digital Temperature Controller LED Lighting Locking Doors Removable Magnetic Door Gaskets
Horsepower	1/4 hp
Insulation Material	Polyurethane Foam
Material	Stainless Steel
Maximum Ambient Temperature	90 Degrees F
Number of 12 oz. Bottles	126 Bottles
Number of 12 oz. Cans	96 Cans
Number of Doors	1 Doors
Number of Kegs	1 Keg
Number of Shelves	2 Shelves
Plug Type	NEMA 5-15P
Refrigerant Capacity	2.5 oz.
Refrigerant Type	R-290
Shelf Material	Epoxy-Coated Steel
Starting Amps	9 Amps
Starting Wattage	840 Watts
Style	1/2 Barrel
Temperature Range	33 - 40 Degrees F
Top Type	Counter Height

## Plan View

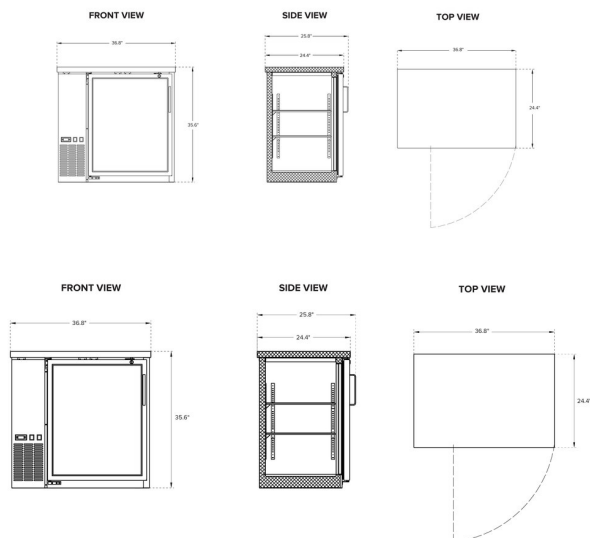

## Notes & Details

Optimize the space behind your bar by adding refrigerated storage with this Avantco UBB-36G-HC 36" stainless steel counter height glass door back bar refrigerator! Providing 7.8 cu. ft. of interior storage space, the unit houses (2) 23 11/16" x 17 15/16" shelves that each accommodate up to 88 lb. The epoxy-coated steel shelves are perfect for storing and organizing beverages for your bar service, from bottles of ale and beer to cans of crisp ciders. Plus, the shelves can be removed to fit (1) 1/2 keg.

The interior, made of strong 201 type stainless steel, is accessible through a clear glass door. Because it's made of glass, the door provides excellent product visibility, enabling you to easily view your current drink or ingredient selection for efficient drink preparation. In addition, this refrigerator has interior LED lighting to maximize product visibility. Even if your bar area is dimly lit, bartenders and servers will have no trouble finding the drinks and garnishes they need.

For overall durability, the unit's exterior is made and topped with a type 201 stainless steel surface. This unit features easy-to-use, preprogrammed digital temperature controls to make setting and changing the temperature simple. Plus, the auto-defrost function ensures your unit and inventory within remain at the correct temperatures. With a narrow design, the unit fits in spaces other units can't, helping you to maximize the space you have available.

This back bar refrigerator ensures optimal performance by operating with a 1/4 hp refrigeration system that circulates R290 hydrocarbon refrigerant to maintain temperatures from 33 to 40 degrees Fahrenheit. R290 refrigerant has an ozone depletion potential (ODP) of 0 and a global warming potential (GWP) of 3. The foamed-in-place polyurethane insulation helps to trap in the cold air and to prevent the ambient air from entering. This ensures that all food held in the unit remains at food safe temperatures and ready for preparation or direct service to customers! The unit requires a 115V electrical connection for operation and even comes with adjustable feet for simple, convenient leveling.

**⚠ WARNING:** This product can expose you to chemicals including lead, which are known to the State of California to cause cancer and birth defects or other reproductive harm. For more information, go to [www.p65warnings.ca.gov](http://www.p65warnings.ca.gov).