



Item No. \_\_\_\_\_

## DPPC-48-77-W

### Self-Service Pastry Wall Case

#### Key Features

- LED canopy and shelf lights
- Tray support shelving system
- Black wire racks
- Four levels of adjustable, lighted shelves – adjustable in 1" increments
- Black 1" PTM
- Two tempered glass front swinging doors with spring loaded self-closing hinges
- Package ledge includes two (2) tissue cubbies and a trash area (2) lower pull-out doors for storage
- Adjustable bag bin storage area
- 1" upper and 3" lower black bumper
- Mirror back, canopy and interior end panels
- Insect deterrent fan assembly
- 10' cord & plug

#### Options

- Color bumper options (McCue)
- Special exterior finishes\* (consult your Hussmann sales representative)

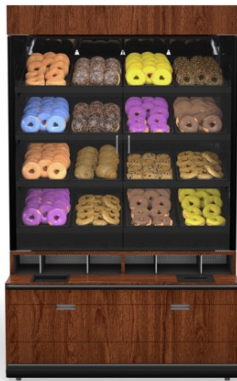

*Optional laminate finish shown*



AIA # \_\_\_\_\_

### Hussmann Corporation

12999 St. Charles Rock Rd.

Bridgeton, MO 63044-2483

Ph: 800.592.2060

www.hussmann.com

# DPPC-48-77-W

## Self Service Pastry Wall Case

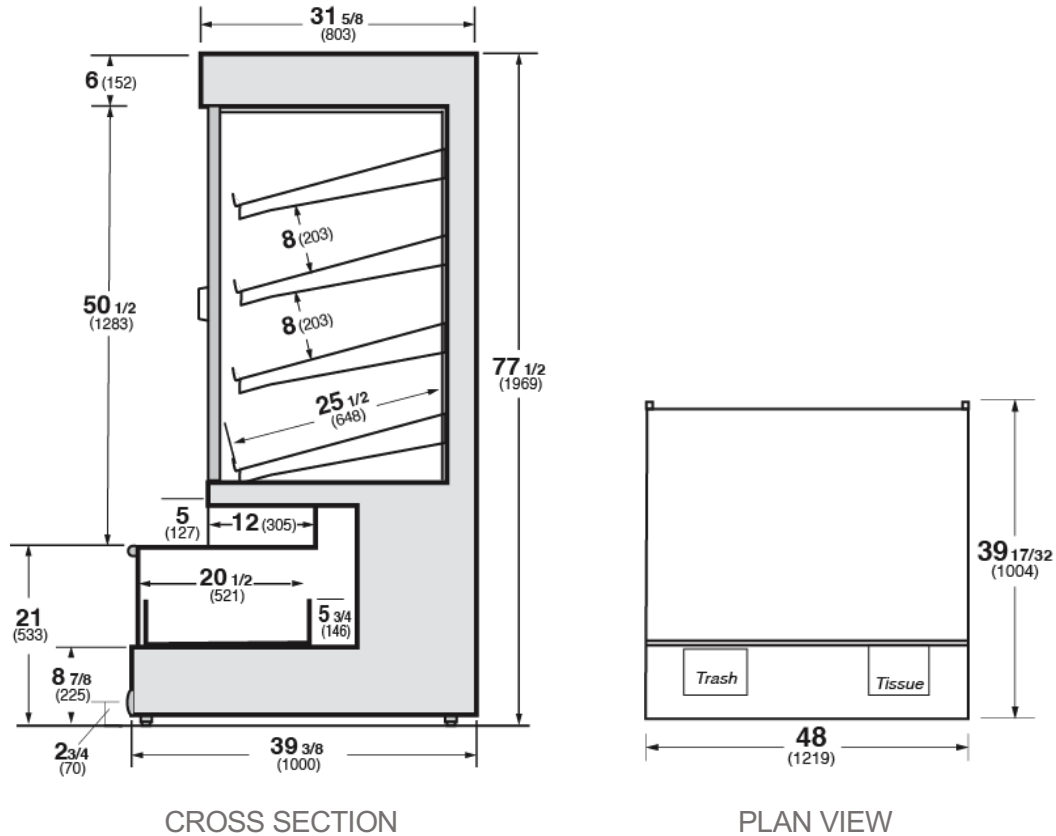

AIA #

Model	Shelves	L	D	H	Volts	Run Amps	Optional Fan
<b>DPPC-48-77-W</b>	4	48" (1219 mm)	39-3/8" (1000)	77-1/2" (1969)	120/60/1	1.31	+ 0.35 Amps

Notes:



[MORE INFO](#)

We reserve the right to change or revise specifications and product design in connection with any feature of our products. Such changes do not entitle the buyer to corresponding changes, improvements, additions, or replacements for equipment previously sold or shipped. For additional resources, contact your representative or visit [www.hussmann.com](http://www.hussmann.com).



12999 St. Charles Rock Rd.  
Bridgeton, MO 63044-2483  
Ph: 800.592.2060  
[www.hussmann.com](http://www.hussmann.com)