



T&S BRASS AND BRONZE WORKS, INC.

2 Saddleback Cove / P.O. Box 1088
Travelers Rest, SC 29690



REG. #A2601
ISO #9001

Model No.

B-0545-F SERIES

Item No.

Travelers Rest, SC: 800-476-4103 Simi Valley, CA: 800-423-0150 Fax: 864-834-3518 www.tsbrass.com

This Space for Architect/Engineer Approval

Job Name _____ Date _____

Model Specified _____ Quantity _____

Customer/Wholesaler _____

Contractor _____

Architect/Engineer _____

MODEL NO.	FLOW (GPM \pm 15%)
B-0545-F03	.25
B-0545-F05	.40
B-0545-F07	.70
B-0545-F10	.90
B-0545-F12	1.20
B-0545-F15	1.40
B-0545-F20	2.00

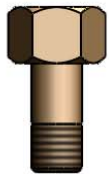

150A
Tailpiece & Nut
Furnished for
Optional 1/4" NPT
Connection

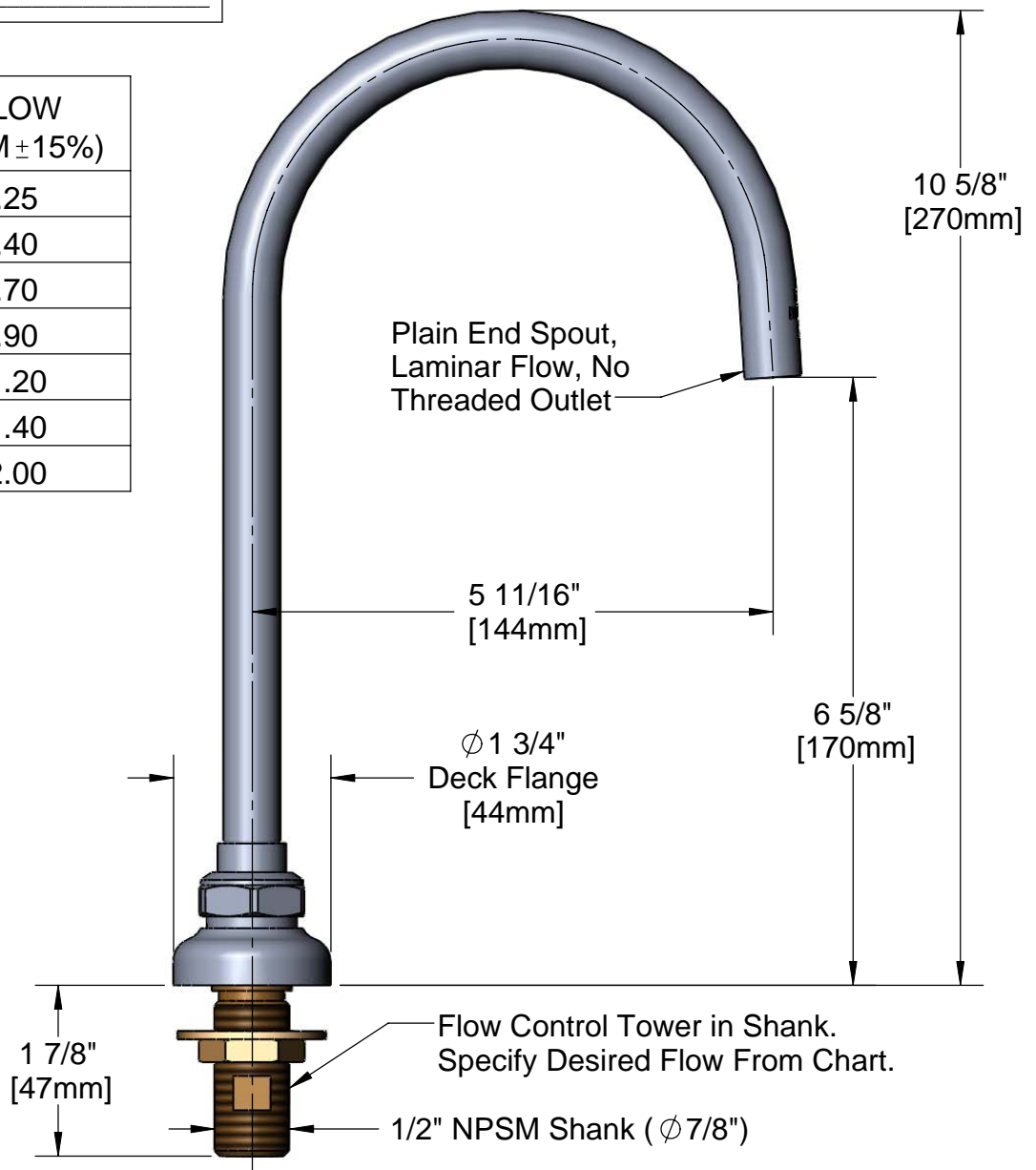

Product Specifications:

Deck Mount Dummy Swivel Gooseneck w/ Plain End
Outlet and Flow Control Option

Drawn

DMH

Checked

ARH

Approved

JHB

Scale:

1:2

Date:

03/31/09

Sheet: 1 of 1