

## 8" C/C BACKSPLASH FAUCET W/ LEVER HANDLES

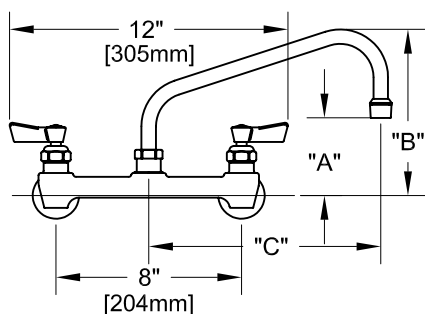

## 8" C/C BACKSPLASH FAUCET W/ WRIST HANDLES

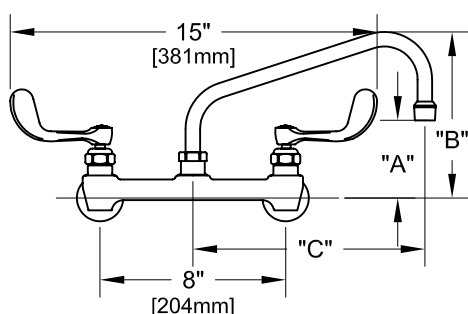

## 8" C/C BACKSPLASH FAUCET

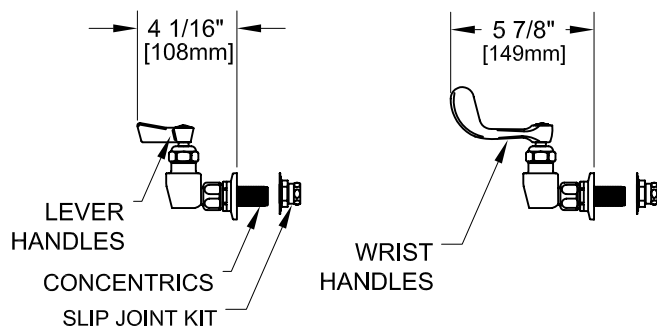

## ROUGH-IN:

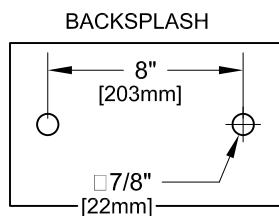

PRODUCT NAME: STAINLESS STEEL  
8" C/C BACKSPLASH FAUCET

## MODEL:

- ☐ 61220 W/ 6" SWING SPOUT W/ LEVER HANDLES
- ☐ 61093 W/ 8" SWING SPOUT W/ LEVER HANDLES
- ☐ 60968 W/ 10" SWING SPOUT W/ LEVER HANDLES
- ☐ 60836 W/ 12" SWING SPOUT W/ LEVER HANDLES
- ☐ 60690 W/ 14" SWING SPOUT W/ LEVER HANDLES
- ☐ 60569 W/ 16" SWING SPOUT W/ LEVER HANDLES
- ☐ 61239 W/ 6" SWING SPOUT W/ WRIST HANDLES
- ☐ 61107 W/ 8" SWING SPOUT W/ WRIST HANDLES
- ☐ 60976 W/ 10" SWING SPOUT W/ WRIST HANDLES
- ☐ 60844 W/ 12" SWING SPOUT W/ WRIST HANDLES
- ☐ 60704 W/ 14" SWING SPOUT W/ WRIST HANDLES
- ☐ 60577 W/ 16" SWING SPOUT W/ WRIST HANDLES

## FEATURES

## CONTROL VALVE

- \* 8" C/C BACKSPLASH MOUNT
- \* CONCENTRICS
- \* STAINLESS STEEL CONSTRUCTION
- \* SWIVELLING SEAT DISKS
- \* HOT SIDE STEM - RIGHT HAND
- \* COLD SIDE STEM - LEFT HAND
- \* LEVER HANDLES OR WRIST HANDLES
- \* SWING SPOUT

## SYSTEM LIMITS

- \* TEMP: 40°F MIN. TO 140°F MAX.
- \* PRESSURE: 200 PSI MAX. STATIC
- \* 2.20 GPM AT 80 PSI

## SHIPPING WEIGHT

- \* 5.0 LBS

- \* NSF 61-9 APPROVED & LISTED
- [www.truesdail.com](http://www.truesdail.com)

MODELS	DIM "A"	DIM "B"	DIM "C"
61220 61239	2-1/4" [57mm]	5-7/8" [149mm]	6" [152mm]
61093 61107	2-1/2" [64mm]	6-3/8" [162mm]	8" [204mm]
60968 60976	3-1/8" [79mm]	6-7/8" [175mm]	10" [254mm]
60836 60844	3-3/4" [95mm]	7-3/8" [187mm]	12" [305mm]
60690 60704	4-3/8" [111mm]	8-1/4" [210mm]	14" [356mm]
60569 60577	5" [127mm]	8-7/8" [225mm]	16" [406mm]

# FISHER

FISHER MANUFACTURING COMPANY

TOLL FREE: 800-421-6162 - FAX: 800-832-8238

information@fisher-mfg.com - [www.fisher-mfg.com](http://www.fisher-mfg.com)