



16 GAUGE STAINLESS STEEL

FIVE STATION A.D.A. WALL MOUNTED SQUARE CORNER SERVICE SINK WITH TUBULAR SUPPORTS

MANUAL OPERATED



Manual Operated
(Faucet Not Included)

Item #: _____ Qty #: _____
Model #: _____
Project #: _____



A.D.A.
COMPLIANT



FEATURES:

8 1/2" high backsplash.
5" sink bowl depth.
Three stainless steel "Z" brackets.
Two **K-6** 3 1/2" rear basket drains.
Four tubular stainless steel support brackets that allow full clearance underneath.
Manual Operated: Ten holes, 8" O.C. provided.
Faucets not included.

CONSTRUCTION:

All TIG welded.
Welded areas blended to match adjacent surfaces and to a satin finish.
Die formed tubular wall brackets.

MATERIAL:

All 16 gauge type "304" stainless steel.
1 5/8" tubular "304" stainless steel wall brackets.
Stainless steel gussets.

MECHANICAL:

Faucet holes 8" on center.

| Model # | Length | # of Faucets Sink Accommodates | # of Wall Supports | Wt. | Cu. Ft. |
|---------------|--------|--------------------------------|--------------------|----------|---------|
| 19-18-100-ADA | 100" | 5 | 4 | 118 lbs. | 35 |

(Faucets Not Included)

[Click Here For Install Guide](#)



MULTI-STATION ACCESSORIES & REPLACEMENT PARTS

| Model | Description | QTY: |
|----------|---|-------|
| K-6 | 3 1/2" Drain (1 1/2" I.P.S.) | _____ |
| K-13 | Stainless Steel Soap Dispenser (Wall Mount Only) | _____ |
| K-101 | 8" Swing Spout Splash Mt. Faucet | _____ |
| K-159 | Splash Mounted 3-1/2" Gooseneck Faucet (8" O.C.) | _____ |
| K-160 | Splash Mounted 6" Swivel Spout Faucet (8" O.C.) | _____ |
| K-411 | Strainer Plate for 3-1/2" Drain | _____ |
| K-1118 | Extra H.D. 8" Splash Mounted Faucet | _____ |
| K-316-LU | Wrist Handles | _____ |
| K-472 | Faucet Hole Revision (Manual Faucet Operated Sinks Only) | _____ |
| K-508 | Special Sizing Charge (Larger Size Cut Down To Smaller Size) | _____ |
| TA-19 | Adjustable Stainless Steel Flanged Bullet Foot | _____ |



K-159



K-160



K-13

FLOOR STANDING LEGS MODIFICATION

Converts Wall Mounted 19-18 SERIES Sink To A Free Standing Floor Unit.

- Stainless Steel Legs with Flanged Feet
- Sides and Rear Cross Bracing

| Model # | Fits Sink Length | QTY: |
|-----------|------------------|-------|
| FS-CB-100 | 100" | _____ |



= Ships UPS

Standard Faucets conform to NSF 61 Standard 9 and compliance to AB 1953 Standards.



Customer Service Available To Assist You **1-800-645-3166** 8:30 am - 8:00 pm E.S.T.

For Orders & Customer Service:

Email: customer@advancetabco.com or Fax: 631-242-6900

For Smart Fabrication™ Quotes:

Email: smartfab@advancetabco.com or Fax: 631-586-2933

REF-JJ

DETAILS and SPECIFICATIONS

TOL $\pm .500''$

FITTINGS SUPPLIED AS SHOWN

ALL DIMENSIONS ARE TYPICAL

19-18-100-ADA

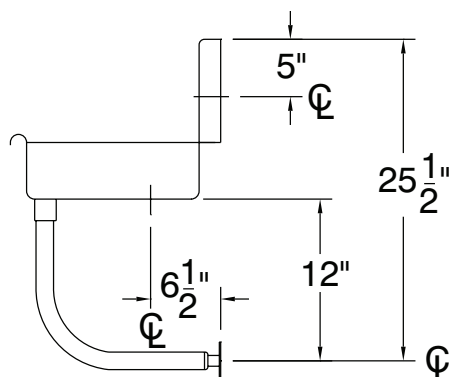

A.D.A.
COMPLIANT

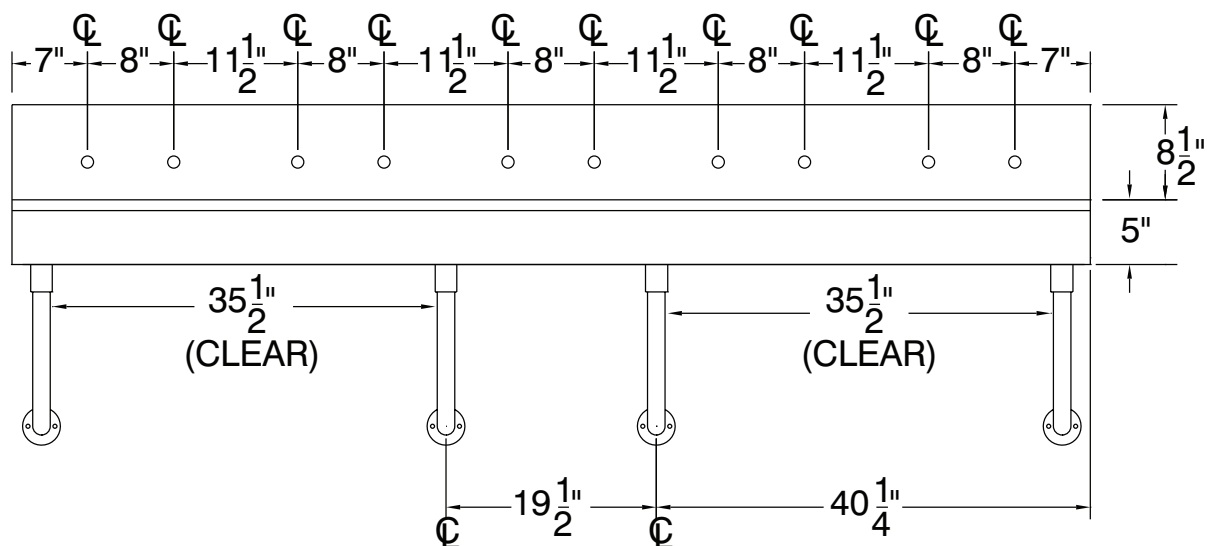
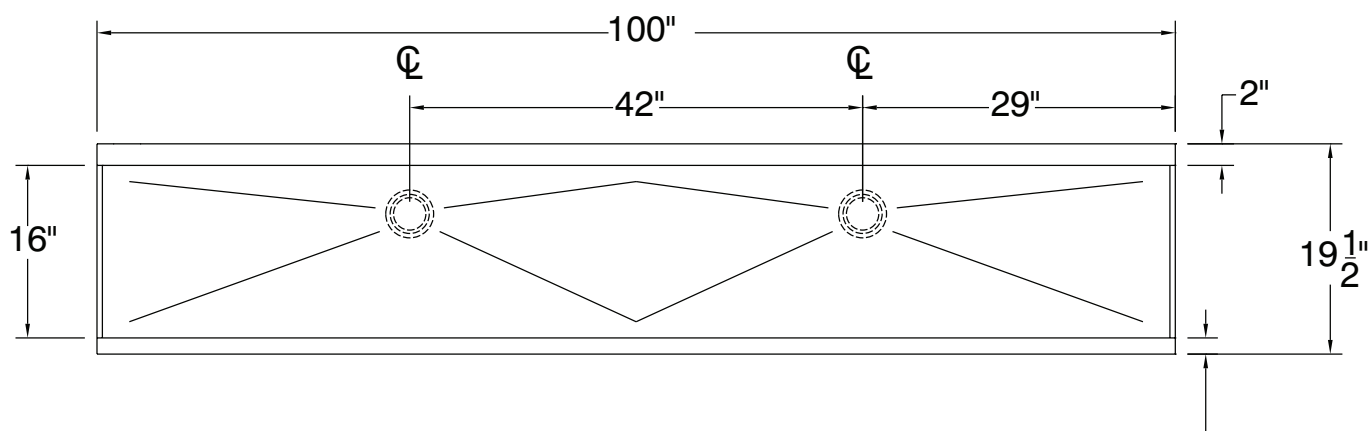

118 lbs.

