

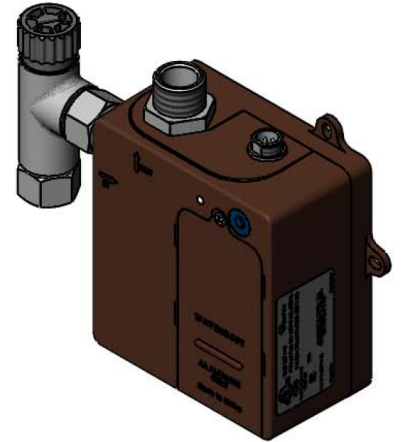

#### Architect/Engineering Specifications:

WaveCrest sensor faucet control module with brown module housing, flow control setting switches for adjusting auto time out & shut off delay settings, optional auto flush feature flows water for 30 seconds after every 12 inactive hours and hardwire capable using terminals on back . Certified to NSF 61-Section 9, NSF 372 and UL 1951.

Job Name \_\_\_\_\_  
 Model Specified \_\_\_\_\_ Quantity \_\_\_\_\_  
 Variations Specified \_\_\_\_\_  
 Date \_\_\_\_\_

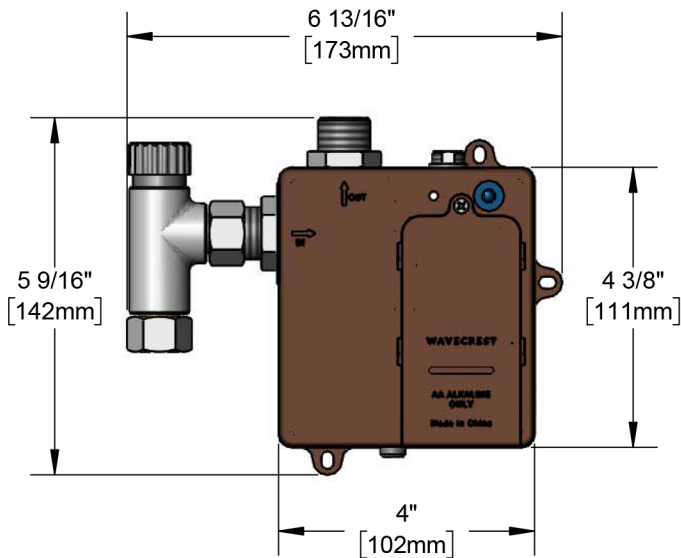

#### Features & Benefits:

- Water resistant WaveCrest sensor faucet control module w/ brown module housing
- Flow control setting switches behind battery cover for adjusting auto time out & shut off delay settings
- Optional auto flush feature flows water for 30 seconds after every 12 inactive hours
- Optional metering mode
- Hardwire capable using terminals on back with EC-HARDWIRE transformer (sold separately)
- Material: Chrome plated brass filter body & solenoid valve body

#### Product Compliance:

- UL 1951
- NSF 61 - Section 9
- NSF 372 (Low Lead Content)

**Warranty:** Three Year (Limited)

#### Performance Data:

- Pressure: 20 - 125 psi [1.38 - 8.62 bar]
- Temperature: 40°F - 140°F [4.44 C - 60 C]





# T&S BRASS AND BRONZE WORKS, INC.

2 Saddleback Cove / P.O. Box 1088  
Travelers Rest, SC 29690

Model No.

**020744-45**

Item No.

Travelers Rest, SC: 800-476-4103 • Simi Valley, CA: 800-423-0150 • Fax: 864-834-3518 • www.tsbrass.com

## WAVECREST™

BY T&S

This Space for Architect/Engineer Approval

Job Name \_\_\_\_\_ Date \_\_\_\_\_

Model Specified \_\_\_\_\_ Quantity \_\_\_\_\_

Customer/Wholesaler \_\_\_\_\_

Contractor \_\_\_\_\_

Architect/Engineer \_\_\_\_\_

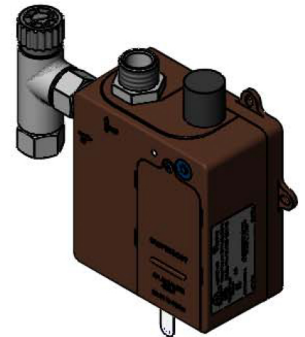
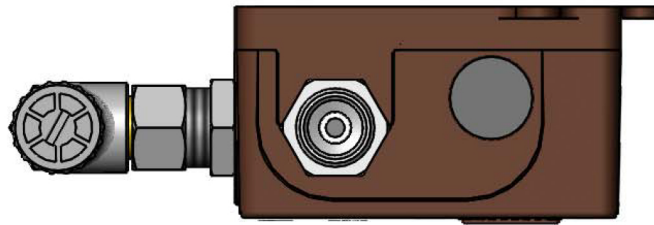

Water Resistant Faucet  
Sensor Cable Connection  
(Remove Protective Cap  
to Connect Cable)

1/2" NPSM Male Outlet

Removable  
Strainer

1/2" NPSM Female  
Swivel Coupling Nut

4" x 4 3/8" x 2 3/16" Deep  
[102mm x 111mm x 56mm]  
Water Resistant Control Module  
Box. AC or DC Operated w/ (4)  
AA Batteries. Hardwire Capable  
Using Terminals on Back

Water Resistant AC Adapter  
Cable Connection Port  
(Remove Rubber Plug  
to Connect Cable)

1 1/8"  
[28mm]

2 1/16"  
[52mm]

2 13/16"  
[72mm]

3 1/2"  
[88mm]

Batteries and Flow Control  
Setting Switches Behind  
Cover



### Product Specifications:

WaveCrest Sensor Faucet Control Module with Flow Control Setting Switches  
(Brown Module Housing)

### Product Compliance:

UL 1951  
NSF 61 - Section 9  
NSF 372 (Low Lead Content)



# T&S BRASS AND BRONZE WORKS, INC.

2 Saddleback Cove / P.O. Box 1088  
Travelers Rest, SC 29690

Model No.

**020744-45**

Item No.

Travelers Rest, SC: 800-476-4103 • Simi Valley, CA: 800-423-0150 • Fax: 864-834-3518 • www.tsbrass.com

ITEM NO.	SALES NO.	DESCRIPTION
1	EC-FILTER	Replacement Filter
2	020330-45	Solenoid Valve, M22 x 2 Male Thd

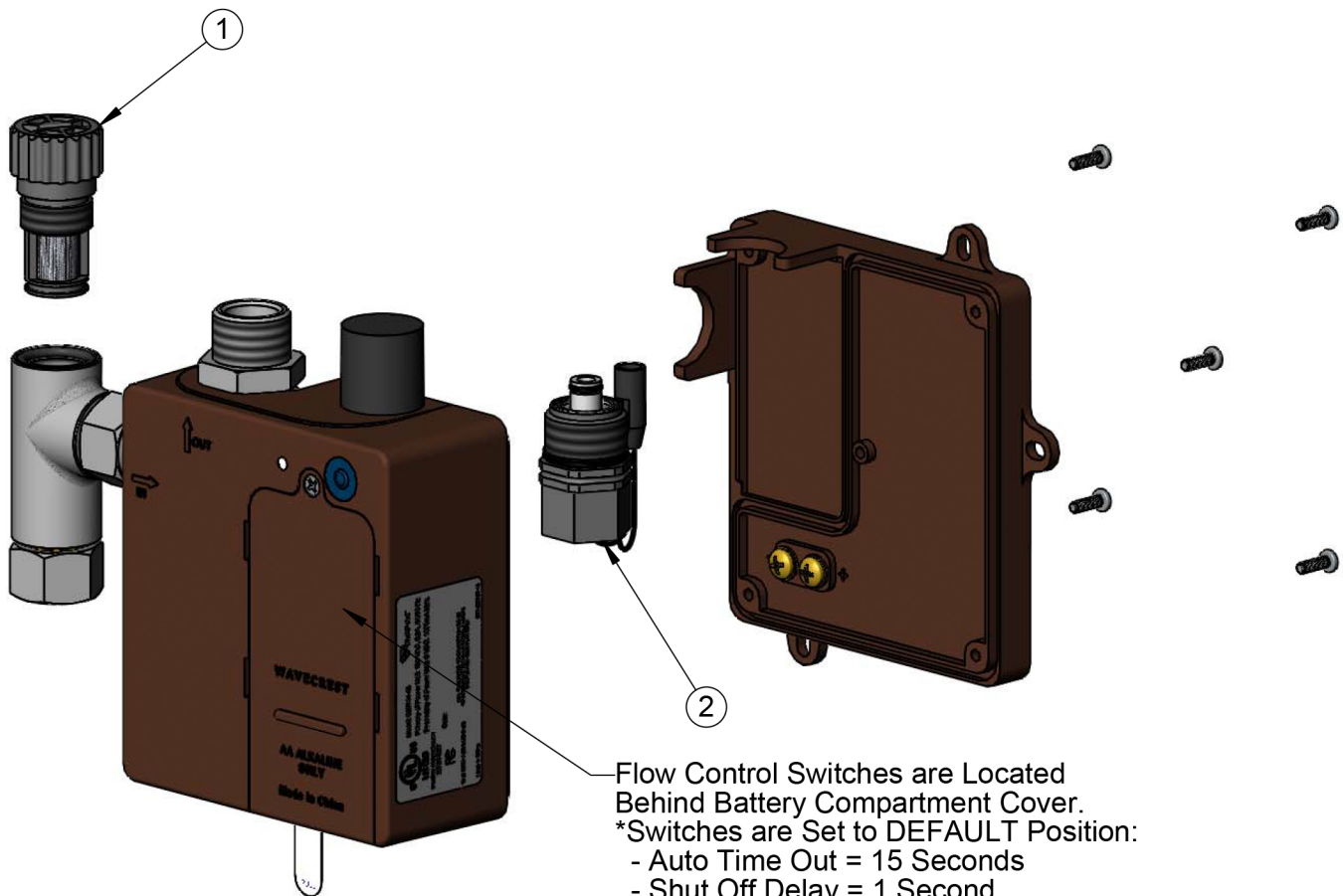

Flow Control Switches are Located Behind Battery Compartment Cover.  
\*Switches are Set to DEFAULT Position:  
- Auto Time Out = 15 Seconds  
- Shut Off Delay = 1 Second  
- Auto Flush = OFF  
- Metering Mode = OFF

## \*Available Water Flow Control Selections:

- Auto Time Out: 15 sec, 30 sec, 45 sec, 60 sec, 3 min, 20 min
- Shut Off Delay: 1 sec, 10 sec, 15 sec, 30 sec
- Auto Flush (30 Seconds After Every 12 Inactive Hours): ON or OFF
- Metering Mode: OFF

## Product Specifications:

WaveCrest Sensor Faucet Control Module with Flow Control Setting Switches (Brown Module Housing)

## Product Compliance:

UL 1951  
NSF 61 - Section 9  
NSF 372 (Low Lead Content)