

Z-Series Top Mount Foot Pedals

Parts List:

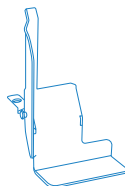

(3) M5x10mm Screws (Included with the Foot Pedals)



(1) 17810019K (Right Pedal)
or 17810018K (Left Pedal)

1. Pull out the plastic plugs on the mounting hole at the bottom of the Z-Series units where the foot pedal needs to be installed.

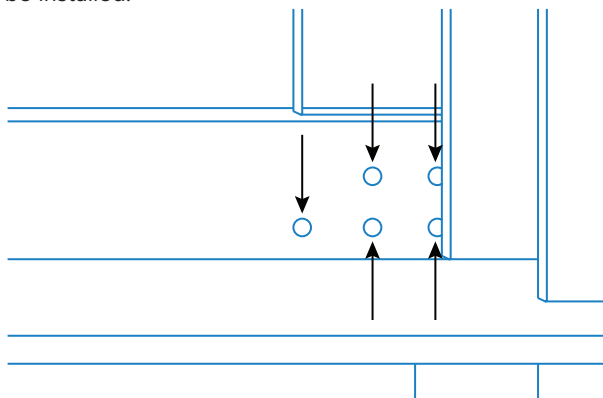

NOTE: Installing the foot pedal requires removing the wooden pallet before installation.

2. Open the foot pedal according to the style shown in the below picture, exposing the installation holes. Install the pedal on the cabinet using the three M5x10mm screws.

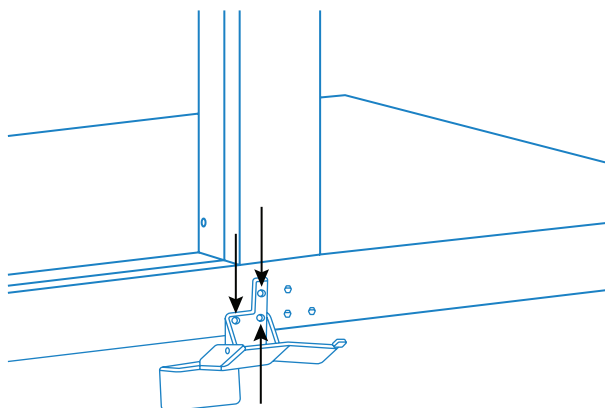

3. After installation, test the foot pedal. If the foot pedal position is not ideal, you can loosen the screws and adjust the position left and right as shown. Retighten the screws before use.

