



Wire Hanging Cradle

for Vigor 5.5 Gallon Square Ice Bucket

Installation Instructions

1. To install the wire Vigor hanging cradle on the 5.5 gallon square Vigor ice bucket, start with making sure the ice bucket is empty.
2. Place the cradle on a countertop with the hanging arm facing away from you.
3. Lift the Vigor ice bucket by the handle and position over the cradle, with the "ICE ONLY" text facing you.
4. Lower the ice bucket into the wire cradle. Gently press down on the bucket until the wire is positioned above the d-tent on the ice bucket. You should hear a "click" as the ice bucket is secured inside the cradle.
5. Before placing ice inside the unit, test the bucket by placing the hanging arm on your ice machine. If secure, proceed with filling the bucket with ice.
6. To remove the cradle from the ice bucket, pull the wire portion resting on the d-tent outwards and downwards while pulling the ice bucket upwards until the d-tent is fully positioned above the wire. Then, simply lift the ice bucket out from the cradle.

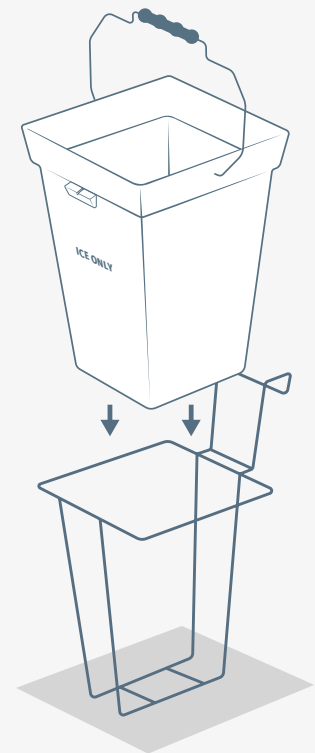

1. 2. 3.

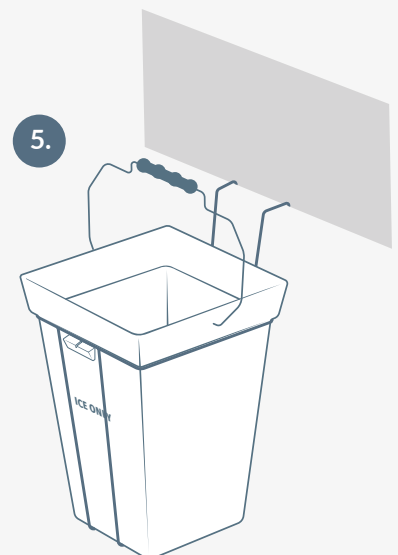
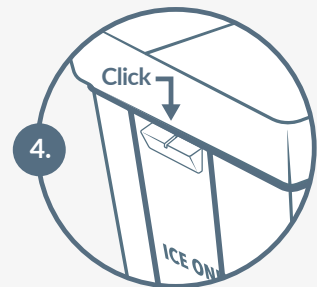

5.