

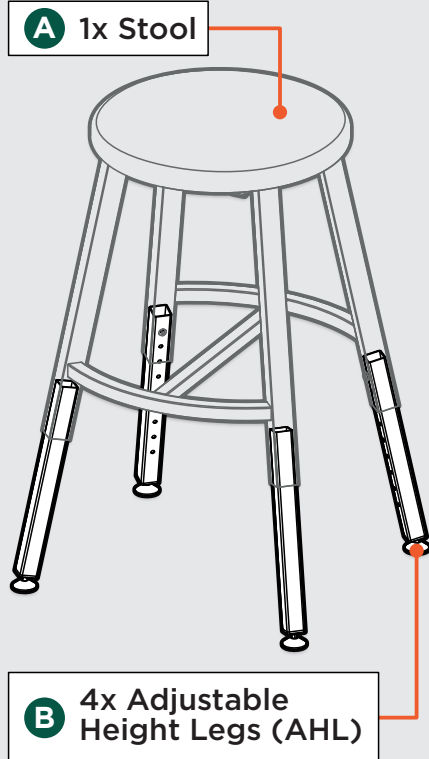

STOOL COMPONENTS

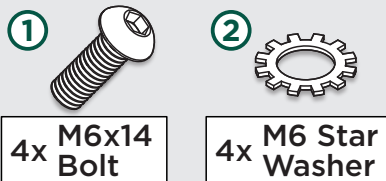

INCLUDED HARDWARE



TOOLS FOR ASSEMBLY



- 1** Turn stool upside down on a flat surface and remove all four glides.

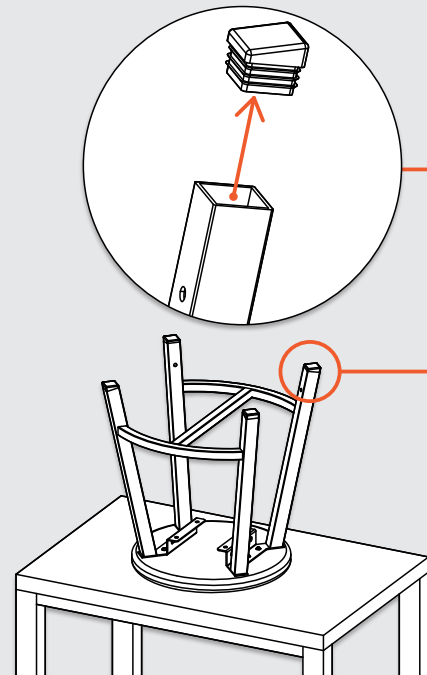

- 2** Insert each AHL **B** into each stool leg hole. Align the hole on the Stool leg with the hole on the AHL to desired height. Drive the supplied M6x14 Bolt **1** and M6 Star Washer **2** through both holes and tighten securely using Allen Wrench **3**.

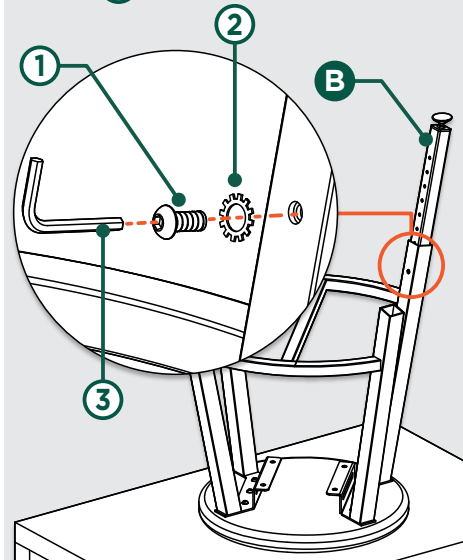

! Ensure that all bolts are fastened tightly.

- 3** Be sure to align all legs at same height.

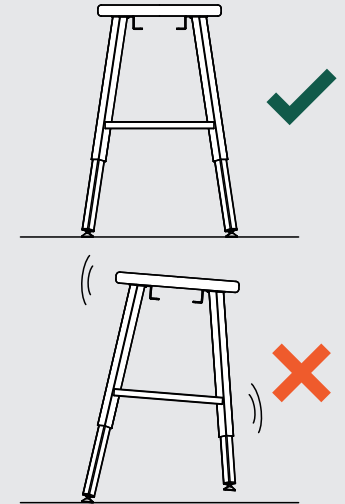

! Double check all bolts to be tightened securely before use. Check all screws periodically. Failure to completely tighten the screws may result in tipping and possible injury!

Congratulations, your stool with adjustable height legs is now assembled and ready to be used!