

# Maintenance

Safety  
information for  
maintaining the  
appliance

82

Cleaning

84

Inactivity

88

Disposal

90

Certification

90

## SAFETY INFORMATION FOR MAINTAINING THE APPLIANCE



Any routine maintenance procedure must be performed:

- after disconnecting the appliance from the power supply and waiting for the capacitive components to discharge (approx. a few minutes;
- after waiting for the appliance to cool down fully;
- only if you are in good mental and physical condition, and are wearing suitable personal protective equipment (e.g. heat-resistant rubber gloves, eye protection, dust mask (optional), etc.).

**Clean the appliance on a daily basis** in order to maintain a good level of hygiene and to prevent the stainless steel from corroding or deteriorating.



Daily cleaning also reduces the possibility of accumulated fatty substances or food residues inside the cavity catching fire and becoming a fire hazard.

When cleaning any component or accessory NEVER use:

- abrasive, pointy or sharp tools or cloths (abrasive sponges, scrapers, steel-bristled brushes, etc.);
- steam or pressurised water jets;
- abrasive or powder detergents;
- alkaline, aggressive, caustic or corrosive detergents (e.g. hydrochloric/muriatic or sulphuric acid or caustic soda). These substances could cause permanent damage to the appliance surfaces and catalysts.



Do not use these substances even when cleaning the appliance substructure or the floor under the appliance. The volatile emissions from these compounds may still cause damage.



The appliance is equipped with a VOC catalyst which is located behind the inner wall of the oven cavity. It is used for cleaning the recirculation air flow.

If the catalyst is exposed to chemical detergents containing phosphates, NaOH, silicates, Na and potassium salts, irreversible damage may be caused. These chemicals are found in most commercial degreasers and detergents; therefore, we recommend using SPRAY&Rinse™ detergent, specifically designed for SPEED.Pro to maintain oven performance.

## CLEANING

 Wait for the appliance to cool down fully.

- **64** ▶ Open the oven door and remove the ▶ **plate and/or baking trays (A)**. Wash the plates/trays using a soft sponge and warm, soapy water. Rinse and dry thoroughly.

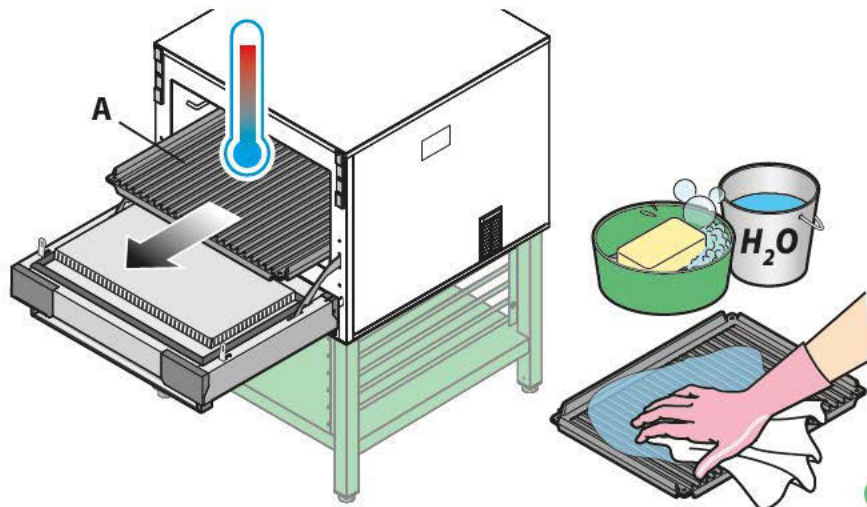

64

- **65** ▶ ① Clean the ▶ **seal (C)** using a soft cloth dampened in warm, soapy water. ② Start the "MANUAL CLEANING" function touching the icon in the oven home screen.
- **66** ▶ Depending on the current oven temperature, three different screens may appear:
  - Ⓐ the oven temperature is **lower** than expected: a heating phase starts ▶ wait for SPEED.Pro to reach the optimum temperature;
  - Ⓑ the oven temperature is **higher** than expected: a cooling phase starts, to be carried out with the door open ▶ wait for SPEED Pro to reach the optimum temperature;
  - Ⓒ the oven temperature is optimal for cleaning.

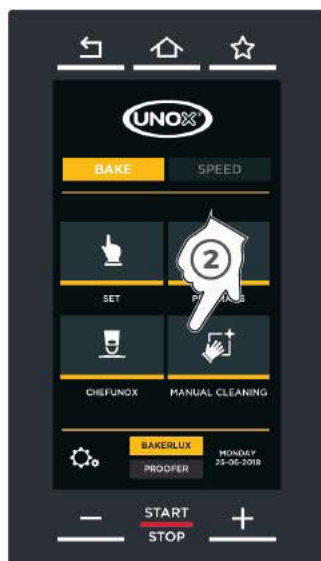
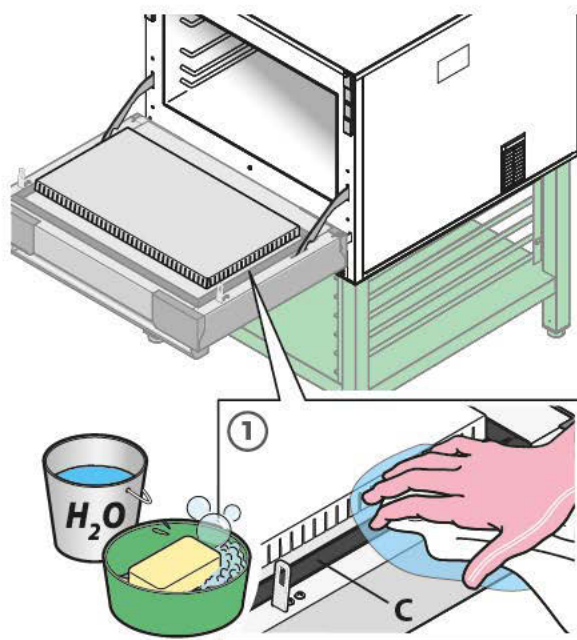

65

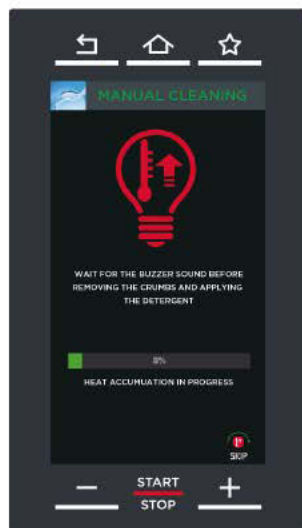

**(A) temperature too low:  
wait for heating**



**(A) temperature too high:  
wait for cooling**



**(C) correct temperature**

66

- **67** ▶ When the oven has reached the optimal cleaning temperature, highlighted by the screen displayed **(C)** - figure **66**, remove more substantial food residues from the **oven cavity** using kitchen roll or a clean, dry brush.
- **!** Remove any crumbs from inside the cavity and especially from the ▶ **slits (B)** in the panel on the back of the door on a regular basis.

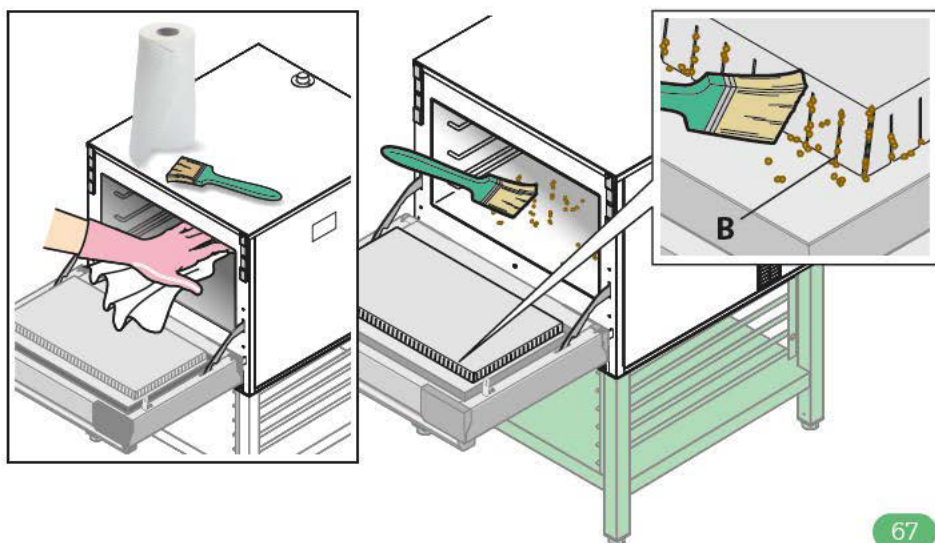

67

- **68** ▶ **Wearing rubber gloves and goggles,** spray UNOX SPRAY&RINSE inside the oven cavity without exaggerating. **DO NOT spray the product on the door seal "C"** as this may cause damage over time. By using this detergent, you are guaranteed excellent cleaning results. The product is fully compatible with the materials this appliance is made from. Alternatively, only use warm soapy water.
- **69** ▶ ① After applying the detergent, close the door; ② a screen is displayed telling you to wait for the detergent to work, the display also shows the decreasing time.

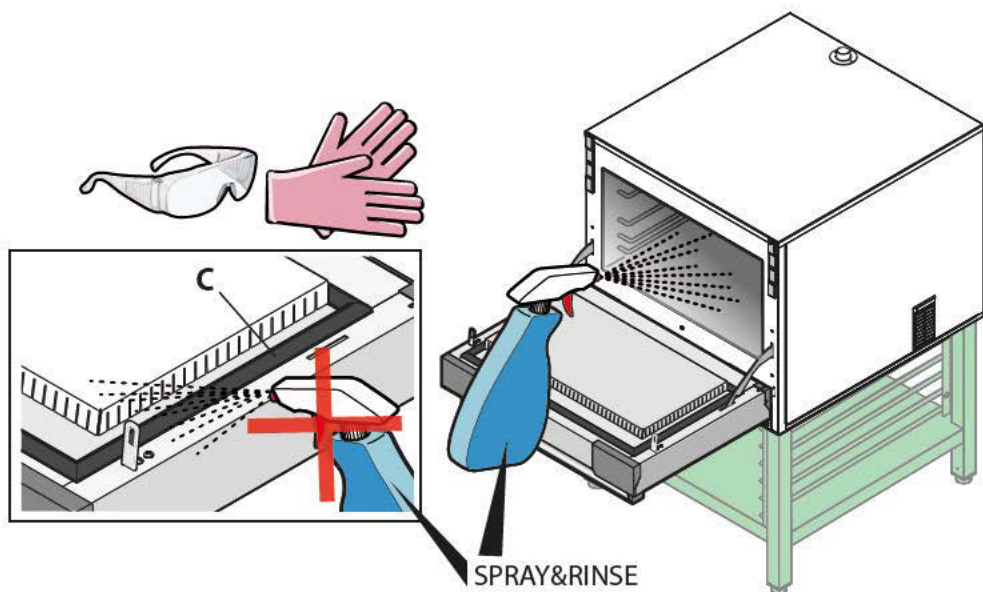

68

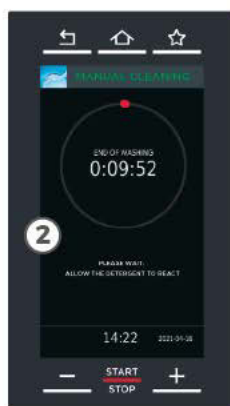
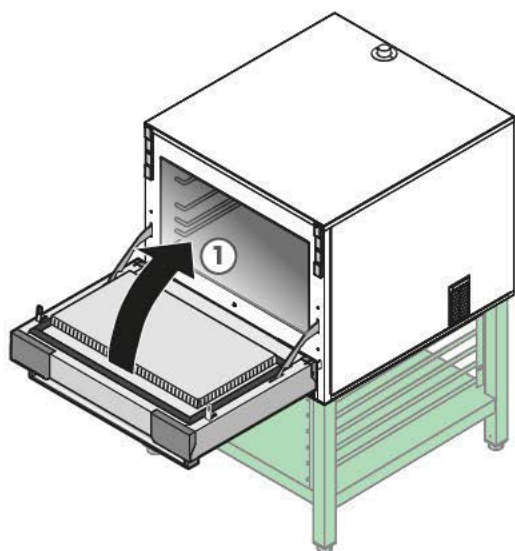

69



- **70** ▶ ① When the screen shown in the figure is displayed, it is possible ② to remove the softened residue with a soft sponge. Do not use abrasive, sharp or pointy tools or cloths (e.g. abrasive sponges, scrapers, steel brushes, etc.).
- **After, rinse thoroughly** with a damp cloth to remove any traces of detergent. Dry with a clean cloth or kitchen roll.
- Close the oven door and clean the ▶ **external steel surfaces** with a soft cloth, dampened with soapy water. Take care to avoid seepage under the control panel. Rinse and dry carefully. Wipe steel surfaces regularly with a soft cloth doused in Vaseline oil to protect them.
- **71** ▶ Remove the ▶ **air filter (D)** from its magnetic housing and empty the crumb tray. Apply UNOX SPRAY&RINSE detergent over the entire surface of the filter and leave for 10 minutes. Rinse thoroughly and dry with a clean cloth. Put the filter back in place.



Do not wash the suction filter in the dishwasher.



The filter must be completely dry before starting the appliance.



SPEED.Pro™ does not work without the suction filter. There is a sensor to detect when it is there and warn you if it is not.

## INACTIVITY

During periods of inactivity, take the following precautions:

- disconnect the appliance from the power supply;
- preferably rub a soft cloth lightly doused with Vaseline oil on all stainless steel surfaces;
- keep the appliance door slightly ajar.

Before reusing the appliance:

- clean the appliance and accessories thoroughly (see page **84**);
- reconnect the appliance to the power supply;
- inspect the appliance before using it again;
- restart the appliance for at least 50 minutes without any food inside and with the microwave set to 0%.



To ensure that the appliance is in perfect condition in terms of use and safety, maintenance and inspections should be performed at least yearly by an authorised support service centre.

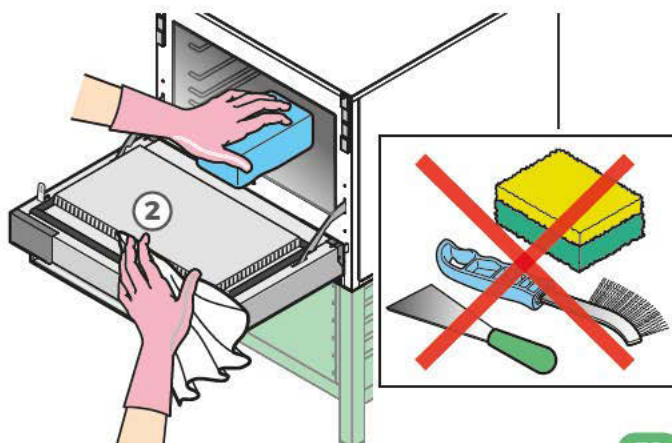

70

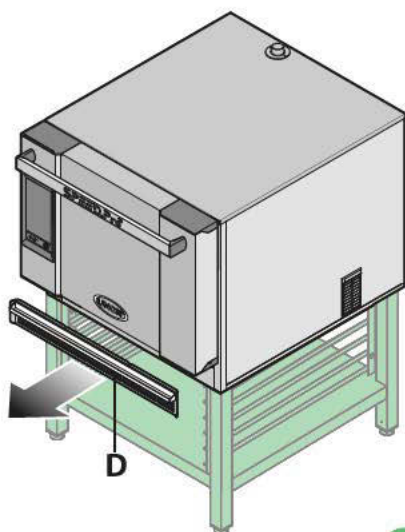
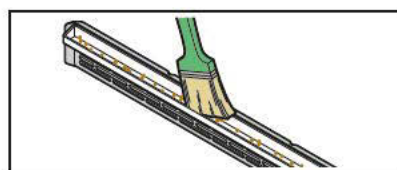

71