

# ASSEMBLY INSTRUCTIONS

## SILVERWARE CARTS

**SERVIT** HOLD IT  
HEAT IT  
MOVE IT

MODELS: 423TSC24 & 423TSC32

### PARTS

**A** Base (1)

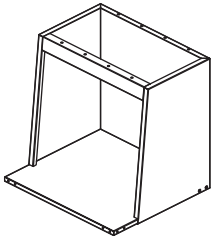

**B** Top (1)



**C** Screw M6x10 (8)

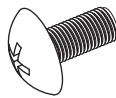

**D** Bumper (4)

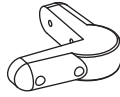

**E** Caster (4)



**F** Washer (16)

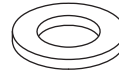

**G** Lock Washer (16)



**H** Bolt M8x16 (16)

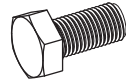

**I** Screw M4x25 (16)



### STEP 1

Flip Base (A) upside down and attach 4 Casters (E) using 4 Bolts (H), 4 Lock Washers (G), and 4 Washers (F) each.

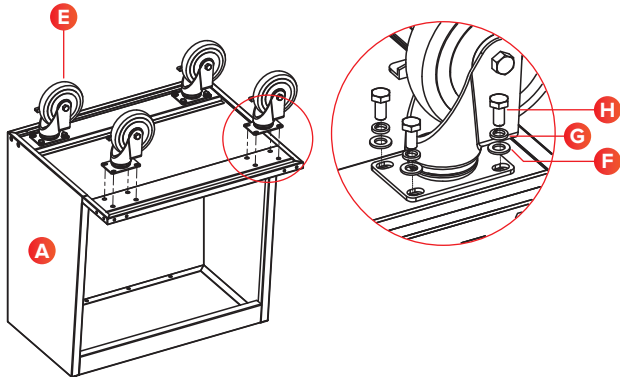

### STEP 2

Attach the 4 Bumpers (D) to each corner using 4 Screws (I) each.

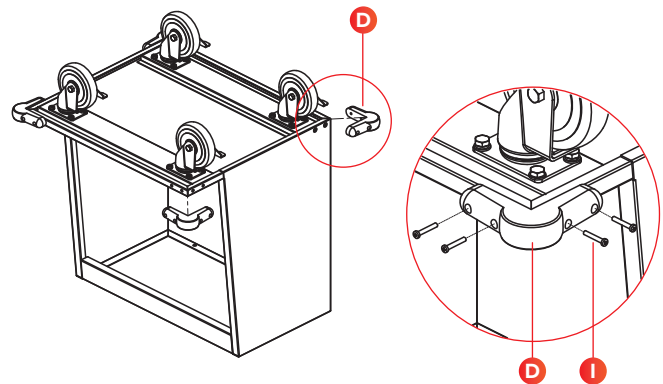

### STEP 3

Flip Base (A) rightside up, onto installed Casters. Attach the Top (B) onto the Base (A) using 8 Screws (C).

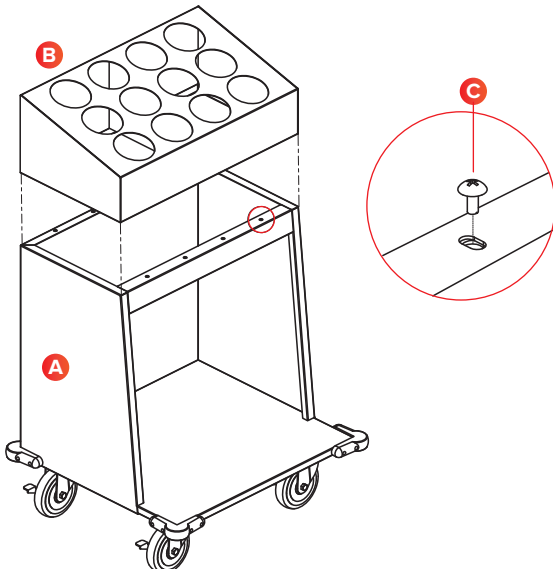

### ASSEMBLED

Make sure all bolts and screws are securely fastened.

