

Sensor Faucet Instructional Guide

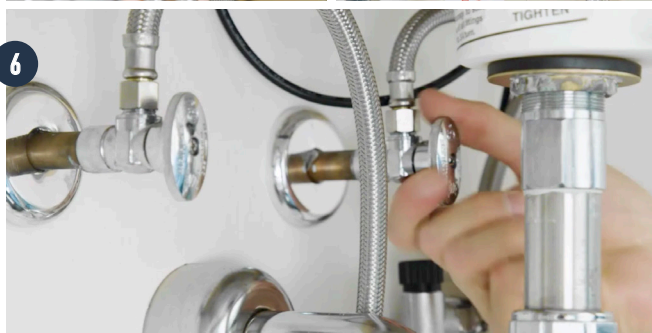

WATERLOO

An automatic faucet from Waterloo provides an efficient and sanitary way for employees to wash their hands. To ensure that your faucet is set up properly, follow this step-by-step installation guide.

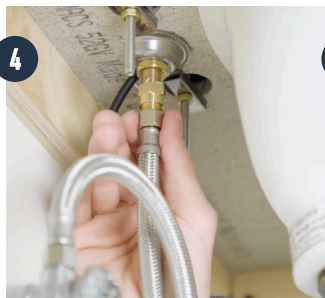
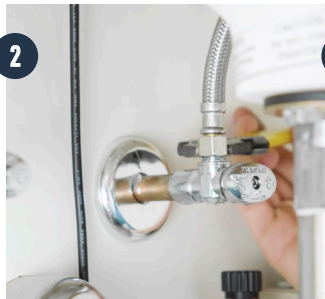

1. Place the faucet on the sink, lining it up with the mounting holes. Then tighten the hardware underneath to ensure that the faucet is secure.
2. Connect your flex water lines to the shut off valves, and attach the control module to the wall.
3. Connect the mixing valve to the water lines. Then, attach the flex line to the faucet inlet and the control module outlet.
4. Connect the sensor cable to the module, and screw in the connector cover. Now turn on the water to make sure there is no leaking.
5. Make sure the control module is either plugged in with the AC adapter or utilizing batteries.

The sensing distance on the faucet is pre-set; however, it can be further adjusted following these easy steps.

6. Begin by pressing and holding the on/off button on the control module for about five seconds. The water will flow for a moment, and the LED light on the sensor will flash on and off as the water flow stops.
7. Release the on/off button and place your hand at the chosen distance from the sensor. The LED light will flash ten times, then stay illuminated on the tenth flash to tell you that the range setting has been saved.
8. Finally, set a comfortable water temperature using the manual mixing valve. Your brand new Waterloo automatic faucet is now set up and ready to use!