

APPROX WEIGHT: 250.11 lbs.  
DOES NOT INCLUDE WEIGHT OF POWER OR PACKAGING!!!

# ADJUSTABLE PALLET STAND - PS-4045/CA

\*\*\* ANY ADDITIONS, DELETIONS, OR OMISSIONS MUST BE CORRECTED ON THIS DRAWING AS THIS DRAWING WILL BE CONSIDERED ALL INCLUSIVE \*\*\*  
ALL GRAPHICS PROVIDED ARE FOR REFERENCE ONLY. IF CERTAIN DIMENSIONS ARE CRITICAL PLEASE VERIFY THOSE DIMENSIONS WITH YOUR SALESPERSON

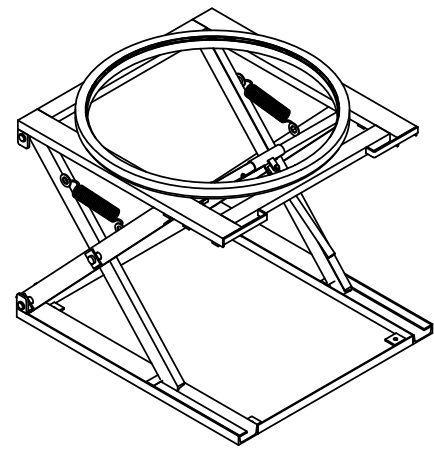
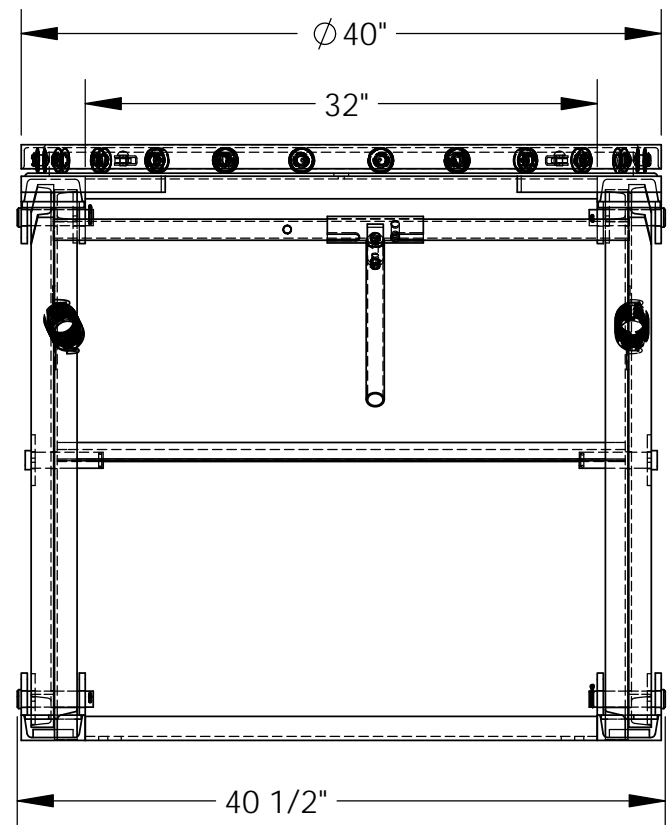
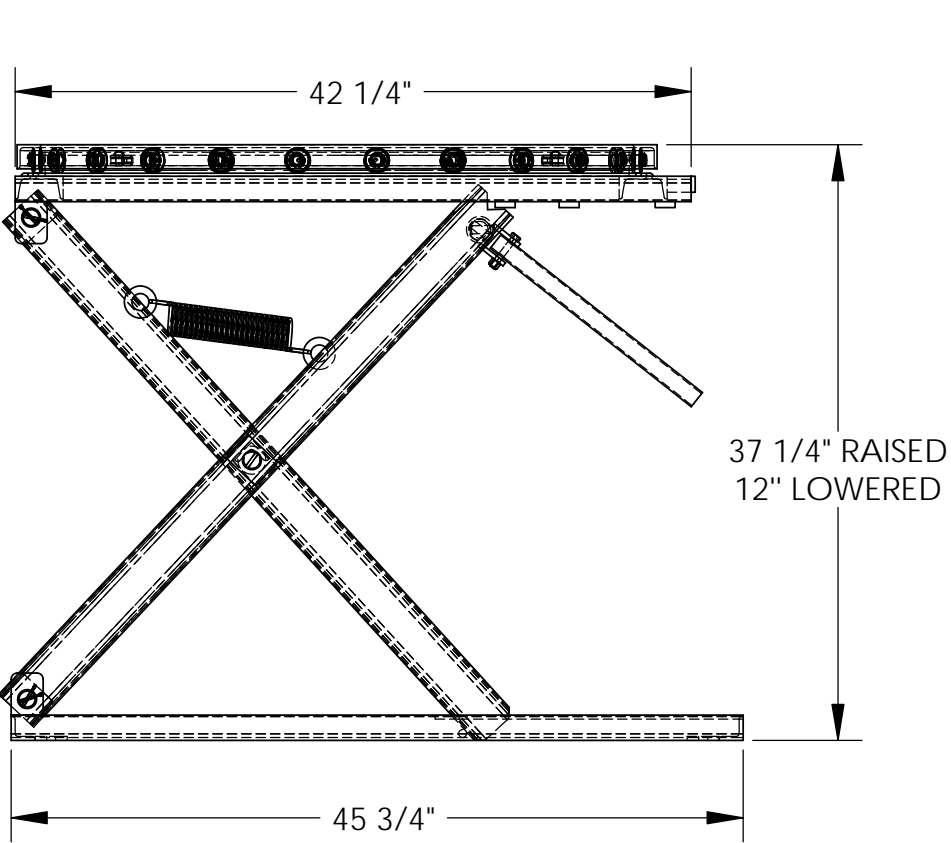

3D VIEW SHOWN FOR  
REFERENCE ONLY

## STANDARD FEATURES

## SPECIAL FEATURES

- MODEL NUMBER IS PS-4045/CA
- CAPACITY IS 4,000 POUNDS
- OVERALL WIDTH IS 40 1/4"
- USABLE WIDTH IS 40"
- OVERALL LENGTH IS 45 3/4"
- USABLE LENGTH IS 42 1/2"
- RAISED HEIGHT IS 37 1/4"
- THIRD SETTING IS 32 1/2"
- SECOND SETTING IS 22 1/4"
- LOWERED HEIGHT IS 12"

NONE

APPROVAL	I, THE UNDERSIGNED, AGREE THAT THE PRODUCT AS REPRESENTED SATISFIES DESIGN AND DIMENSION REQUIREMENTS. I ALSO ACKNOWLEDGE MY DUTY TO CONFIRM PRODUCT AND INSTALLATION COMPLIANCE WITH ALL APPLICABLE FEDERAL, STATE AND LOCAL REGULATIONS AND STANDARDS.	
	<b>ALL SPECIAL UNITS ARE NON-RETURNABLE</b>	
	[ ] As drawn [ ] As marked	
	Signed: _____ Date: _____	
LEAD TIME WILL START UPON RECEIPT OF SIGNED APPROVAL DRAWING		

DISTRIBUTOR'S NAME:		P.O.#
VESTIL MANUFACTURING		X
DRAWN BY: DLS		W.O.#
DATE: 04/22/2013		X
REFERENCE: X	SCALE: 1:12	SALES: X
QUOTED LEAD TIME: X	QUOTE # X	FILE NAME:
		15-007-127