

Thank you for your purchase!

**Wooden 3 Section School Classroom Storage
Cabinet for Commercial or Home Use - Safe, Kid
Friendly Design - 36"H (Natural)**

ASSEMBLY INSTRUCTIONS

Before You Begin: Phillips screwdriver (not included) required for assembly

Please identify all component parts and hardware pieces required before you begin. Carefully remove all of the components from the packaging and set aside for assembly. Assemble on a soft surface to prevent scratching during assembly.

Phillips screwdriver required for assembly (Not Included).

Caution:

Tighten all components securely before use. Failure to do so may result in personal injury. DO NOT use any sharp objects to open plastic wrapped components as damage to product or components may result.

⚠ Warning:

CHOKING HAZARD - Small Parts Adult Assembly Required.

DO NOT ALLOW CHILDREN TO CLIMB ON FURNITURE.

The tipping restraint is intended only as a safety measure, it is not a substitute for proper adult supervision.

Serious or fatal injuries can occur from furniture tipping over. You must install Tipping Restraint Hardware (where included) to help prevent the unit from tipping and causing accidental injury, instability, death or damage. The tipping restraint is intended only as a safety measure, it is not a substitute for proper adult supervision.

To help prevent furniture from tipping over it must be permanently attached to the wall. Anti-Tip Safety Wall Straps suitable for the unit weight and wall materials (if not included) should be purchased and installed.

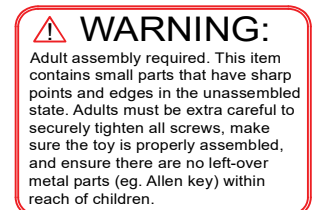

**Customer Service Email: CustomerExperience@TheUbiqueGroup.com | Phone: 866-552-2810
MK-STRG001-GG**



Congratulations!

You just purchased a piece of happiness. At Ubique Group, we believe you can transform your spaces into the most inspired places with furnishings that are the perfect combination of form, function and style. As original innovators of online furniture retail, we offer the best selection of popular, contemporary styles at cool, comfortable prices. And, with decades of proven shipping and packaging expertise, our Extended Quality Checklist ensures a rewarding, hassle-free experience time and time again. It's just what you need to bring your vision to life.

Thank you & Enjoy!!

your friends at Ubique Group



LIKE IT!

*Share it on social
& tell a friend!
#Spaces2Places*



LOVE IT!

*Write an online
product review
where purchased*



NOT SURE?

*Let us help!
Contact our
customer support.*

Have a question, concern or simply need a hand? Your satisfaction is our top priority. Contact us at 866-552-2810 or CustomerExperience@TheUbiqueGroup.com. We're here to help!

Browse Our Branded Collections

There's something for everyone inside our family of brands.



MERRICK | LANE

Taylor & Logan

Emma+Oliver®



BlackArc®

Visit www.TheUbiqueGroup.com/brands or scan this code.





We pride ourselves on providing an excellent customer experience starting right here with your package and instructions. Everything you need should be right where you need it, so you can get to enjoying your new item ASAP. But despite our best efforts, sometimes "slips happen." If you need any support, from replacement part to recommendations, please reach out to our wonderful customer support team at 866-552-2810 or CustomerExperience@TheUbiqueGroup.com. We're here to help!

EVERY UBIQUE GROUP PRODUCT



Quality &
Durability Tested



Packaged
with Care



Shipped from
our U.S. Facility

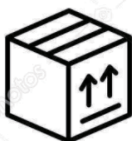

Designed
for Easy
Assembly



Ethically
Sourced

Please visit <https://www.TheUbiqueGroup.com/warranty> for complete warranty information.

Read this manual before using this product. Failure to follow the instructions and safety precautions in this manual can result in serious injury or death. Keep this manual in a safe location for future reference.

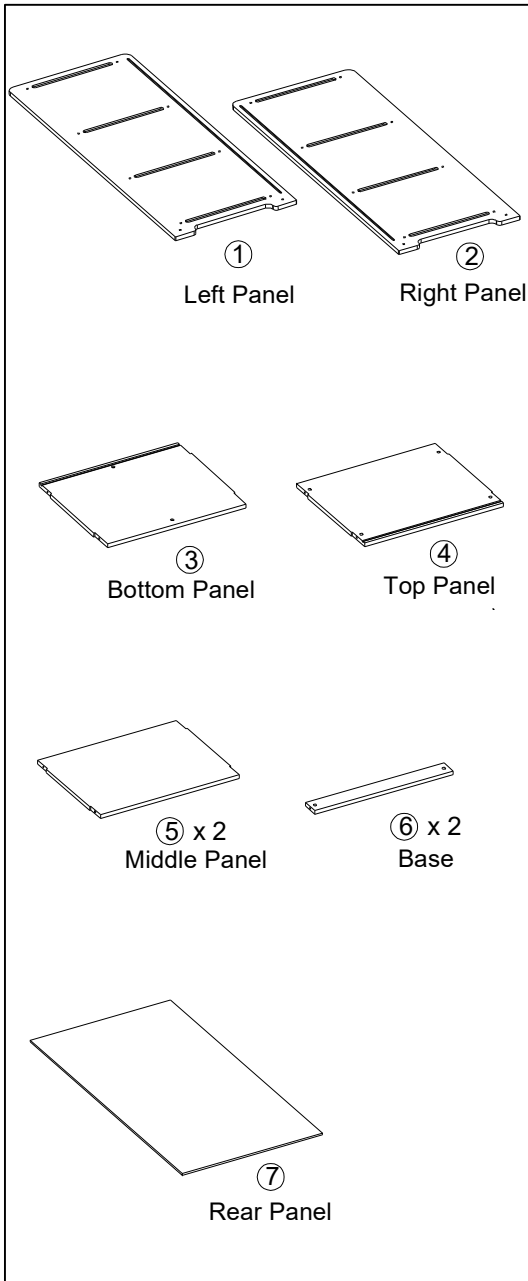

20230602

Tool Required



Hardware Included:

M4x35 A x 2	M5x39 B x 20	M4x16 C x 1
M4x36 D x 1	Wall Security Strap E x 1	

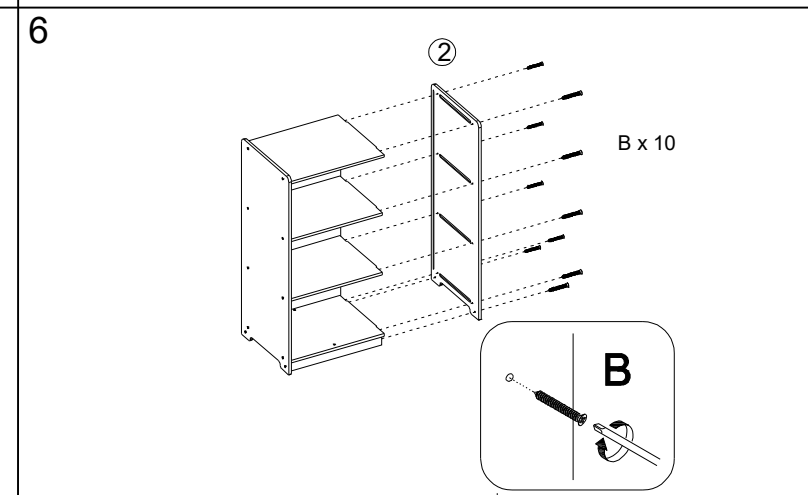
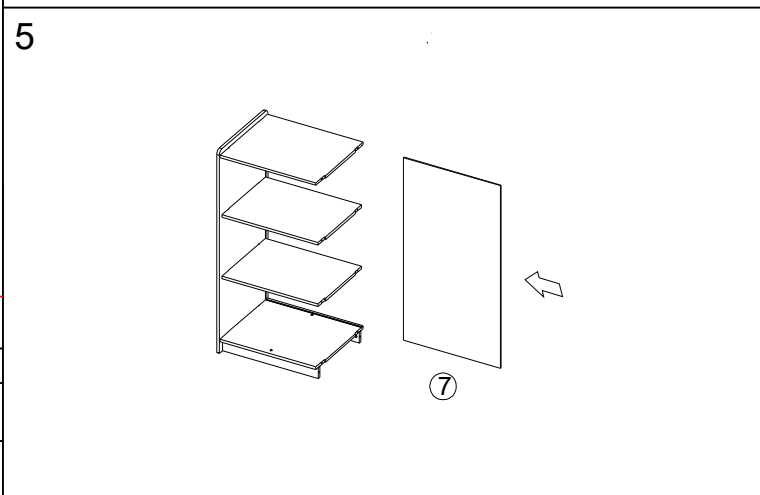
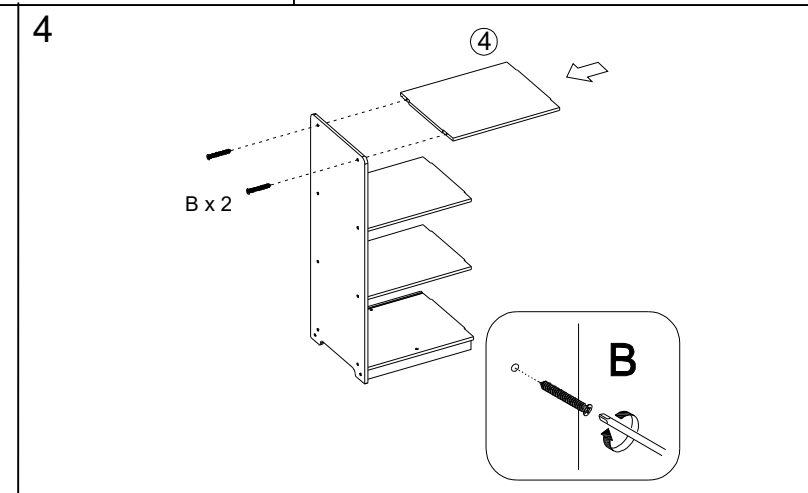
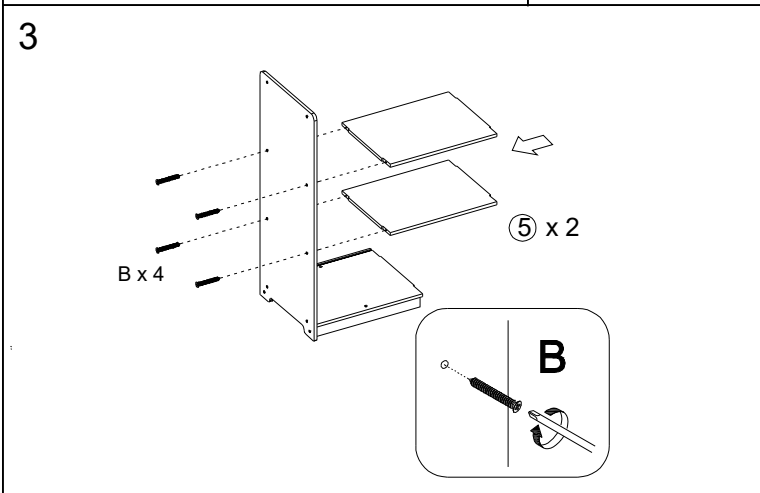
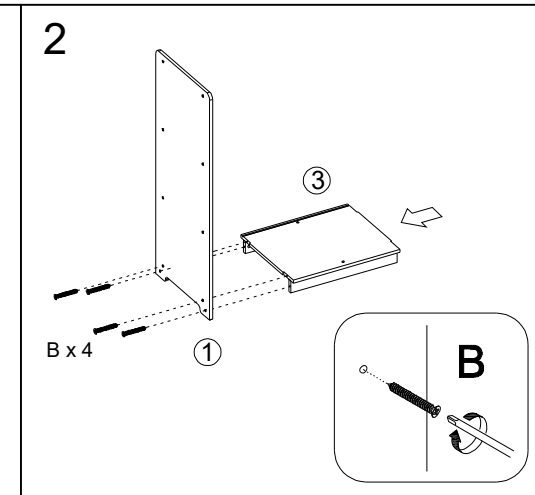
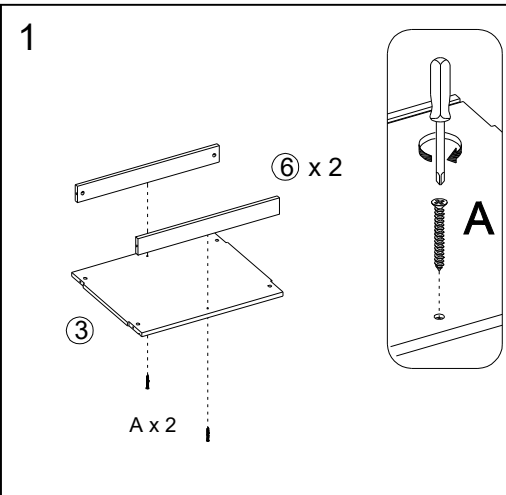
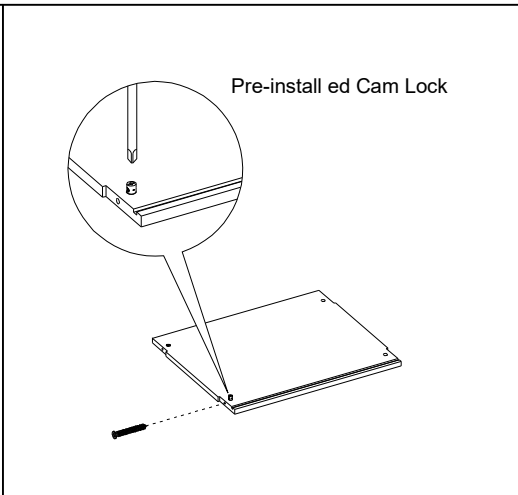

FINISHED

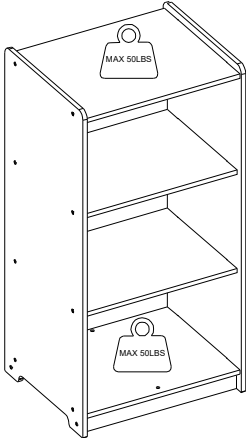

WARNING:
CHOKING HAZARD - Small Parts
Not For Children Under 3 Years.



WARNING:
Adult assembly required. This item contains small parts that have sharp points and edges in the unassembled state. Adults must be extra careful to securely tighten all screws, make sure the toy is properly assembled, and ensure there are no left-over metal parts (eg. Allen key) within reach of children.

WARNING

Serious or fatal crushing injuries can occur from furniture tip-over. To help prevent tip-over:
Install tip-over restraint provided.
Place heaviest items in the lowest drawers. Do not set TV or other heavy objects on top of this product. Remove unless the product is specifically designed to accommodate them. Never allow children to climb or hang on drawers, doors, or shelves. Never open more than one drawer at a time.
Do not defeat or remove the drawer interlock system.
Use of tip-over restraints may only reduce, but not eliminate, the risk of tip-over.
This is a permanent label. Do not remove!



Step1:
ATTACHING STABILIZING
STRAP(against wall)

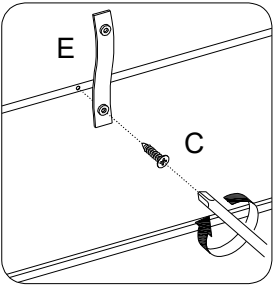
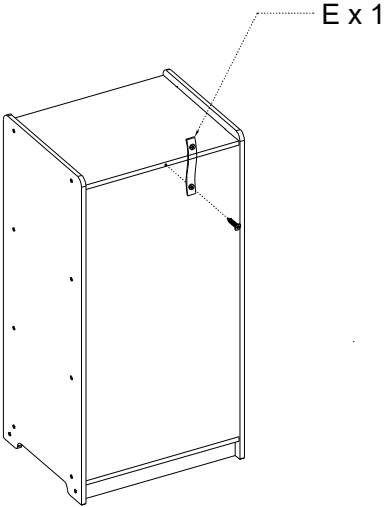

Step2:

