

## Server Express® Pumps

**MODELS:**

**07392**

**07398**

Used with pouches up to  
1½ gallons with 16mm fitments.

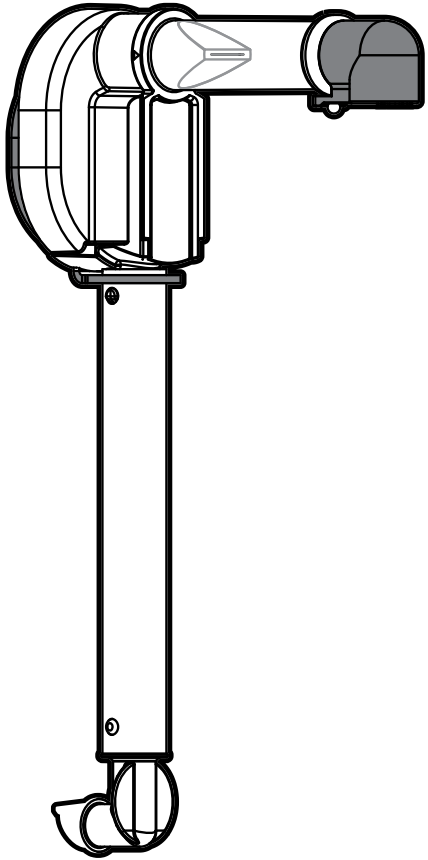
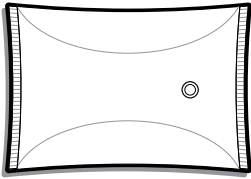

### ***Thank You***

for purchasing our Server Express® Pump.  
Express™ pouched condiment systems are sealed and  
sanitary, achieve excellent evacuation and have only a  
few parts for easy clean-up.

SIMPLIFY CONDIMENT MANAGEMENT— GO POUCHED

# ASSEMBLY

WASH ALL PARTS  
PROPERLY BEFORE USE. See page 3.

- 1** INSERT PINCH VALVE  
into pump housing.

*TIP: Squeeze the pinch valve  
open before installation to  
ensure it isn't stuck shut.*

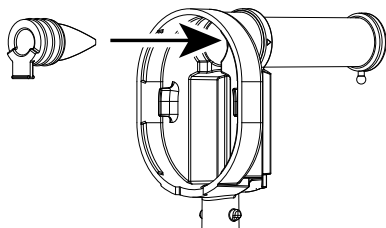

- 2** INSTALL DOME

Press dome into  
housing fully.  
Ensure valve flap  
covers bottom  
opening.

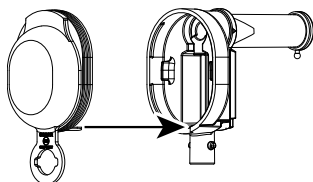

Wrap loop  
around lower  
opening to  
secure dome.

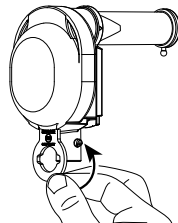

- 3** INSTALL TUBE

Lubricate with a small amount of clean water.  
Rotate and position until both pegs on  
housing fit into holes on tube.

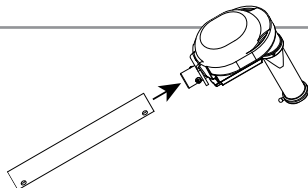

- 4** INSERT CONNECTOR

Lubricate with a small amount of clean water.  
Rotate and position until both pegs on  
connector fit into holes on tube.  
Connector must point away from end of  
discharge tube.

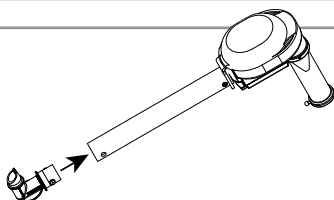

- 5** SELECT DISCHARGE FITTING

if applicable. Page 4 lists discharge fitting  
size(s) included with each pump model.

## CONSISTENCY OF WHAT YOU DISPENSE

## SUGGESTED FITTING SIZE

THIN (hot sauce)..... SMALL  
THICK (ketchup or mustard)..... MEDIUM  
THICKER (relish or tartar sauce)..... LARGE

*Fittings are marked small,  
medium or large on bottom.*

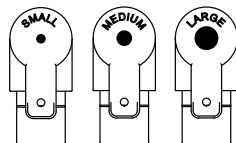

- 6** INSERT DISCHARGE FITTING

into pump housing discharge tube.

Place loop of fitting around peg on end of  
discharge tube to secure.

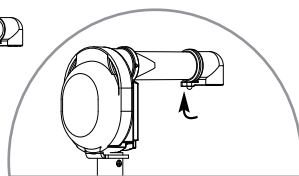
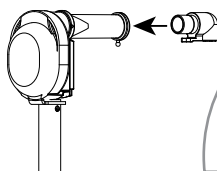

# SAFETY



## IMPORTANT

Clean, rinse, sanitize, and dry parts daily or regularly to comply with local sanitization requirements.

According to food and safety regulations, most foods must be stored and/or served at certain temperatures or they could become hazardous. Check with local food and safety regulators for specific guidelines. Server Products, Inc. cannot be responsible for the serving of potentially hazardous product.



NSF International lists this pump as:  
"Not acceptable for dispensing potentially hazardous foods."

ADA  
compliant

# DISASSEMBLY

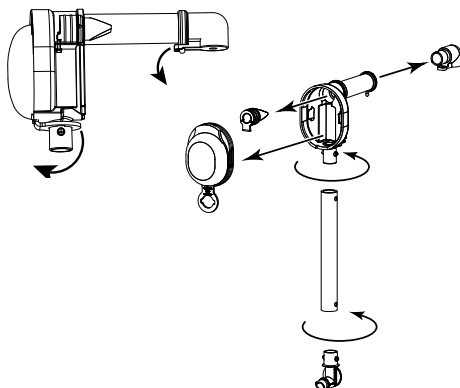

# CLEANING

1

## FLUSH & RINSE

all pump surfaces with hot water. Place lower end of pump into container of hot water and operate pump until all remaining product is expelled and only hot water is discharged.

2

## DISASSEMBLE & CLEAN

all washable parts with soap and hot water. Use brush to clean any confined areas.

3

## RINSE

fully with clear water.

4

## SANITIZE

all parts according to local sanitization requirements. All parts in contact with food must be sanitized.

5

## AIR DRY

all parts fully.



## YES!

Use dishwashing soap, hot water and nylon brush

- Dishwasher safe
- Do not use abrasive, caustic or ammonia based cleansers.
- Do not use cleansing agents with high concentrations of acid, alkaline or chlorine.
- Do not use metal scrapers or cleaning pads that could scratch surfaces.

# TROUBLESHOOTING

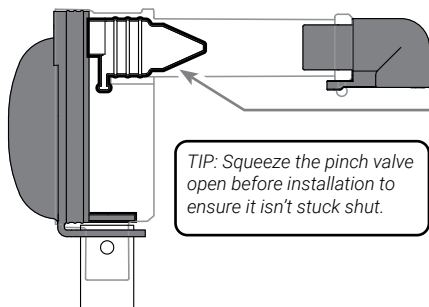

## DIFFICULT TO ATTACH PARTS?

- Wet parts with clean water to help fit.

## PRODUCT DOESN'T PUMP?

- Ensure pinch valve is inserted in housing.
- Ensure connector is snapped fully in place to fitment in pouch.
- Ensure pump is properly installed in unit.
- Clean pump thoroughly.

## DOMES POPS OFF?

- Clean thoroughly. Food residue could prevent a tight seal between dome and housing.
- Ensure dome edges are flush with housing.

# PUMP COMPONENT PART NUMBERS

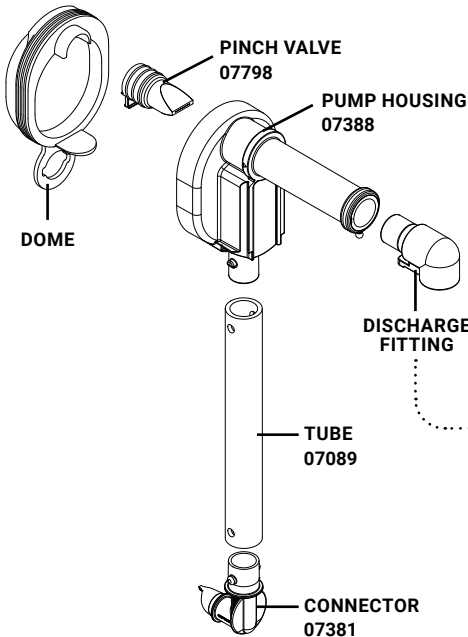

PART	QTY	DESCRIPTION
07798	1	LARGE PINCH VALVE
07388	1	PUMP HOUSING
07089	1	7" TUBE
07381	1	CONNECTOR, 16MM

## DOME FOR MODELS 07392, 07398

07383	1	PUMP DOME, BLACK
-------	---	------------------

PUMP MODEL	INCLUDED DISCHARGE FITTING(S)
07392	MEDIUM & LARGE FITTINGS
07398	MEDIUM FITTING

## DISCHARGE FITTINGS (VARIOUS SIZES)

07795	DISCHARGE FITTING, .156, SMALL
07796	DISCHARGE FITTING, .256, MEDIUM
07797	DISCHARGE FITTING, .394, LARGE

## SERVER PRODUCTS LIMITED WARRANTY

**2** YEAR  
WARRANTY

This Server product is backed by a two-year limited warranty against defects in materials and workmanship. See [Server-Products.com](https://www.server-products.com) for details.

## GENERAL SERVICE, REPAIR OR RETURNS

Before sending an item to Server Products, contact Customer Care to request a **Return Authorization Number**. The RA Number ensures proper processing and a prompt turnaround. Repaired units are typically shipped out within 48 hours of receipt.

Merchandise returned for credit will incur a 20% restocking charge, must be less than 90 days old, and in unused (new) condition. Electrical parts (thermostats, heating elements, etc.) are not returnable.

## NEED HELP?

**Server Products Inc.**  
3601 Pleasant Hill Road  
Richfield, WI 53076 USA

**Chat with us!**  
[spsales@server-products.com](mailto:spsales@server-products.com)  
**262.628.5600 | 800.558.8722**

Please be prepared with the **Part Numbers** for your items. Individual part numbers are listed above.

**SERVER**  
INTELLIGENT BY DESIGN™