

# Wooden Waste Enclosure

## ASSEMBLY INSTRUCTIONS



**LANCASTER™**  
TABLE & SEATING

**REQUIRED TOOLS:** • Screwdriver

### CONTENTS:

**A** Back Board 1/PC

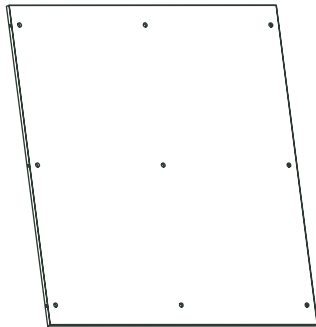

**B** Middle Board 1/PC

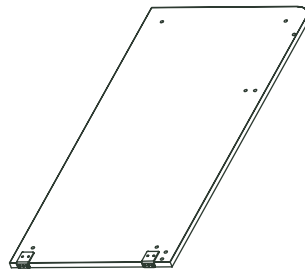

**C** Left Sideboard 1/PC

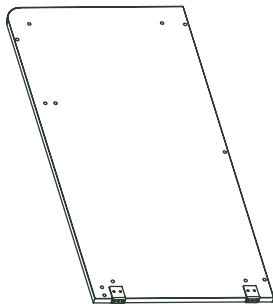

**D** Right Sideboard 1/PC

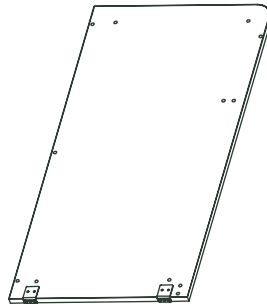

**E** Push Door 1/PC



**F** Front Board 2/PC



**G** Support Panel 2/PC



**H** Top Panel 2/PC

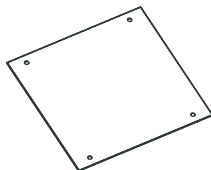

**I** Bottom Panel 2/PC

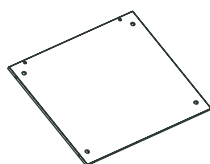

**J** Left Door 1/PC



**K** Right Door 1/PC

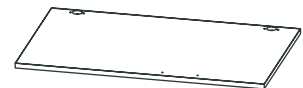

### HARDWARE:

**L** Cam Lock Screw 49/PCS



**M** Cam Lock 49/PCS



**N** Short Screws 24/PCS



**O** Door Hinge 4/PCS

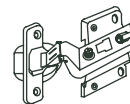

**P** Glide Feet 6/PCS



# Wooden Waste Enclosure

## ASSEMBLY INSTRUCTIONS



**LANCASTER™**  
TABLE & SEATING

### STEP 1

Lay the middle board, the left and right side boards, the back board, and the two bottom boards on a flat surface with the pre-drilled holes facing up. Insert cam lock screws into all pre-drilled holes of the boards. Using a Phillips head screwdriver, tighten each screw by turning clockwise.

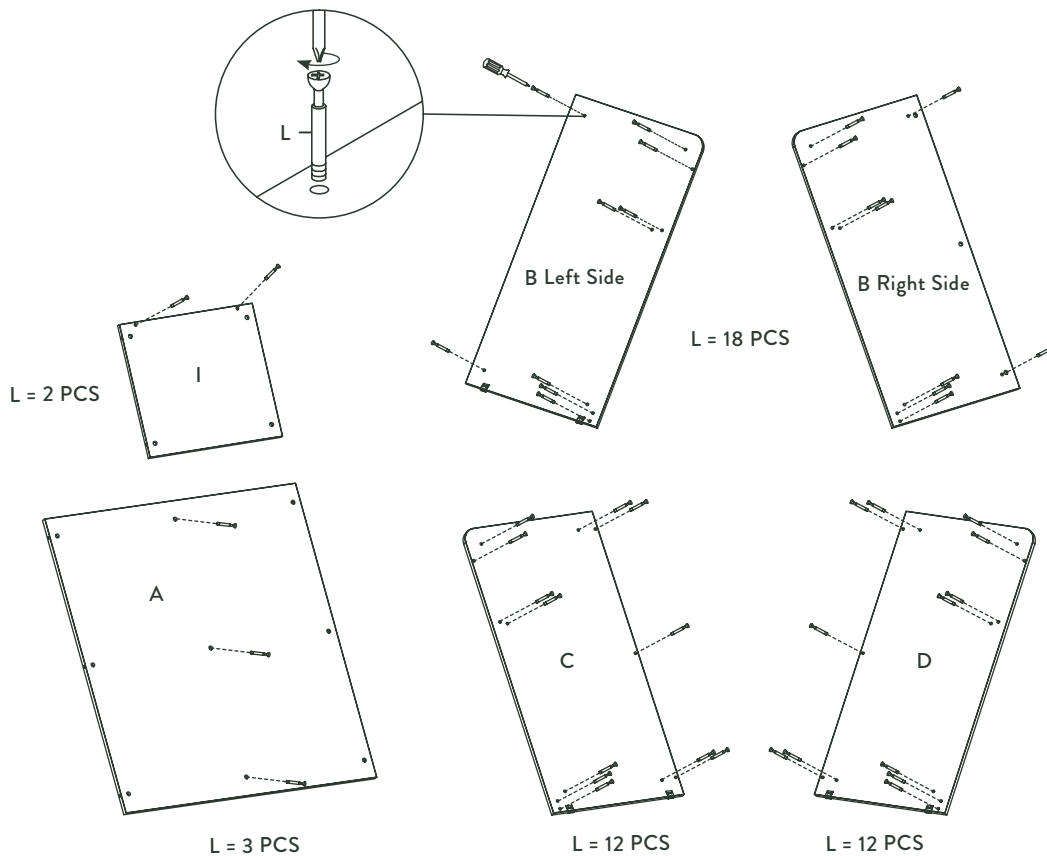

### STEP 2

Locate the (6) glide feet. Insert one glide foot into each of the (2) mounting bracket plates on the bottoms of the left side board, right side board, and middle board. Hand tighten the feet by turning clockwise until firmly inserted.

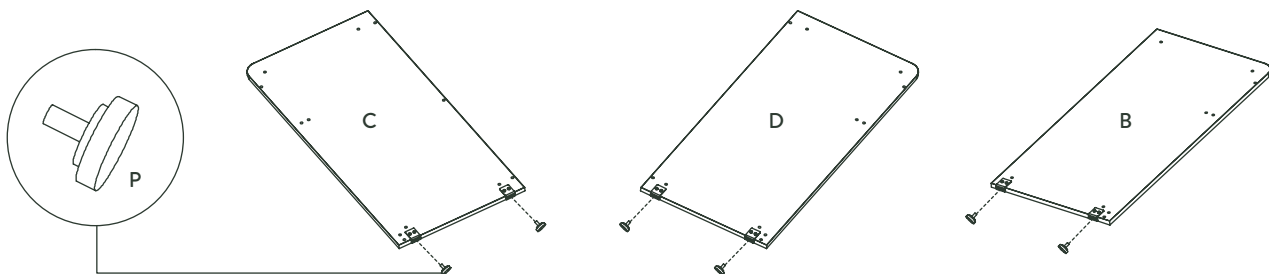

# Wooden Waste Enclosure

## ASSEMBLY INSTRUCTIONS



**LANCASTER™**  
TABLE & SEATING

### STEP 3

With the back board lying on a flat surface, carefully line up the (3) pre-drilled holes on the back of the middle board with the (3) cam lock screws sticking up from the back board. Before lowering the middle board onto the back board, insert a cam lock into each of the (3) holes on the middle board. Connect the two boards, and then use a screwdriver to tighten each cam lock screw so that the two pieces are firmly connected.

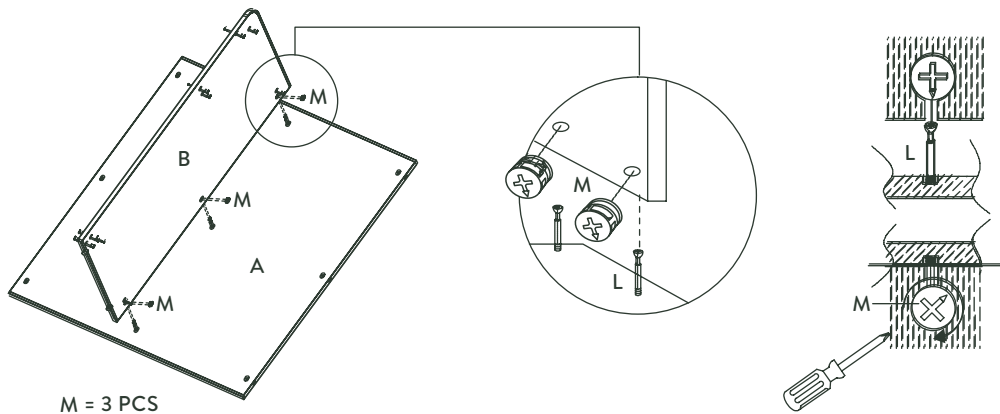

### STEP 4

Insert (2) cam locks into the first top board as shown, connecting the top board to the middle board by lining up the cam locks with the exposed cam lock screws and using a screwdriver to tighten. Repeat this step with the remaining top board.

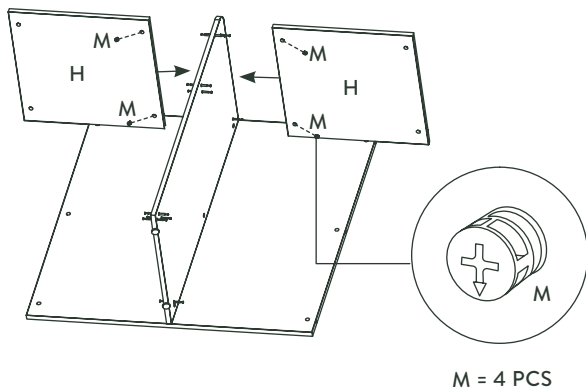

### STEP 5

Connect the (2) push doors to the middle board as shown.

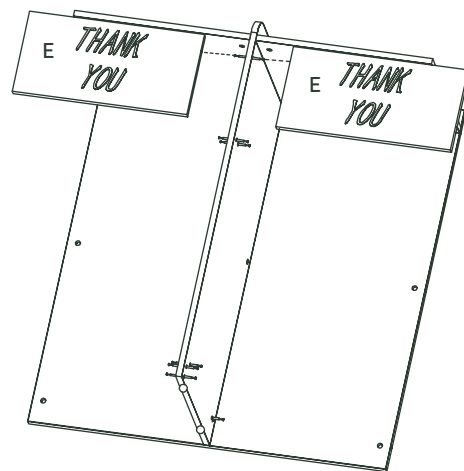

# Wooden Waste Enclosure

## ASSEMBLY INSTRUCTIONS



**LANCASTER™**  
TABLE & SEATING

### STEP 6

Using (2) cam locks each, connect the two support panels to the middle board. Use a screwdriver to join the pieces firmly together.

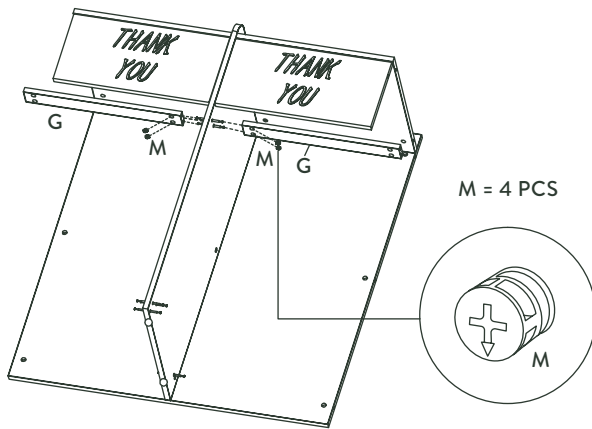

### STEP 7

Using 2 cam locks, connect one of the front boards to the bottom board, using a screwdriver to tighten. Repeat this process with the remaining front board.

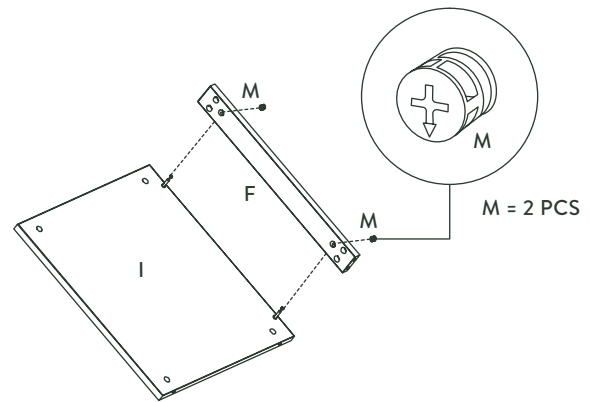

### STEP 8

Using (4) cam locks each, connect the two bottom boards to the middle board, using a screwdriver to tighten.

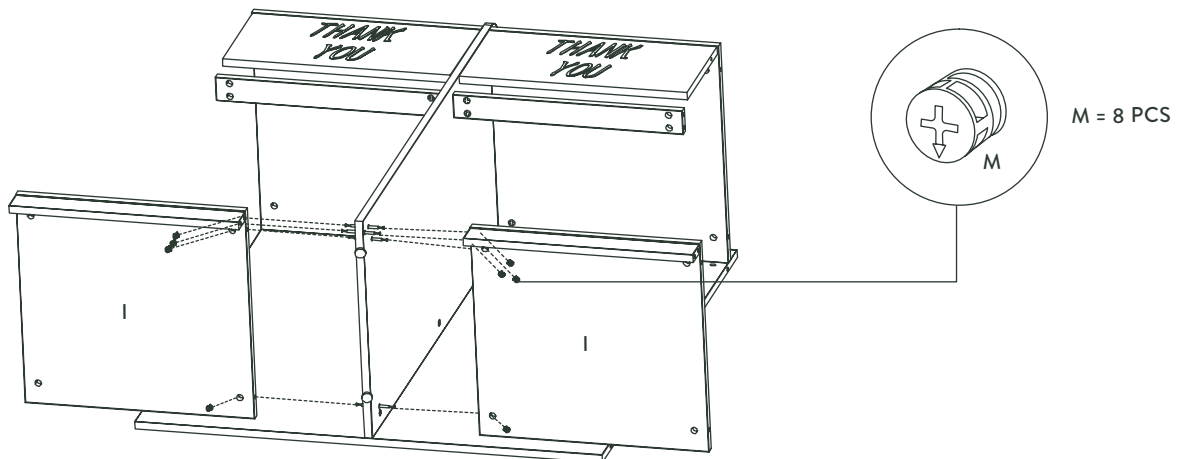

# Wooden Waste Enclosure

## ASSEMBLY INSTRUCTIONS



**LANCASTER™**  
TABLE & SEATING

### STEP 9

Turn the frame right side up so the bottom is sitting on the floor. Using (12) cam locks each, connect the left and right side boards with the assembled frame. Use a screwdriver to connect the cam locks to the cam lock screws.

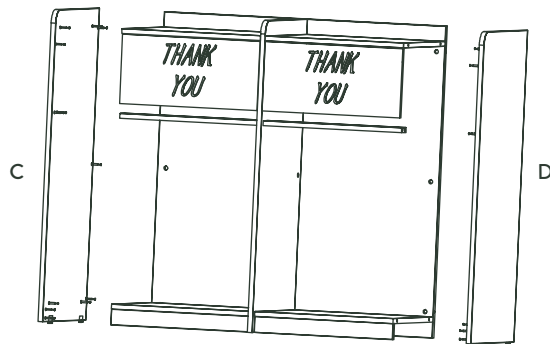

M = 24 PCS

### STEP 10

Locate the (4) door hinges and line up the first door hinge with the pre-drilled holes on the left door. Place (2) short screws into the holes, connecting the hinge to the door. Use a screwdriver to tighten. Repeat this step with the remaining (3) door hinges on the left and right doors.

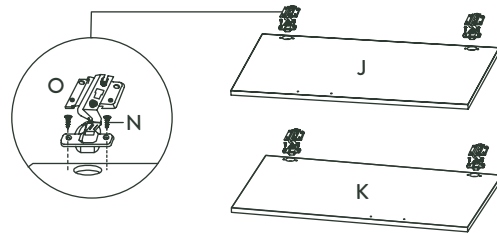

### STEP 11

Hold up the left door to the enclosure frame, carefully lining up the two door hinges with the pre-drilled holes in the left side board. Insert (4) short screws into each of the two hinges and through the side board. Tighten using a screwdriver until the door is firmly connected to the frame. Once the door is able to shut and open satisfactorily, repeat this step with the right door.

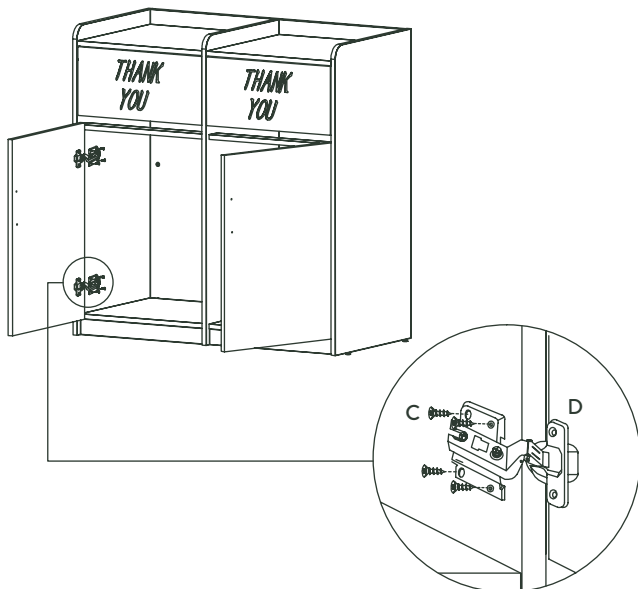

### STEP 12

Ensure all screws are tightened completely. You now have a fully assembled Lancaster Table & Seating double waste enclosure!

