



CLIMB ON

WHEEL REPLACEMENT

READ THESE INSTRUCTIONS COMPLETELY BEFORE YOU START. IF YOU DON'T UNDERSTAND THESE INSTRUCTIONS, PLEASE CALL 800-453-1192 FOR ASSISTANCE.

Procedure for replacing the wheels on Little Giant Ladder Systems **CAGE®** and **Compact Safety CAGE®** elevated enclosed platforms.

1. Failure to comply with all instructions may result in serious injury.
2. Make sure this kit is compatible with your model. Before installing this kit, identify all kit components. If any components are missing, damaged or if you have any questions concerning the use of this kit on Little Giant Ladder Systems products, please contact our Customer Experience Team at 800-453-1192. Do not substitute any components.
3. Inspect the CAGE elevated enclosed platform before installing this kit. Repair or replace any damaged or missing parts before using. Use only Little Giant Ladder Systems repair or replacement parts. If you are unable to repair it, discard the CAGE elevated enclosed platform.

COMPONENTS IN KIT



(2) WHEELS

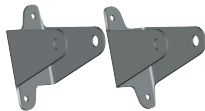

(1) LH/FRONT BRACKET
(1) RH/REAR BRACKET



(2) HEX HEAD BOLTS



(2) CENTER LOCK NUTS



(4) SOCKET CAP SCREWS



(4) WASHERS
(Only used on side tip wheels)



(4) NYLON LOCK NUTS

TOOLS NEEDED

(2) 9/16" WRENCHES



3/8" WRENCH



1/8" ALLEN WRENCH



TAPE



NOTE: IF ANY OTHER PART OF THE CAGE IS DAMAGED BEFORE OR DURING THE PROCESS OF INSTALLING AND/OR REPAIRING, PLEASE CONTACT OUR CUSTOMER EXPERIENCE TEAM FOR ASSISTANCE AT 800-453-1192. **DO NOT USE A DAMAGED CAGE ELEVATED ENCLOSED PLATFORM!**



TIP & GLIDE™ WHEEL REPLACEMENT (SKIP TO PAGE THREE FOR SIDE TIP WHEELS)

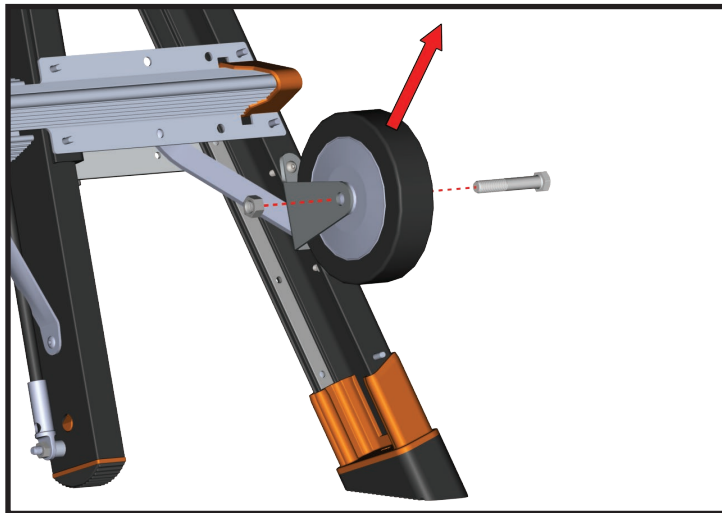

1. Using (2) 9/16" wrenches loosen and discard the wheel, bolt, and lock nut.

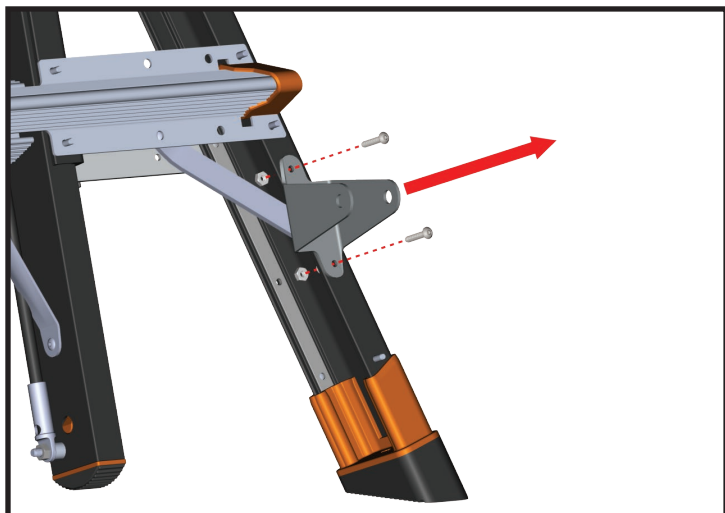

2. Using a 1/8" allen wrench and 3/8" wrench remove and discard the bracket, screws and lock nuts.

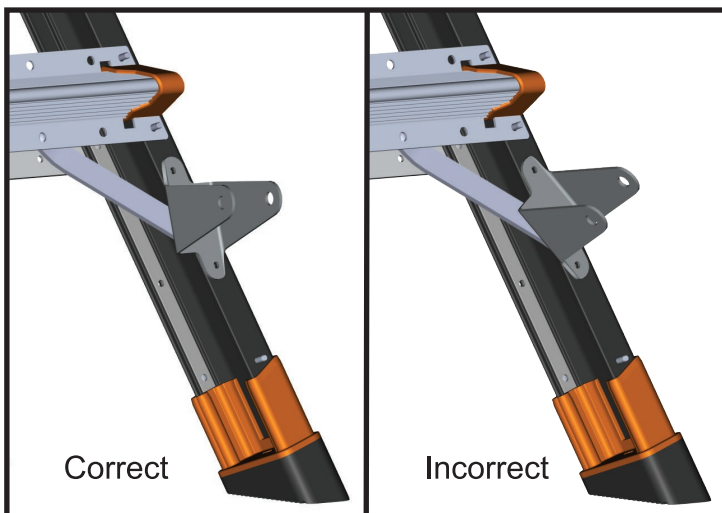

3. Determine correct bracket for left and right. Sides of bracket should be perpendicular to bottom rung.

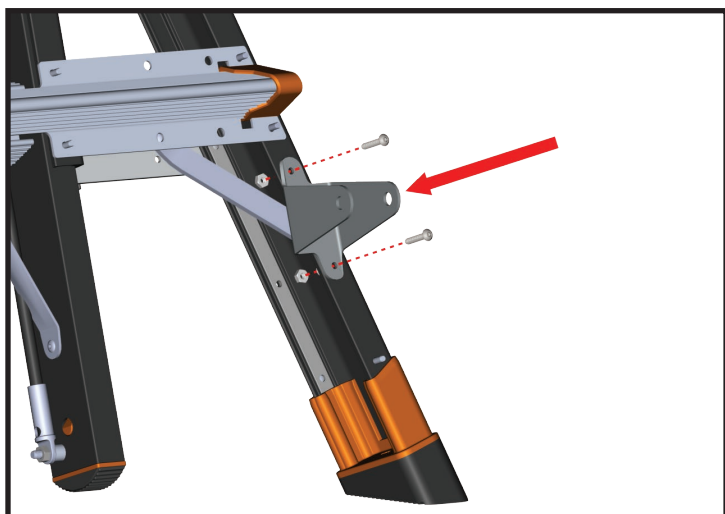

4. Line up the new bracket, then attach and tighten the new hardware as shown with a 1/8" allen wrench and 3/8" wrench.

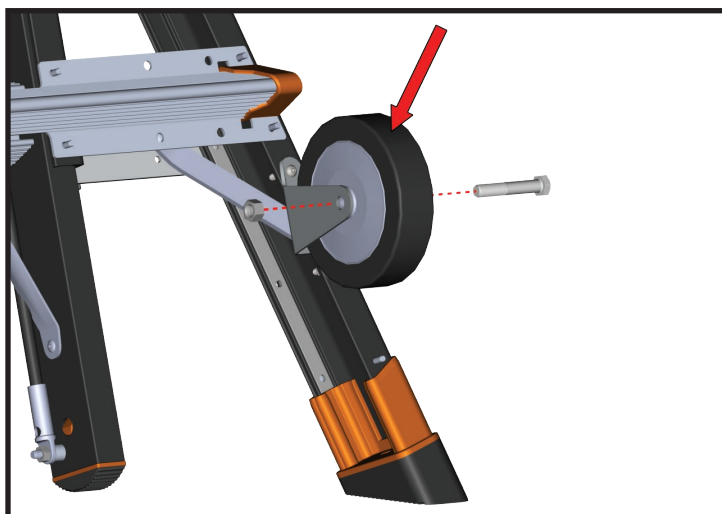

5. Align new wheel with bracket, then using (2) 9/16" wrenches, tighten the nut and bolt.

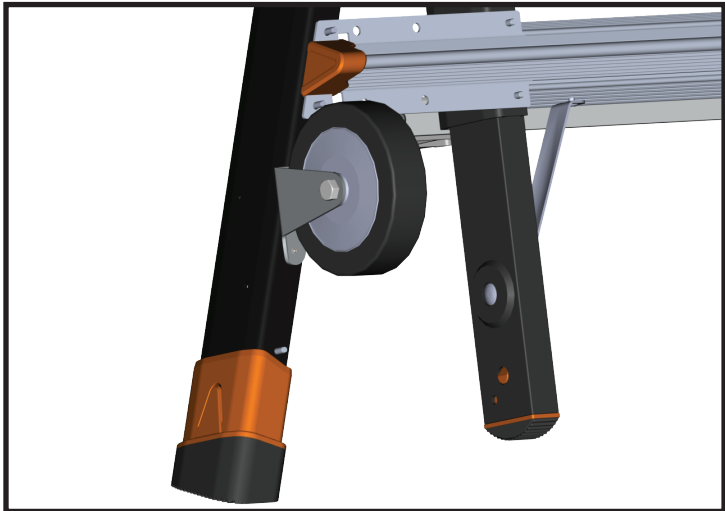

6. Repeat process for other wheel.



7. Make sure both wheels are tightly secured before use.



SIDE TIP WHEEL INSTALLATION OR REPLACEMENT

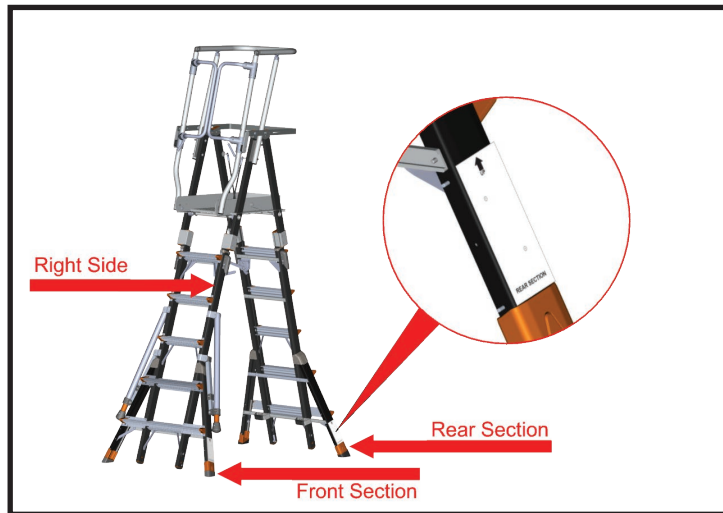

1A. (If adding side tip wheels) Cut out the templates on page 6. Align bottom of templates with top of foot as shown, then tape in place on the right side of elevated enclosed platform.

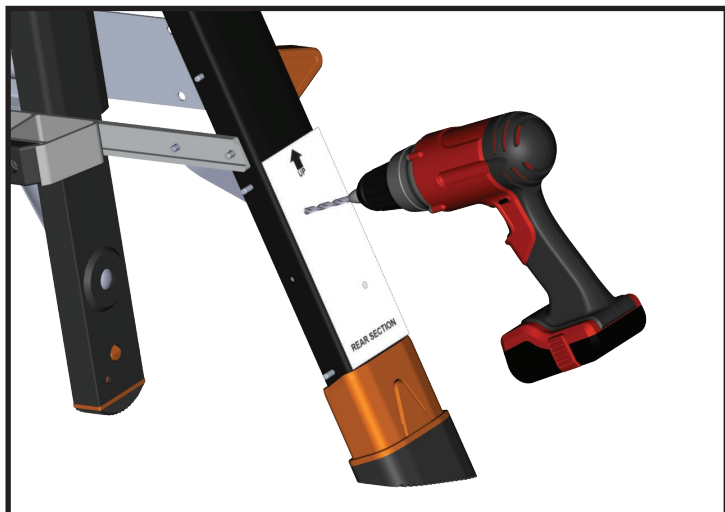

2A. Using a drill and 13/64" bit, drill the holes indicated on the templates. **Continue to step 3.**

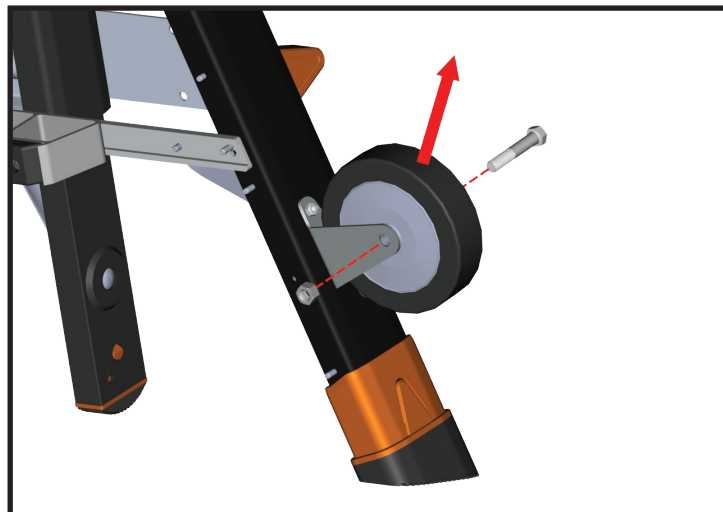

1B. (If replacing side tip wheels) Using (2) 9/16" wrenches loosen and discard the wheel, bolt, and lock nut.

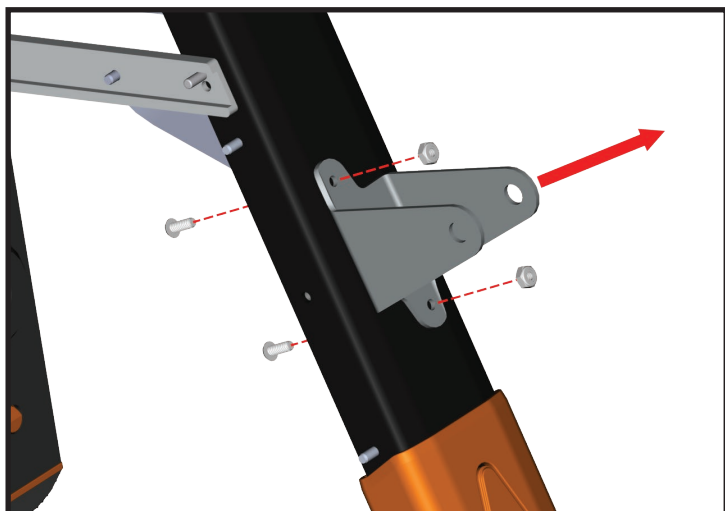

2B. Using a 1/8" allen wrench and 3/8" wrench remove and discard the bracket, screws, and lock nuts.

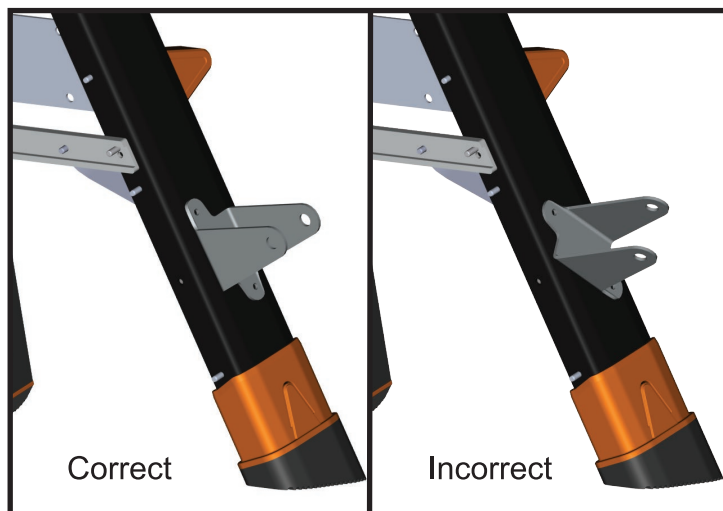

3. Determine correct bracket for front and back. Sides of bracket should be parallel with fiberglass rail.

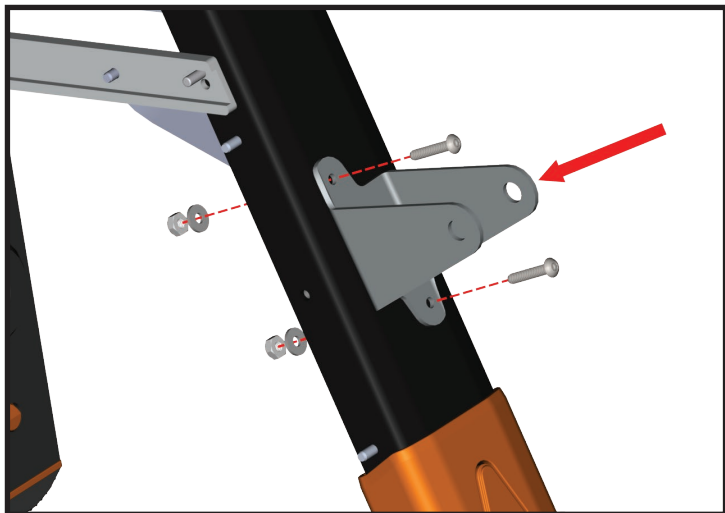

4. Line up the new bracket, then attach and tighten the new hardware as shown with a 1/8" allen wrench and 3/8" wrench.

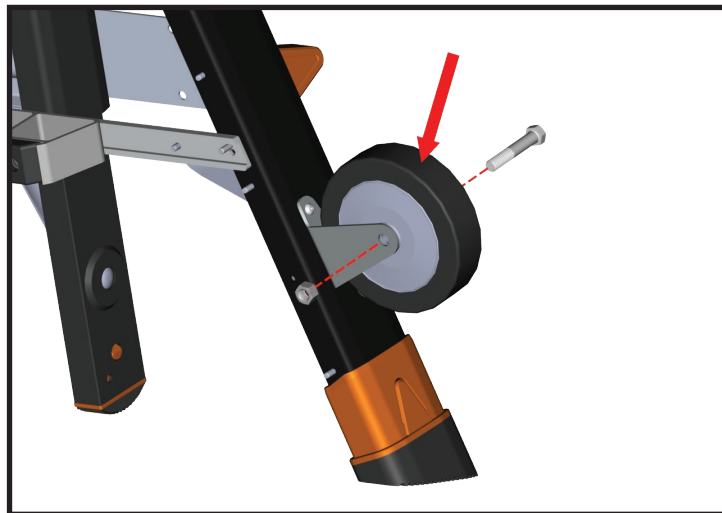

5. Align new wheel with bracket, then using (2) 9/16" wrenches, tighten the nut and bolt.

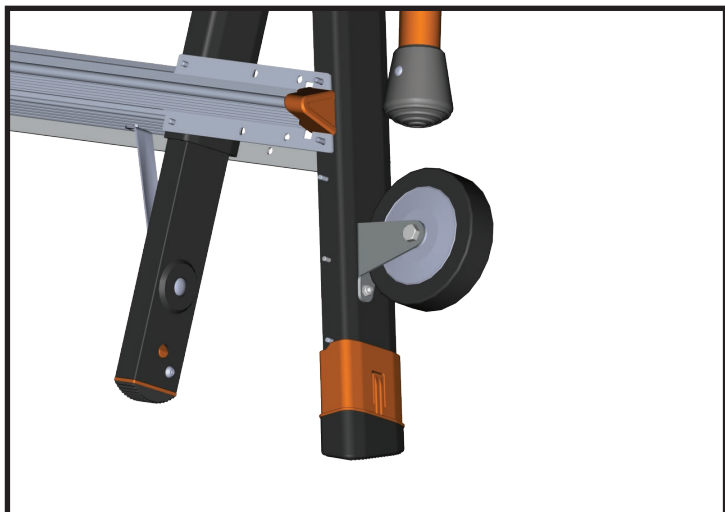

6. Repeat steps 1-5 for other wheel.



7. Make sure both wheels are tightly secured before use.

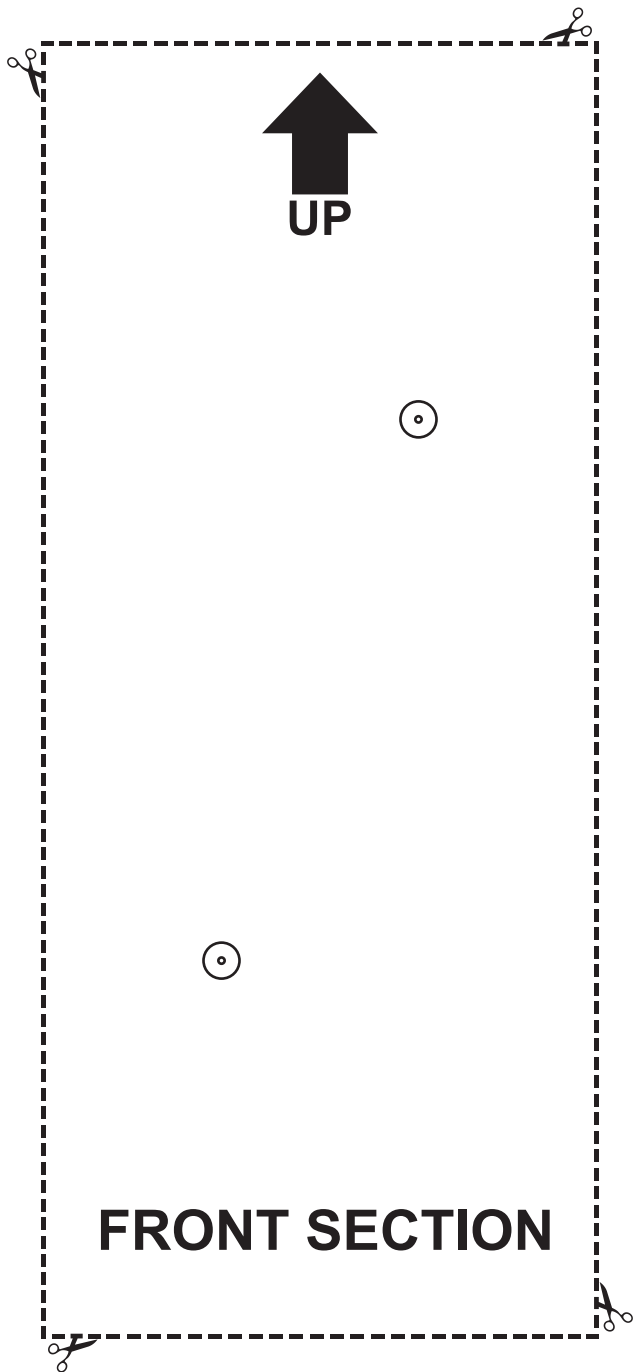

FRONT SECTION

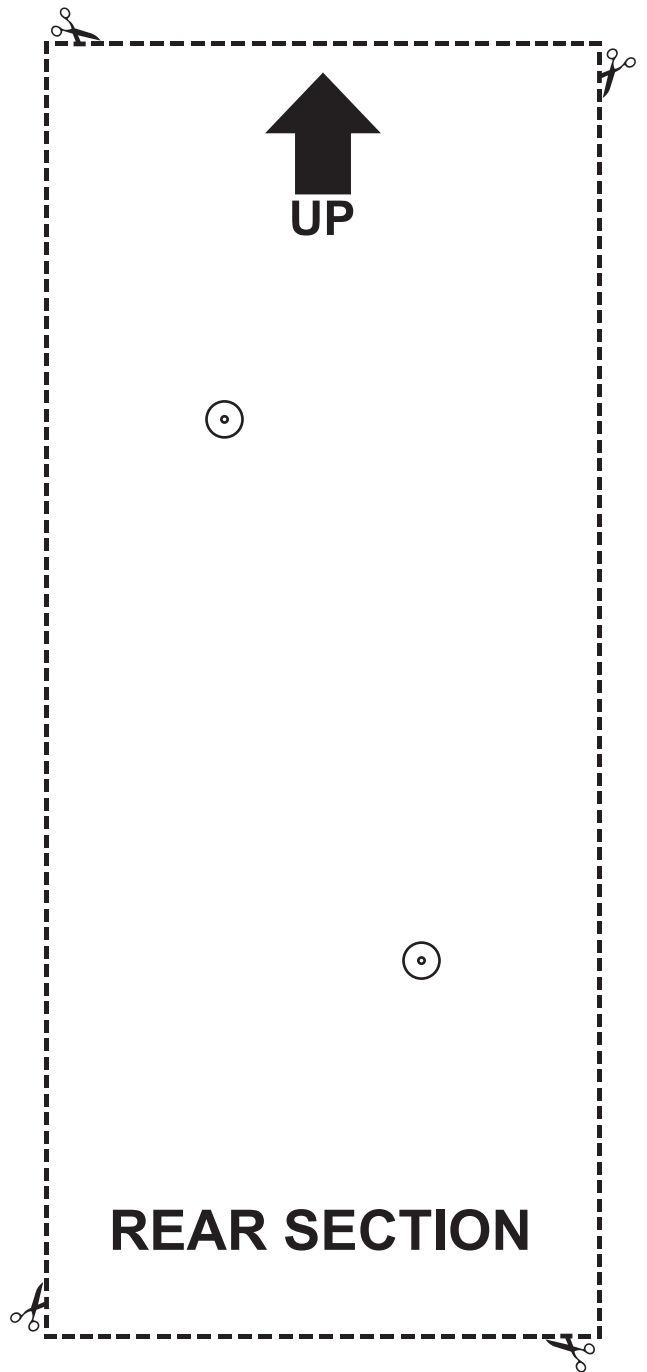

REAR SECTION

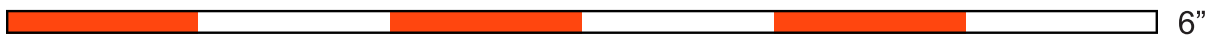

MEASURE TO CONFIRM TEMPLATES ARE PRINTED TO SCALE