



Stainless Steel Mobile Mixing Bowl Cart

ASSEMBLY INSTRUCTIONS

PARTS LIST

- A - Left Post (x2)
- B - Right Post (x2)
- C - Crosspiece (x2)
- D - Top (x2)
- E - Shelf (x2)
- F - Swivel Caster w/brake (x2)
- G - Swivel Caster w/o brake (x2)
- H - 1/4-20x5/8 Screw (x12)

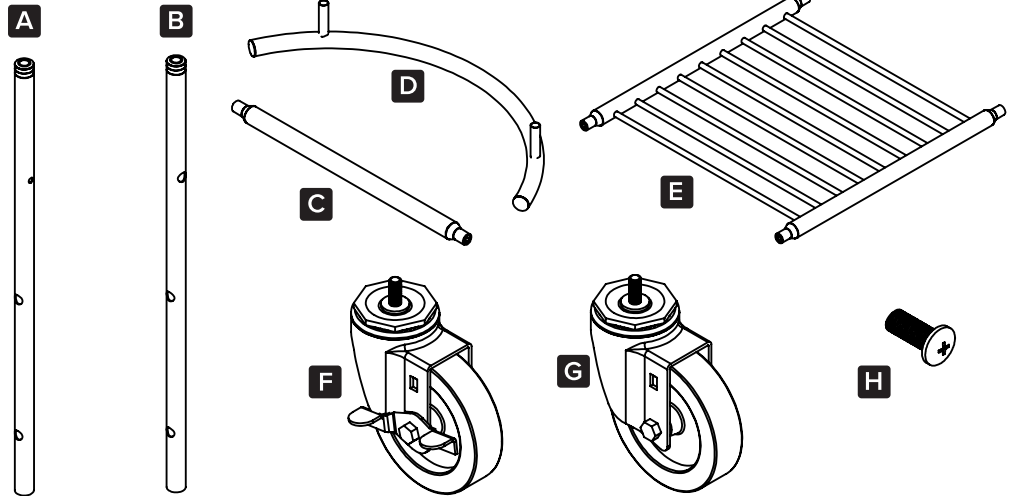

STEP 1

Insert the **Crosspiece (C)** into the posts, connecting **Left Post (A)** to **Right Post (B)**, using **1/4-20x5/8 Screws (H)**. Keep the screws slightly loose. Repeat for second side.

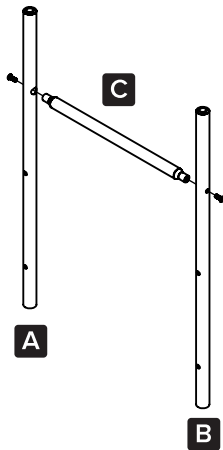

STEP 2

Insert one **Shelf (E)** into the post frames from Step 1, using **1/4-20x5/8 Screws (H)**. Repeat with the second shelf, keeping the screws slightly loose.

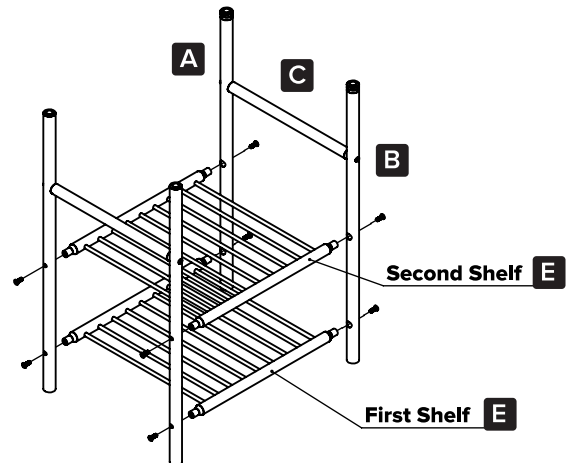

STEP 3

Insert the **Top Pieces (D)** into the posts. Tighten all screws from Steps 1-3.

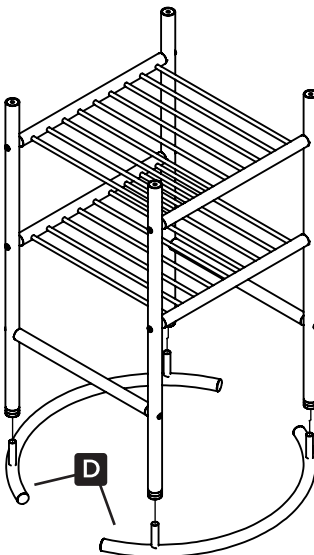

STEP 4

Attach the **Casters w/ Brake (F)** and **Casters w/o Brake (G)** to the bottom of Posts and tighten with a wrench. Flip the cart onto the casters to complete assembly.

