

HLPLPSBBF, HLPLPSFF & HLPLPHBF

Technical Specifications

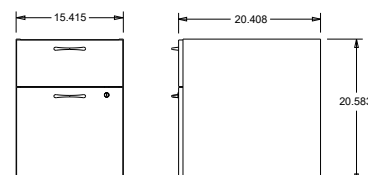
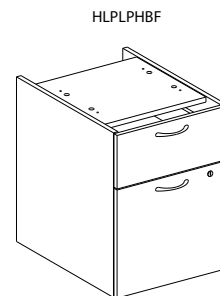
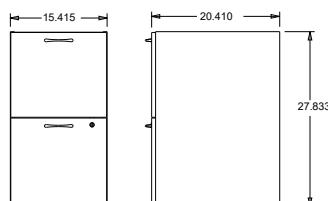
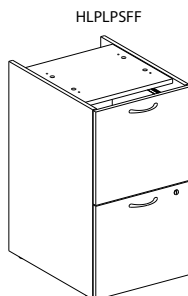
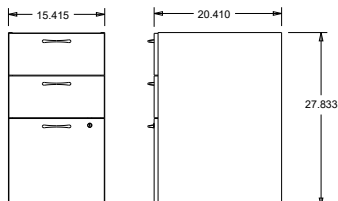
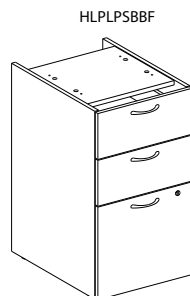

Construction:

- Chassis: 5/8" thick particleboard with double sided melamine surfaces, 0.6mm edgebanding

Features:

- Metal to Metal European style fasteners
- 3/4" adjustable glides
- Lock location is always right hand side
- Full Extension telescoping ball bearing drawer slides
- Side to side letter width filing and front to back legal width filing
- HLMBBF - Locking bottom box and file drawers. Top box drawer does not lock.
- HLMFF - (2) Locking file drawers
- HLMBF - Locking box and file drawers
- Customer can order different handle packs (HBLPCONTEMP, HBLPBRIDGE, HBLPCCLASSIC)

Drawer Construction:

- Fronts: 5/8" thick drawer front with double sided melamine surfaces, 0.6mm edgebanding
- Body: 1/2" particleboard vinyl wrapped with black print, file body has hangrail built into top of drawer body. Drawer body has glue placed in miter-joints and drawer bottom groove, then folded into shape and squared. Body is fastened to front with screws.
- Bottom: 3/16" thick black printed MDF

Shipping Information:

- Units ship fully assembled, with the exception of the glides and pulls

QUICK REFERENCE TABLE

Model	Nominal Dimensions	Actual Dimensions
HLPLPSBBF	15"W x 20"D x 28"H	15.42"W x 20.41"D x 27.83"H
HLPLPSFF	15"W x 20"D x 28"H	15.42"W x 20.41"D x 27.83"H
HLPLPHBF	15"W x 20"D x 20"H	15.42"W x 20.41"D x 20.58"H

QUICK REFERENCE TABLE - SHIPPING

Model	Description	Cubes	Ship Weight
HLPLPSBBF	15"W x 20"D x 28"H B/B/F Support Pedestal	7.4	80.5 lbs.
HLPLPSFF	15"W x 20"D x 28"H F/F Support Pedestal	7.4	78.9 lbs.
HLPLPHBF	15"W x 20"D x 20"H B/F Hanging Pedestal	5.8	63.3 lbs.

The HON Company
200 Oak Street
Muscatine, IA 52761
800-833-3964
hon.com

© 2020 The HON Company
HON is a registered trademark
of HNI Technologies, under
license to The HON Company