

EP-6485-24

Bi-Support Stand w/ Automatic Sheet Cutter - 24"

assembly, loading, & usage instructions

IT IS THE RESPONSIBILITY OF THE CUSTOMER TO ENSURE THAT
ALL OPERATORS AND SERVICE PERSONNEL HAVE FULLY READ
AND UNDERSTOOD THIS DOCUMENT

**READ ALL INSTRUCTIONS BEFORE OPERATING TOOLS.
FAILURE TO FOLLOW ANY OF THESE GUIDELINES COULD
RESULT IN SERIOUS OR FATAL INJURY**



P (847) 735-8105 | F (847) 735-8297
sales@encorepack.com | www.encorepack.com



201 Park Avenue, Lake Villa, IL 60046
P.O. Box 595, Winnetka, IL 60093



IMPORTANT



PLEASE READ PRIOR TO ASSEMBLY, LOADING & USAGE

To ensure operator safety, it is important that all personnel use proper safety and handling procedures. This safety booklet is designed to educate operators on the safe assembly & use of the EP-6485 Bi-Support Stand w/ Automatic Sheet Cutter. All personnel must read and understand this booklet prior to using this product. Failure to follow any of the recommendations in this pamphlet can result in serious injury or death.

READ PRODUCT SAFETY LABELS

- Read and understand all safety labels on the tool
- Replace all damaged or missing labels

INSPECT THE TOOL DAILY AND REPLACE ALL WORN OR BROKEN PARTS. LUBRICATE ALL MOVING PARTS DAILY.

PRESS THE EMERGENCY STOP BUTTON FOR IMMEDIATE STOPPAGE OF MACHINE. FOLLOW THE ARROWS ON THE BUTTON TO TWIST IN ORDER TO DISENGAGE THE ESTOP.

CAUTION: LOCK OUT POWER BEFORE INSPECTION OR USE



REMOVE BATTERY
when tool is not in use



WARNING
Shear hazard.
Moving parts can cause
severe injury.
Lock out power before
inspection or use.



KEEP HANDS CLEAR OF MOVING PARTS AND SHARP EDGES. THE MACHINE CONTAINS A SHARP MOVING BLADE. LOCK OUT POWER PRIOR TO SERVICING BLADE.

READ THE INSTRUCTIONS

Before operating this tool, read, and understand all safety, operation, and maintenance information provided in the manual which is packaged with the tool. If you do not have a manual or need extra copies, please contact your Sales Representative.

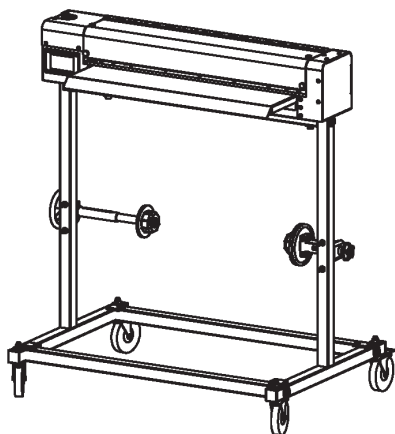

Terms & Conditions are found on our website: <https://www.encorepack.com/legal.php>

Please read our Terms & Conditions carefully prior to using or obtaining any materials, information products or services of **Encore Packaging LLC**, an Illinois limited liability company with a place of business at **201 Park Avenue, Lake Villa, IL 60046**.

P (847) 735-8105 | F (847) 735-8297



201 Park Avenue, Lake Villa, IL 60046
P.O. Box 595, Winnetka, IL 60093

ASSEMBLY INSTRUCTIONS

Step 1

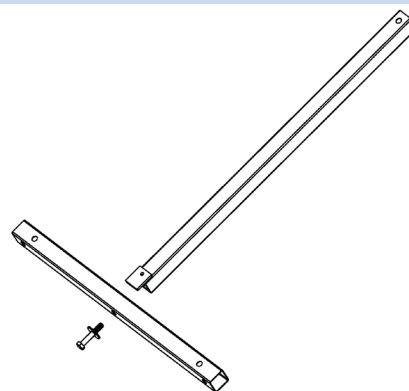

1. Begin by attaching the frame vertical weldments (#2) to the frame bases (#1). Utilizing the provided flat washers (#5), and cap screws (#6) screw in the vertical weldment to the base. The support plate at the end of the vertical weldment should be facing up against the frame base.

Step 2

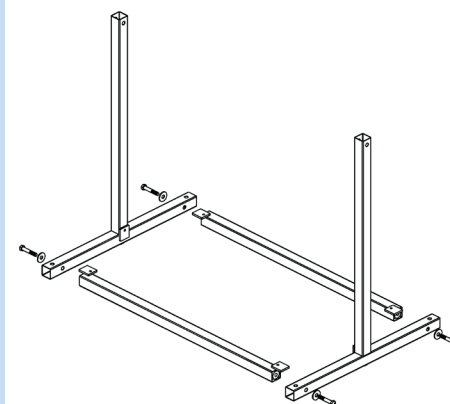

2. Now that the side frames are assembled, attach them by screwing in the two frame support weldments (#3) utilizing the flat washers, and cap screws provided. When attached, the plates on the two frame supports should be facing up and on the inside of the base.

Step 3

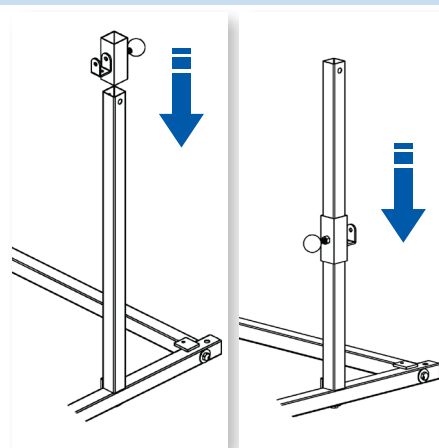

3. Slide one load support (#12) on each vertical side. Lock them in by screwing the knob in, when positioned at half the length of the tube. When assembled, the load supports can be adjusted to accommodate the roll.

Step 4

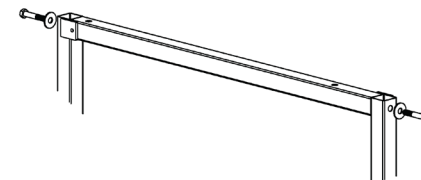

4. Attach the top support weldment (#3), with the flat washers and screws that are included. The plates should be parallel to the side of the vertical tubes when attached.

Step 5

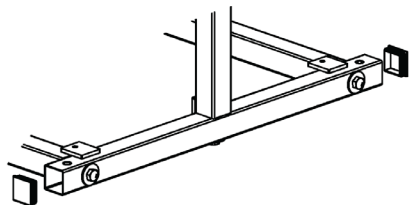

5. Cover the open ends of the bottom side tubes with the provided square tube plugs (#7).

Step 6

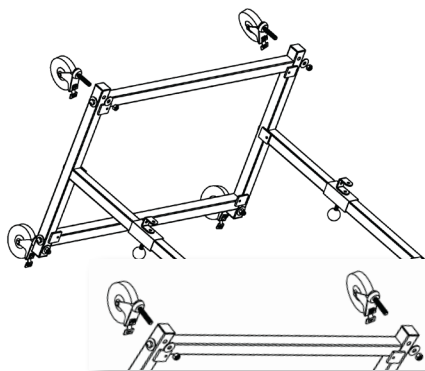

6. Carefully put the stand on its side so that the top support is touching the ground. Proceed to screw in the 5" casters (#9) to the bottom of the side frames by using the flat washers, and nylon nuts (#10). When attached, carefully, turn the stand back to its proper stance with the casters on the ground.

Step 7

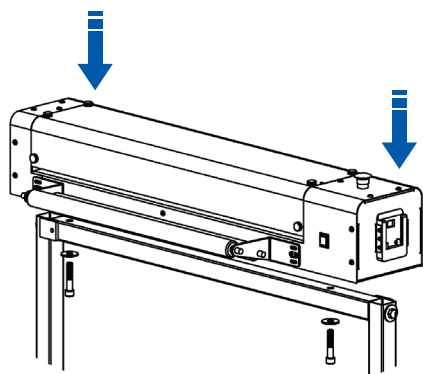

7. With caution, position the automatic sheet cutter (#14) on the top support of the base. Attach the automatic sheet cutter by screwing in the two bolts (#8) and flat washers from the bottom of the top tube to the sheet cutter.

Step 8

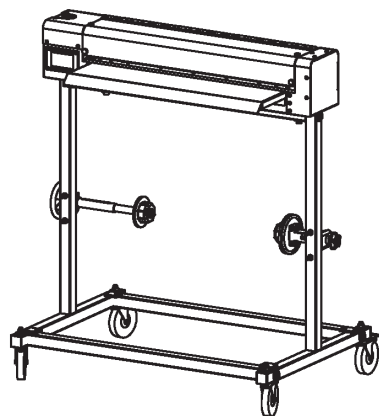

8. EP-6485 is now assembled and ready for use.

This page have been intentionally left blank

MATERIAL LOADING INSTRUCTIONS

Steps 1 - 5

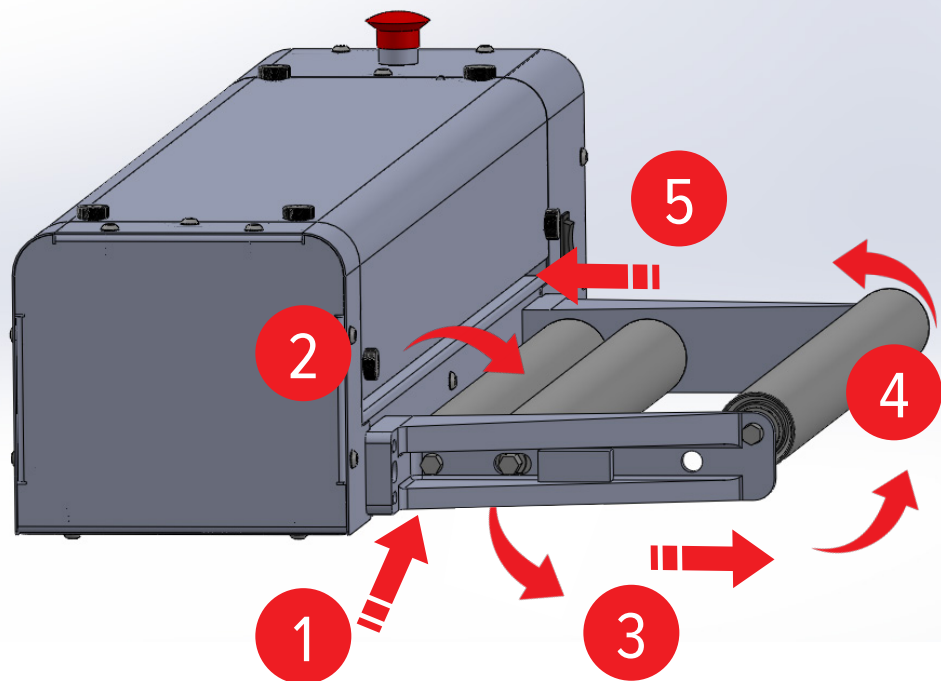

1. Pull the material from the bottom and up through the first roller.
2. Feed the material around the first roller and back down.
3. Pull the material through the bottom and come around the last roller.
4. Feed the material around the last roller and back towards the unit.
5. Finally, feed the material into the unit through the feeder.

Step 6

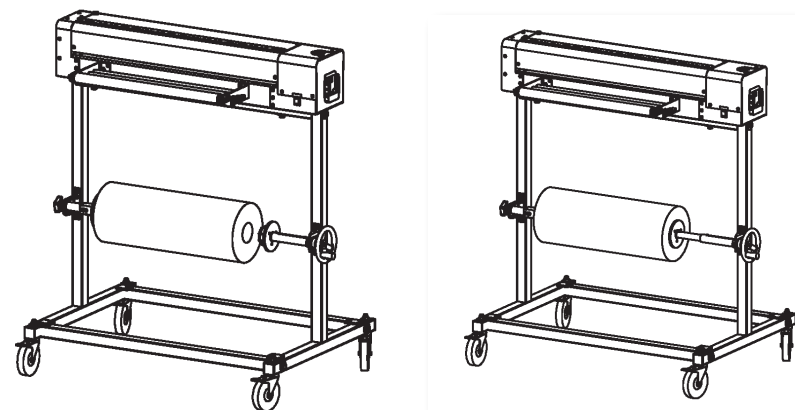

6. Insert one side of the roll onto the core of the Loading Side Brake (#5) and turn the wheel clockwise to extend the arm of the brake to insert into the other the core of the Tension Side Brake (#2).

Step 7

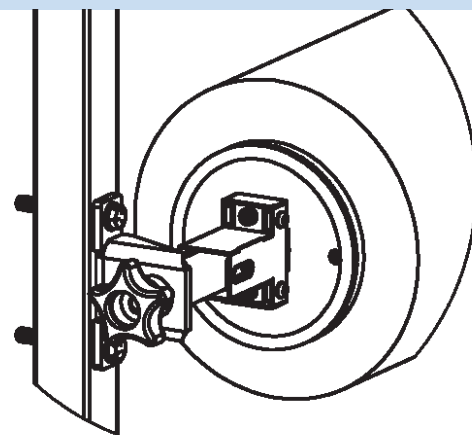

7. Adjust the tension on the roll using the knob on the Tension Side Brake (#2) as needed, turning right to increase tension and left to decrease.

USAGE INSTRUCTIONS

Step 1

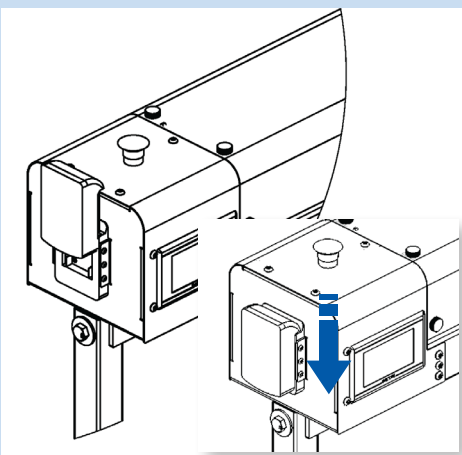

1. Turn on by inserting a fully charged 18-volt battery, and twisting the emergency stop button.

Step 2

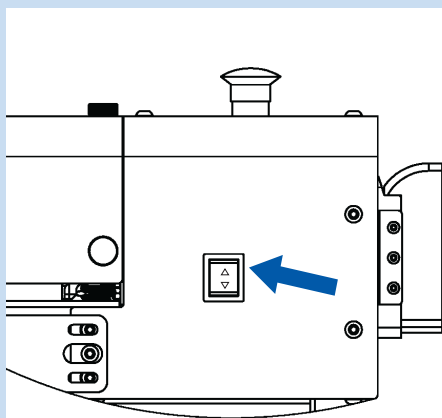

2. Flip the back switch, which raises the inner rollers and is located to the right of the outside rollers.

Step 5

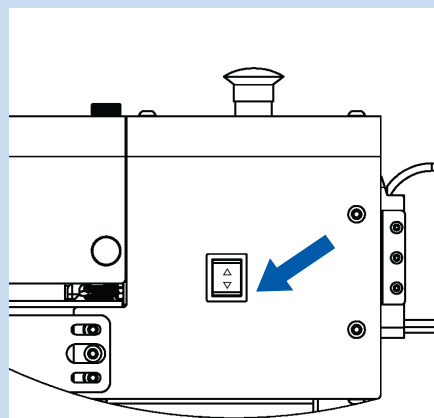

5. When the material is in place, flip the switch back to lower the inside rollers. Let go of the material once the rollers are in place.

Step 6

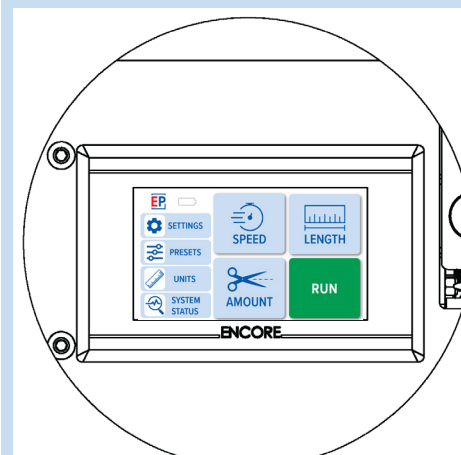

6. Proceed to utilizing the touchscreen to designate the desired unit, speed, length, and number of cuts. Once that information has been set, press Run. Material will now be pulled and cut to the designated settings.

Step 3

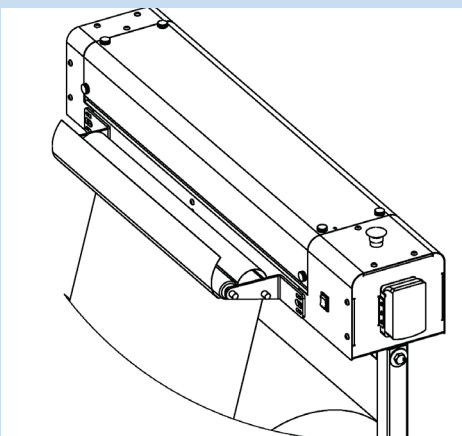

3. Pull the material directly up behind the back roller. Proceed to pull it towards you as you guide it underneath and around the outside roller.

Step 4

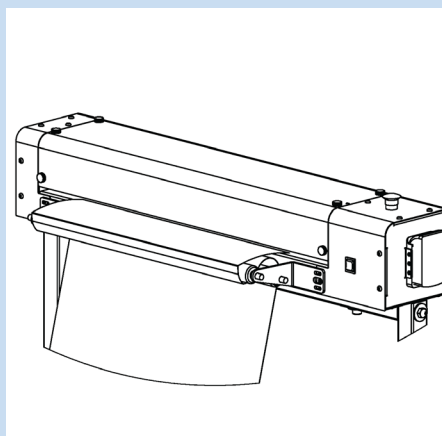

4. Once it is over the outside roller, pull and insert the material into the cutter.

READ THE INSTRUCTIONS

Before operating this tool, read, and understand all safety, operation, and maintenance information provided in the manual which is packaged with the tool. If you do not have a manual or need extra copies, please contact your Sales Representative.

There are 3 different error screens that you can get in the EP-6485. There is a low battery error screen, a limit switch error screen, and a motor jam error screen. Let's go through each of them individually to resolve them.

1. LOW BATTERY ERROR

LOW BATTERY LEVEL



A low battery error occurs when the battery voltage reaches less than 17 volts. The machine won't run below this voltage, so the only solution is to re-charge the battery.

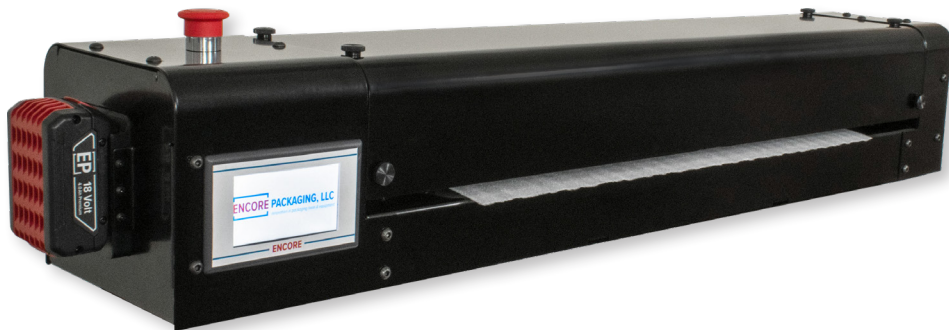

2. LIMIT SWITCH ERROR

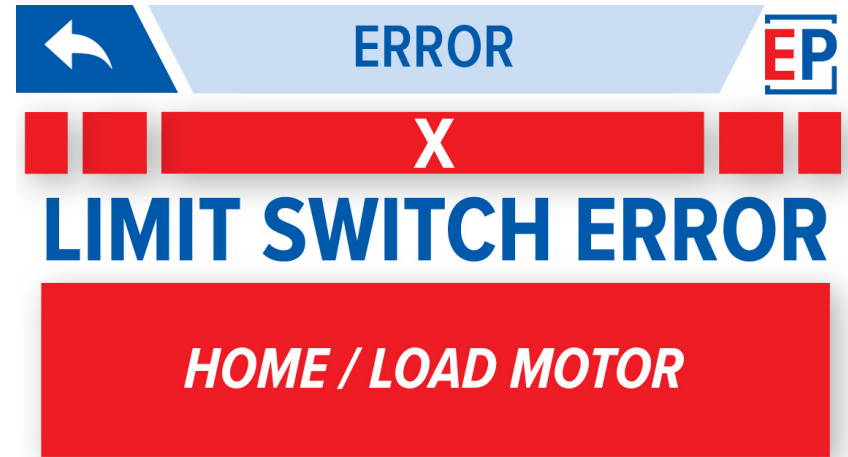

The limit switch error occurs when the cutting mechanism is not in the correct starting position when the run button is pressed. When this error occurs, the above screen will pop up. Press the button that reads "HOME / LOAD MOTOR" and it will take you to the reset menu screen shown below.

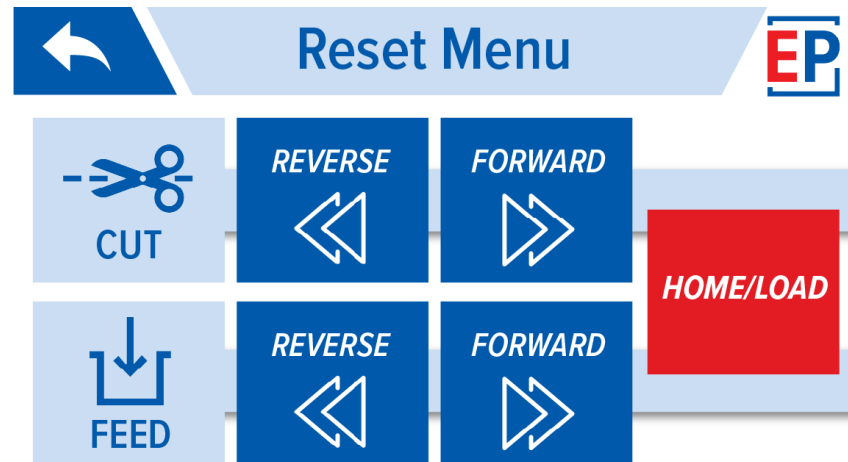

In this screen, press the button that reads "HOME / LOAD" and this will move the cutting mechanism to the correct position. Next, press the back arrow on the top left of the screen to go back to the main menu.

3. MOTOR JAM ERROR

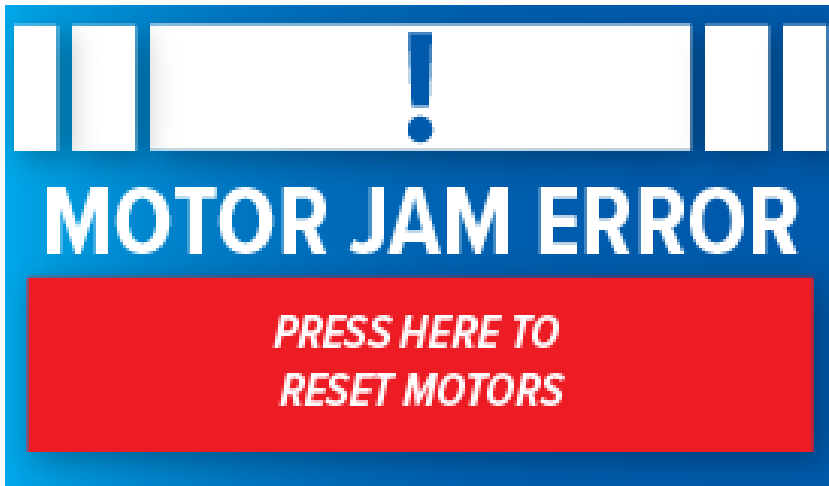

The motor jam error occurs when the material gets caught in the feed rollers or in the cutting mechanism. When this happens, you will get the screen shown above.

Press the button that says, “PRESS HERE TO RESET MOTORS”. Next, it will take you to the reset menu screen shown below.

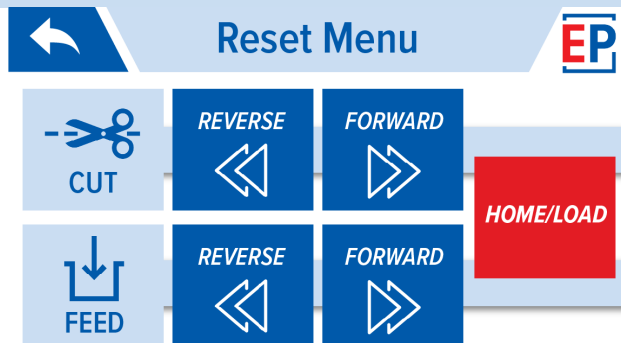

Next, the machine needs to be unjammed. If the material got stuck in the feed rollers, use the reverse button and forward button next to the feed symbol to move the material back out.

If the material got stuck in the cutting mechanism, use the reverse and forward buttons next to the cutting symbol to move the cutting mechanism. The reverse button will move the cutting mechanism left and the forward button will move the cutting mechanism right.

Once the machine is not jammed, press the “HOME/LOAD” button to reset the cutting mechanism to avoid getting a limit switch error. Next, press the back button on the top left of the screen to return to the main menu.

This page have been intentionally left blank

EP-6485-24 **PART LIST**

ITEM NO.	PART NUMBER	DESCRIPTION	QTY.
1	E6485-01	T-Frame Base	2
2	E6485-02	Brake, Tension Side	1
3	E6485-03-24	Frame Support Weldment	2
4	E6485-04-24	Top Support Weldments	1
5	E6485-05	Brake, Loading Side	1
6	E800-06-D	Flat Washer	12
7	E3500-09	HHS, 3/8"-16 X 3	4
8	E5815-09	Cap Screw	6
9	E5960-04	Washer	8
10	E5960-08	Nylock Hex Nut	4
11	E5960-15	Square Tube Plug	4
12	E5980-24	SHCS, 5-13 X 2.5"	2
13	E6420-03-G	M12 Nylock Nut	4
14	E6420-04	5" Caster	4
15	EP-6480-24	Automatic Sheet Cutter	1

Includes 2 batteries and 1 charger.

PART NUMBER	DESCRIPTION	QTY.
E1260-28-D	Battery	2
E1260-58	Charger	1

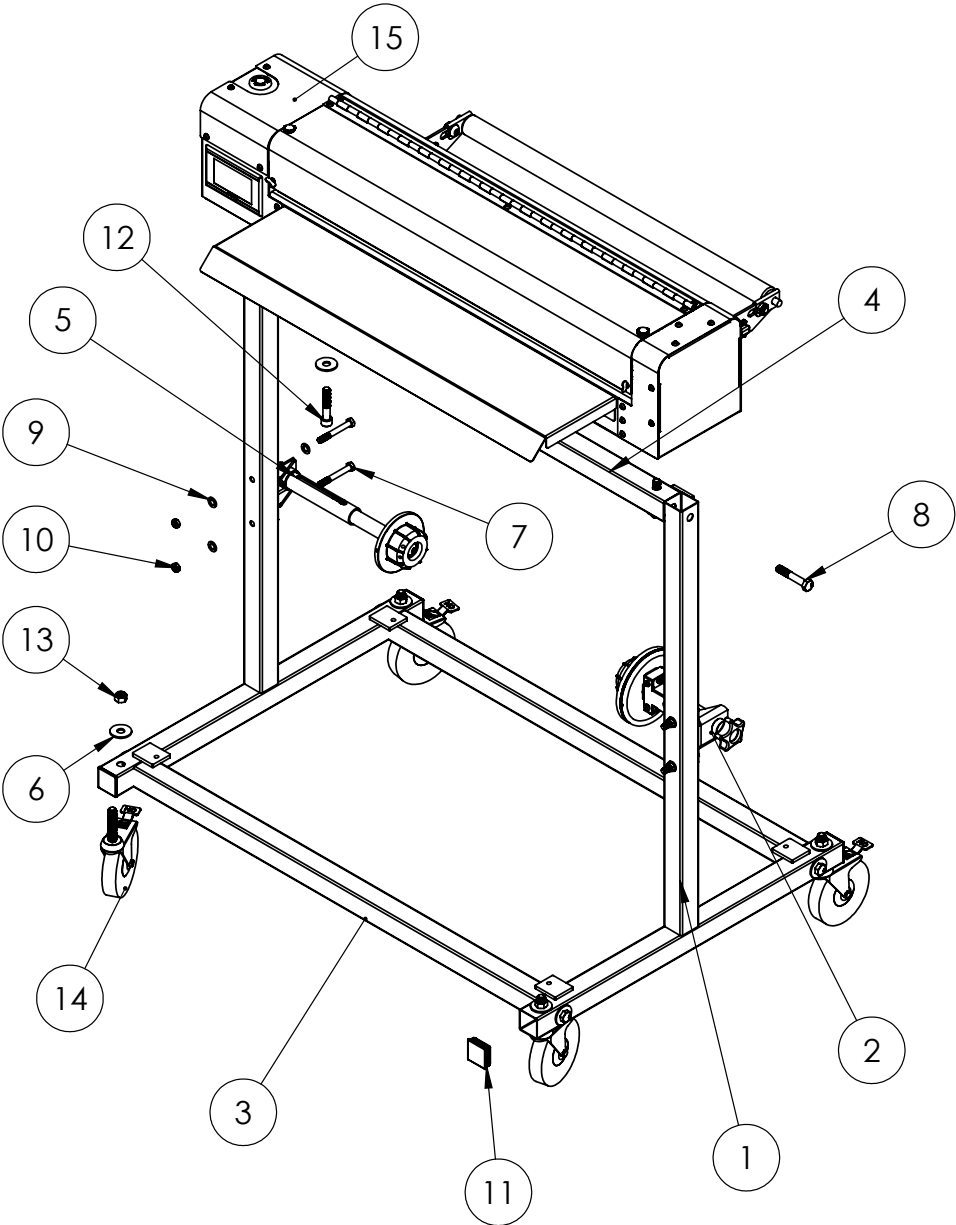
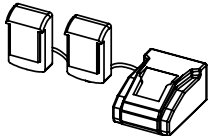



P (847) 735-8105 | F (847) 735-8297
sales@encorepack.com | www.encorepack.com



201 Park Avenue, Lake Villa, IL 60046
P.O. Box 595, Winnetka, IL 60093