

EP-3555

*Tool Balancer Cart (standard version w/ tool mast)
(Ribbon) for Steel and Poly Strapping*

assembly instructions

IT IS THE RESPONSIBILITY OF THE CUSTOMER TO ENSURE THAT
ALL OPERATORS AND SERVICE PERSONNEL HAVE FULLY READ
AND UNDERSTOOD THIS DOCUMENT

**READ ALL INSTRUCTIONS BEFORE OPERATING TOOL.
FAILURE TO FOLLOW ANY OF THESE GUIDELINES COULD
RESULT IN SERIOUS OR FATAL INJURY**



P (847) 735-8105 | F (847) 735-8297
sales@encorepack.com | www.encorepack.com



201 Park Avenue, Lake Villa, IL 60046
P.O. Box 595, Winnetka, IL 60093



IMPORTANT



PLEASE READ PRIOR TO ASSEMBLY

To ensure operator safety, it is important that all personnel use proper safety and handling procedures. This safety booklet is designed to educate operators on the safe use of the EP-3555 Tool Balancer Cart (standard version w/ tool mast) (Ribbon) for Steel and Poly Strapping. All personnel must read and understand this booklet prior to using this product. Failure to follow any of the recommendations in this pamphlet can result in serious injury or death.

READ PRODUCT SAFETY LABELS

- Read and understand all safety labels on the tool
- Replace all damaged or missing labels

READ THE INSTRUCTIONS

Before operating this tool, read, and understand all safety, operation, and maintenance information provided in the manual which is packaged with the tool. If you do not have a manual or need extra copies, please contact your Sales Representative. Tool must be inspected for wear and tear on a daily basis with proper daily documentation.

PRE-ASSEMBLED PARTS

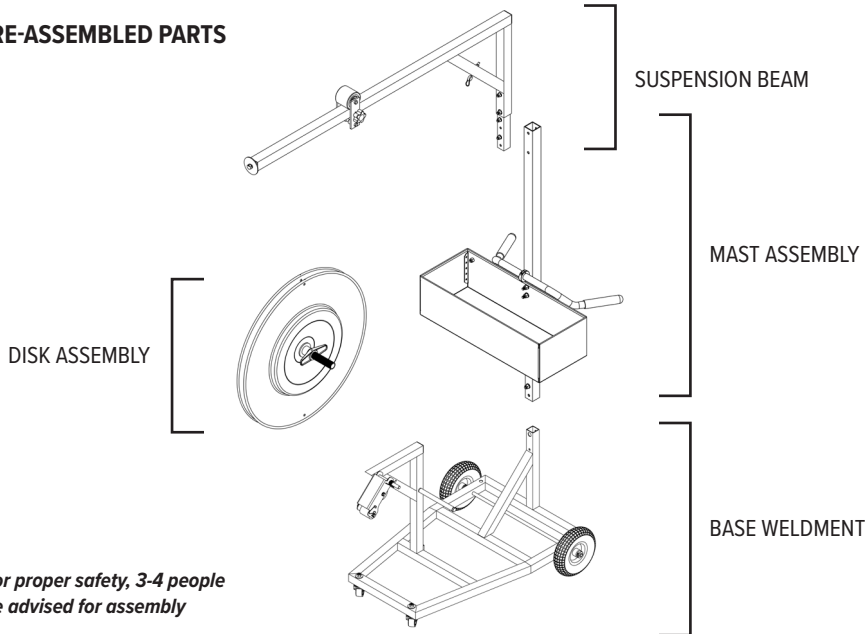

Terms & Conditions are found on our website: <https://www.encorepack.com/legal.php>

Please read our Terms & Conditions carefully prior to using or obtaining any materials, information products or services of **Encore Packaging LLC**, an Illinois limited liability company with a place of business at **201 Park Avenue, Lake Villa, IL 60046**.

P (847) 735-8105 | F (847) 735-8297  201 Park Avenue, Lake Villa, IL 60046
sales@encorepack.com | www.encorepack.com P.O. Box 595, Winnetka, IL 60093

ASSEMBLY INSTRUCTIONS

Step 1

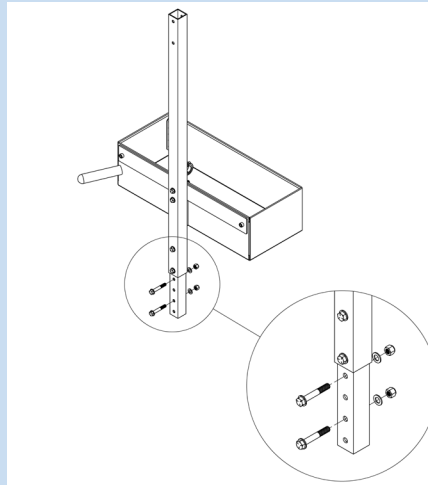

1. At the bottom of the Mast Assembly remove the two Hex Head Bolts, along with the Washers, and Nylock Hex Nuts.

Step 3

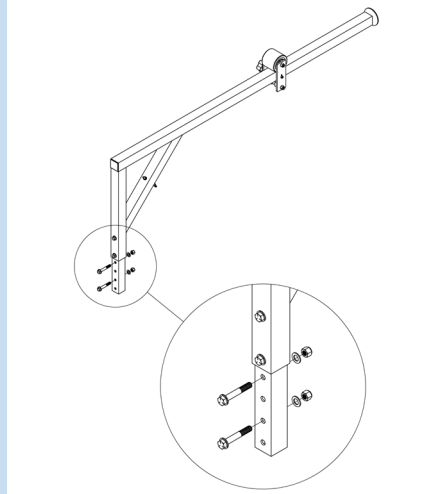

3. At the bottom of the Suspension Beam remove the two Hex Head Bolts, along with the Washers, and Nylock Hex Nuts.

Step 2

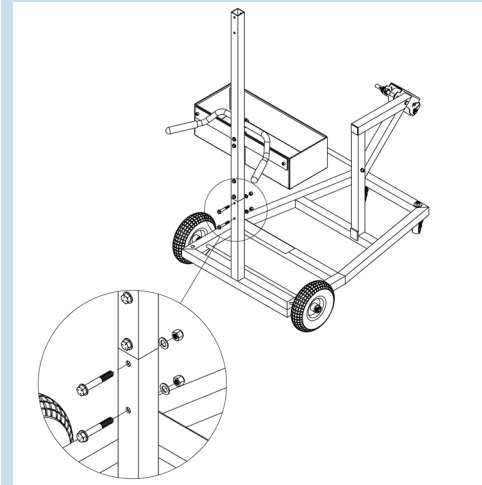

2. Slide the Mast Assembly into the square beam on the Base Weldment and replace the two Hex Head Bolts, Washers, and Nylock Hex Nuts.

Step 4

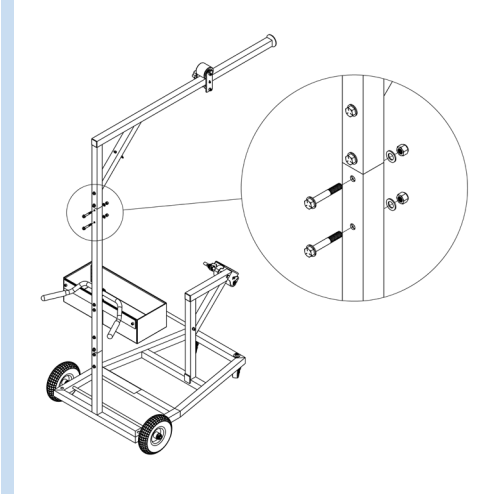

4. Slide the Suspension Beam into the top of the Mast Assembly and replace the two Hex Head Bolts, Washers, and Nylock Hex Nuts.

Step 5

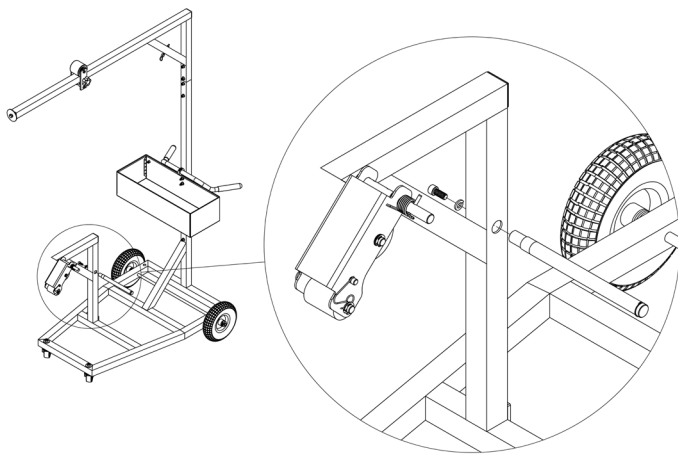

5. On the left side of the Disk Stand, unscrew the Socket Head Screw and remove the 3/8" Split Lock Washer. This will release the Retaining Ring on the other side.

Step 6

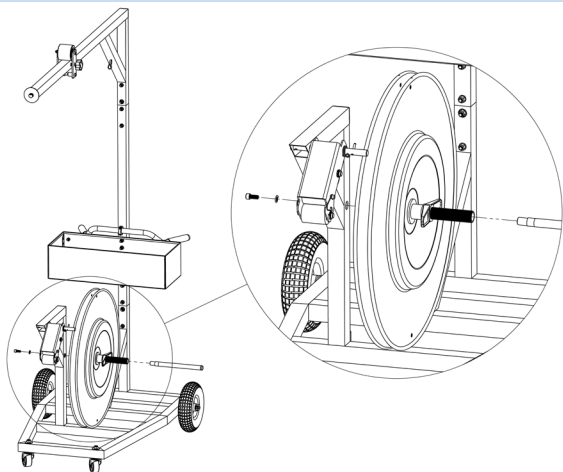

6. Slide the Disk Assembly onto the Spindle Weldment, so that the Spindle Weldment is inside the attached threaded rod and replace the Retaining Ring.

Step 7

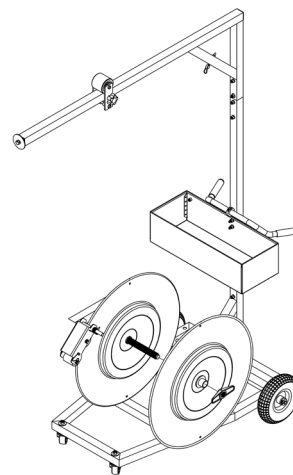

7. Unscrew the Wing Nut and remove the Front Disk Assembly.

Step 8

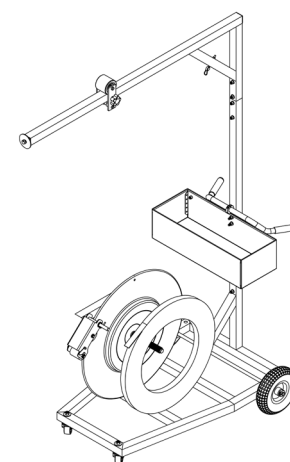

8. Load a Poly or Steel strap coil – make sure the orientation allows for counterclockwise dispensing through the Brake Assembly.

Step 9

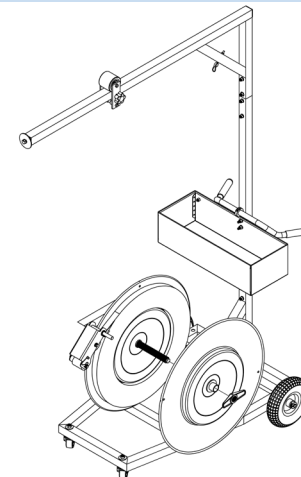

9. Slide on the Front Disk Assembly and replace the Wing Nut to secure the coil.

EP-3555 PART LIST

6/29/22 REV. C

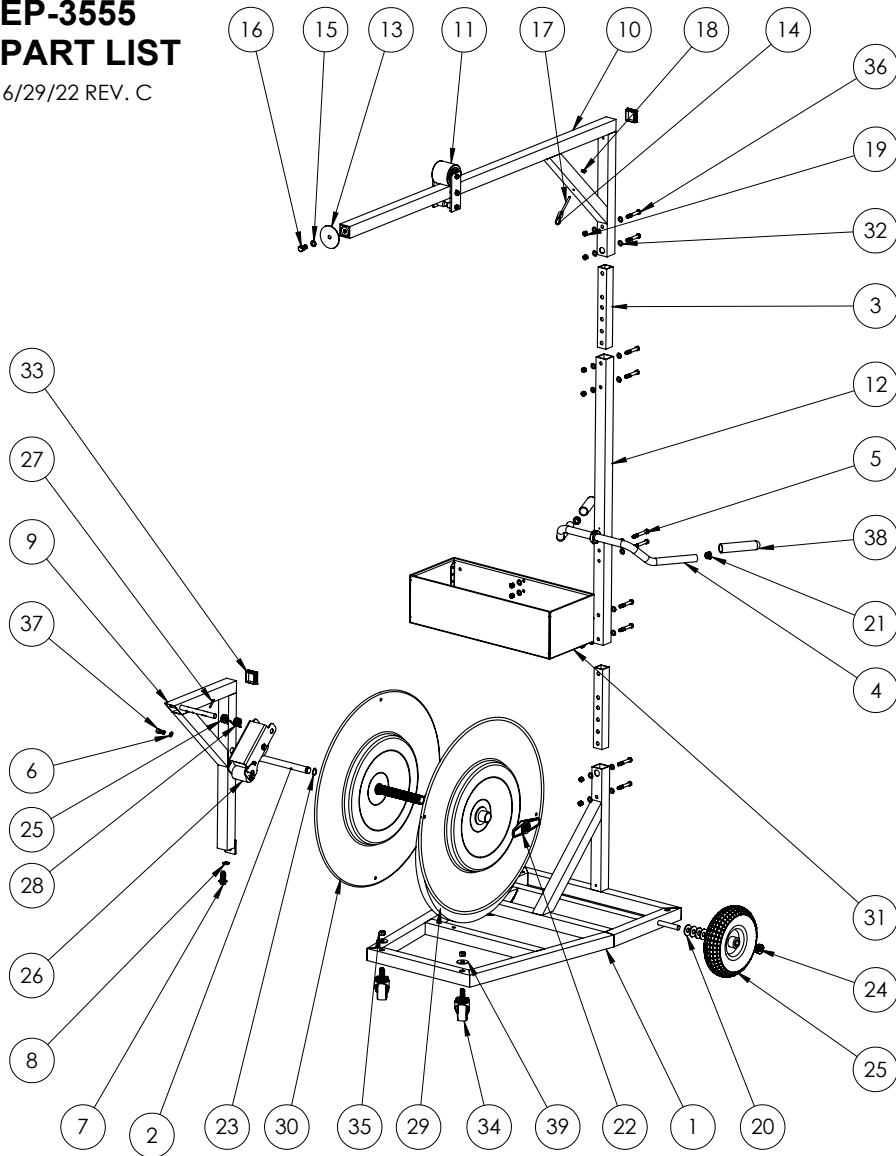

EP-3555 PARTS LIST

ITEM NO.	PART NUMBER	DESCRIPTION	QTY.
1	E3500-01	Base Weldment	1
2	E3500-03	Spindle Weldment	1
3	E3500-07	Adapter	2
4	E3500-08	Handle Bar	1
5	E3500-09	HHS, 3/8"-16 X 3	2
6	E3500-10	3/8" Split Lock Washer	1
7	E3500-11	M12 Flange HHS x 35mm	1
8	E3500-12	M12 Tooth Lock Washer	1
9	E3505-02	Disk Stand - Ribbon	1
10	E3550-01	Suspension Beam	1
11	E3550-02	Roller Assembly	1
12	E3550-03	Mast Assembly	1
13	E3550-04	Washer	1
14	E3550-05	Snap	1
15	E3550-06	M12 Lock Washer	1
16	E3550-07	HHS M12 X 25MM	1
17	E3550-08	Eye Hook	1
18	E1225-06-B	1/4" Nylock Hex Nut	1
19	E3065-19	Nylock Hex Nut	10
20	E3080-02	Wheel Washer	8
21	E3080-10-A	1" Tube Plug	2
22	E3100-02	Wing Nut	1
23	E3100-03	Retaining Ring	1
24	E3200-04-J	Shaft Collar	2
25	E3300-01	10" Pneumatic Tire	2
26	E3340-04	Brake Assembly	1
27	E3340-04-F	Roll Pin	1
28	E3340-05	Torsion Spring	1
29	E3340-13	Front Disk Assembly	1
30	E3350-12-R	Rear Disk Assembly	1
31	E3400-15	Cart Tray	1
32	E5960-04	Washer	20
33	E5960-15	Square Tube Plug	2
34	E6220-04	3" Caster	2
35	E6420-03-G	M12 Nylock Nut	2
36	E6420-12	Hex Head Bolt	8
37	E6700-31	Socket Head Screw	1
38	E800-02	Handle Grip	2
39	E800-06-D	Flat Washer	2



P (847) 735-8105 | F (847) 735-8297
sales@encorepack.com | www.encorepack.com



201 Park Avenue, Lake Villa, IL 60046
P.O. Box 595, Winnetka, IL 60093