



EP-3006

Strap Caddy Standard

assembly instructions

IT IS THE RESPONSIBILITY OF THE CUSTOMER TO ENSURE THAT
ALL OPERATORS AND SERVICE PERSONNEL HAVE FULLY READ
AND UNDERSTOOD THIS DOCUMENT

**READ ALL INSTRUCTIONS BEFORE OPERATING TOOLS.
FAILURE TO FOLLOW ANY OF THESE GUIDELINES COULD
RESULT IN SERIOUS OR FATAL INJURY**



P (847) 735-8105 | F (847) 735-8297
sales@encorepack.com | www.encorepack.com



201 Park Avenue, Lake Villa, IL 60046
P.O. Box 595, Winnetka, IL 60093



IMPORTANT



PLEASE READ PRIOR TO ASSEMBLY

To ensure operator safety, it is important that all personnel use proper safety and handling procedures. This safety booklet is designed to educate operators on the safe use of the EP-3006 Strap Caddy Standard. All personnel must read and understand this booklet prior to using this product. Failure to follow any of the recommendations in this pamphlet can result in serious injury or death.

READ PRODUCT SAFETY LABELS

- **Read and understand all safety labels on the tool**
- **Replace all damaged or missing labels**

INSPECT THE TOOL DAILY AND REPLACE ALL WORN OR BROKEN PARTS. LUBRICATE ALL MOVING PARTS DAILY.

ALWAYS WEAR PERSONAL PROTECTIVE EQUIPMENT WHEN USING ANY STRAPPING TOOLS.

READ THE INSTRUCTIONS

Before operating this tool, read, and understand all safety, operation, and maintenance information provided in the manual which is packaged with the tool. If you do not have a manual or need extra copies, please contact your Sales Representative. Tool must be inspected for wear and tear on a daily basis with proper daily documentation.



Terms & Conditions are found on our website: <https://www.encorepack.com/legal.php>

Please read our Terms & Conditions carefully prior to using or obtaining any materials, information products or services of **Encore Packaging LLC**, an Illinois limited liability company with a place of business at **201 Park Avenue, Lake Villa, IL 60046**.

P (847) 735-8105 | F (847) 735-8297
sales@encorepack.com | www.encorepack.com



201 Park Avenue, Lake Villa, IL 60046
P.O. Box 595, Winnetka, IL 60093

ASSEMBLY INSTRUCTIONS

Step 1

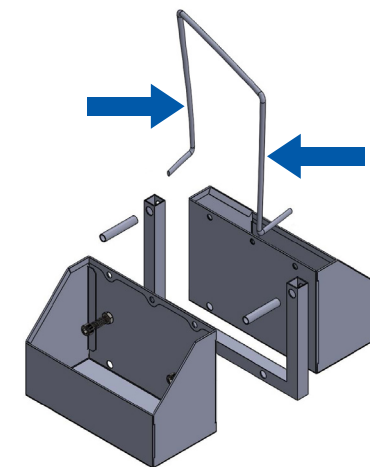
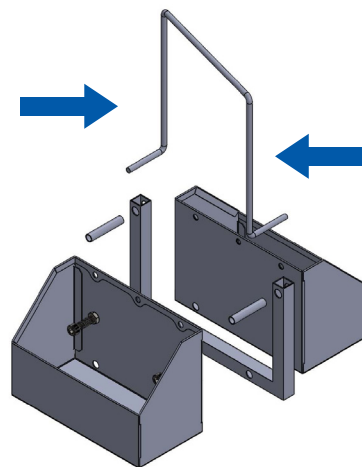

1. Pinch in the handle.

Step 2

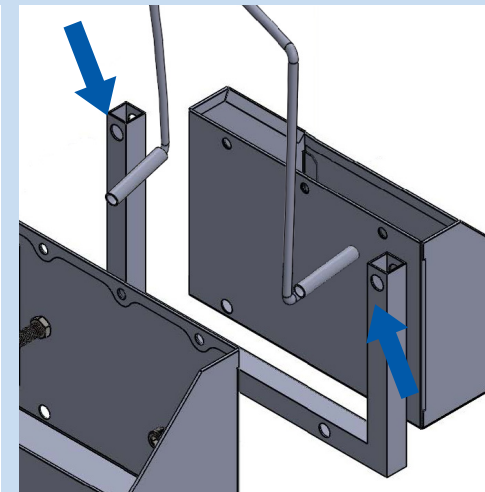
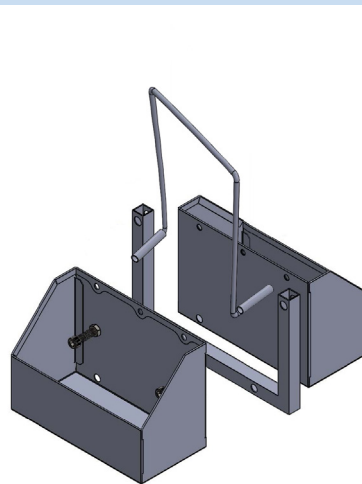

2. Then, slide tubes on the handles and finally slide the handle through the middle support holes.

EP-3006
PART LIST

ITEM NO.	PART NUMBER	DESCRIPTION	QTY.
1	E3025-13	Tray	2
2	E3025-12	Wire Form	1
3	E3006-03	Middle Support	1
4	E5920-01-F	3" Tube	2
5	E3006-04	0.5-13 Screw	2
6	E3006-05	0.5-13 Locknut	2

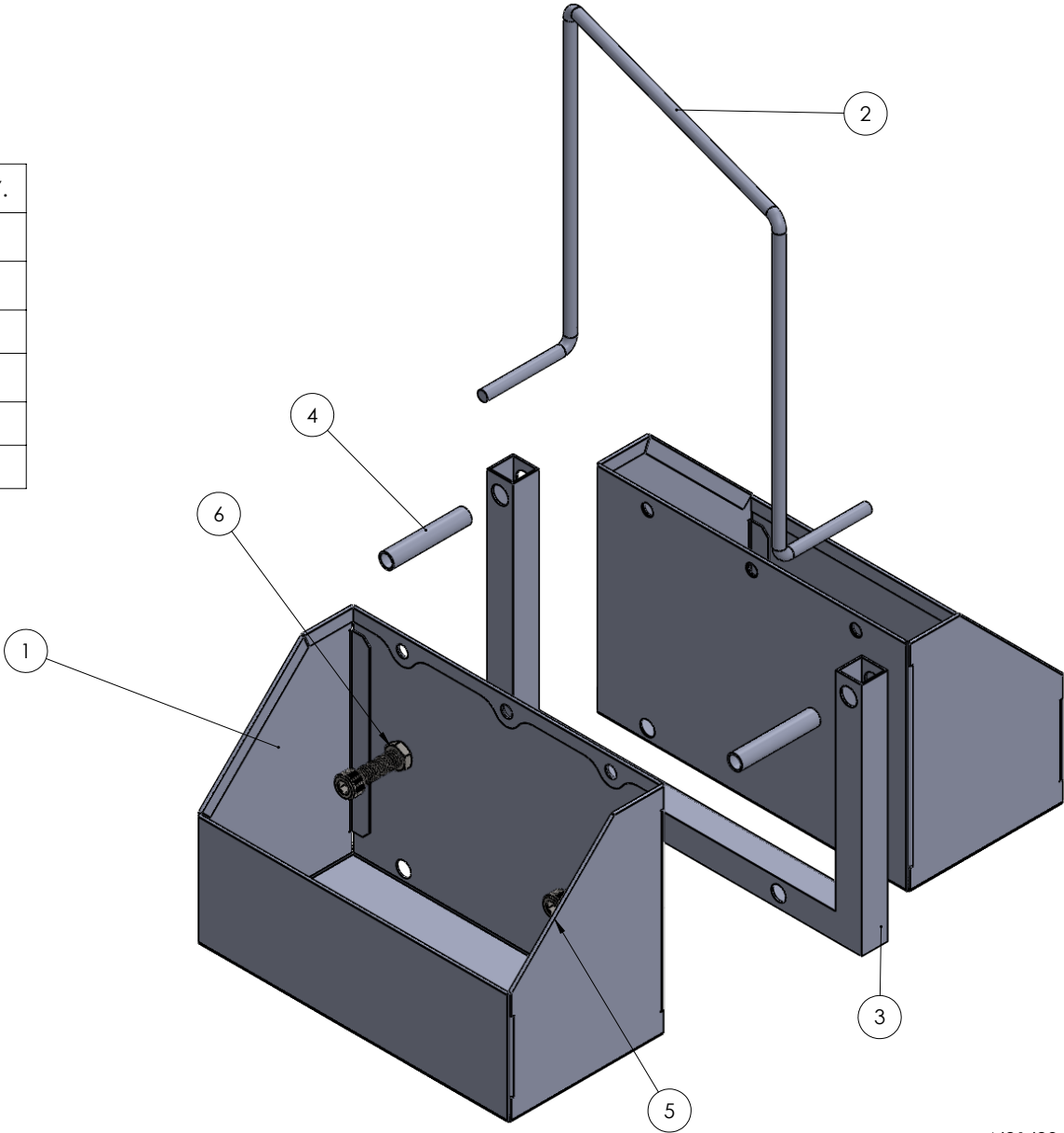

4/21/23 REV. B

This page have been intentionally left blank

This page have been intentionally left blank



P (847) 735-8105 | F (847) 735-8297
sales@encorepack.com | www.encorepack.com



201 Park Avenue, Lake Villa, IL 60046
P.O. Box 595, Winnetka, IL 60093