



A WATTS Brand

# Emergency Fixtures Replacement Parts

## Classic Model Parts

### Eyewash Bowls



**154-058**  
Impact-resistant plastic eyewash bowl, 10" diameter



**187-053**  
Corrosion-resistant stainless steel bowl, 10¾" diameter

### Dust Caps



**107-371**  
Eyewash dust caps only (sold individually; two required per eyewash). Yellow plastic tether. Approximately 1" x 1".



**S53-063**  
Dual Eye/Face wash dust caps only (sold individually; two required per eyewash). Beaded chain tether, 2¼" x 1".



**S53-310**  
Eyewash dust cap (sold individually; two required per eyewash). Beaded chain tether, 1" x 1".

### Sprayhead and Spray Ring Assemblies



**S39-394**  
Eyewash sprayhead assembly with supply stem



**S39-396**  
Eye/face wash sprayhead assembly with supply stem



**S39-681**  
Eye/face wash sprayhead assembly; stem not included  
**S39-682 (not shown)**  
Eye/face wash sprayhead assembly for use with PVC unit only. Stem not included



**S45-2453**  
Eye/face wash (sprayheads only) Includes 2.4 gpm flow control inside each head. Total flow from dual heads is 4.8 gpm



**S39-397**  
Eyewash and spray ring assembly with supply stem



A WATTS Brand

# Emergency Fixtures Replacement Parts

## Classic Model Parts

### Eyewash Ball Valves, Handles and Hardware



#### **S45-122**

Plastic eyewash handle with 1/2" brass NPT stay-open ball valve and hardware

#### **S45-123**

Plastic eyewash handle with hardware

#### **S27-282**

Brass 1/2" NPT stay-open ball valve only



#### **S30-070**

Stainless steel eyewash handle with 1/2" brass NPT stay-open ball valve and hardware

#### **S30-071**

Stainless steel eyewash handle with hardware

#### **S08-336**

Stainless steel eyewash handle only

#### **S27-282**

Brass 1/2" NPT stay-open ball valve only



#### **S30-072**

For stainless steel hinged dust covers only. Stainless steel eyewash handle with 1/2" brass NPT stay-open ball valve and hardware

#### **S30-087**

For stainless steel hinged dust covers only. Stainless steel eyewash handle with hardware

#### **S27-282**

Brass 1/2" NPT stay-open ball valve only



#### **S30-074**

For S19-270BL (left-hand) eyewash only. Stainless steel eyewash handle with 1/2" brass NPT stay-open ball valve and hardware

#### **S30-075**

For S19-270BL (left-hand) eyewash only. Stainless steel eyewash handle with hardware

#### **S27-282**

Brass 1/2" NPT stay-open ball valve only



#### **S30-109**

Stainless steel eyewash handle with 1/2" stainless steel NPT stay-open valve

#### **S30-110**

Stainless steel eyewash handle with 1/2" vented stainless steel NPT stay-open ball valve

#### **S30-111**

316 stainless steel eyewash handle without dust cover with 1/2" stainless steel NPT stay-open ball valve

#### **S30-116**

316 stainless steel eyewash handle with hardware



#### **S30-112**

Stainless steel eyewash handle with dust cover with 1/2" stainless steel NPT stay-open ball valve



A WATTS Brand

# Emergency Fixtures Replacement Parts

## Classic Model Parts

### Stem Assemblies, Spacers and Flow Restrictors

| Sprayhead Assembly                  | Galvanized Fixture with Plastic Bowl     | Galvanized Fixture with Stainless Steel Bowl | Standard Stainless Steel Fixture         | 316 Stainless Steel Fixture              |
|-------------------------------------|--|--|--|--|
| Eyewash Only                        | S21-071 (stem)<br>113-1185 (stem spacer) | S21-071 (stem)<br>113-1159 (stem spacer)     | S21-072 (stem)<br>113-1159 (stem spacer) | S21-075 (stem)<br>113-1159 (stem spacer) |
| Eye/Face Wash with Spray Ring       | S21-073 (stem)<br>113-1185 (stem spacer) | S21-073 (stem)<br>113-1159 (stem spacer)     | S21-074 (stem)<br>113-1159 (stem spacer) | None                                     |
| Eye/Face Wash with Dual Black Heads | 113-1150 (stem)                          | 113-1150 (stem)                              | 113-1151 (stem)                          | None                                     |

### Stem Assemblies

☒ Spacers 113-1159 and 113-1185 are required for units that shipped on or before 11/2/2005.



#### S21-071

Brass stem assembly with flow restrictor; **for units with eyewash only**

#### 113-1150

Brass stem only; **for units with dual black eye/face wash heads**



#### S21-073

Stainless steel stem assembly with flow restrictor; **for stainless steel units with eyewash only**

#### S21-075

316 stainless steel stem assembly with flow restrictor; **for 316 stainless steel units (with eyewash) only**

#### 113-1151

Stainless steel stem only; **for stainless steel units with dual black eye/face wash heads**



#### S21-073

Brass stem assembly with flow restrictor; **for units with eyewash and spray ring only**



#### S21-074

Stainless steel stem assembly with flow restrictor; **for stainless steel units with eyewash and spray ring only**

### Stem Spacers



#### 113-1159

Stainless steel stem spacer; for use in units with stainless steel bowl



#### 113-1185

Black plastic stem spacer; for use in units with yellow plastic bowl

### Eyewash and Eye/Face Wash Flow Restrictors



#### 125-167

3.7 gpm pink flow restrictor; **for eyewash with face spray ring only** (stem not included)



#### 125-032

3.5 gpm black flow restrictor; for swing-activated and swing-down units



A WATTS Brand

# Emergency Fixtures Replacement Parts

## Halo Model Parts

### Covers and Bowl Kits



**187-320**

Plastic bowl



**S90-390**

Plastic bowl cover kit



**S90-391**

Stainless steel bowl kit



**S90-388**

Stainless steel bowl  
cover kit

**S90-392**

316 stainless steel bowl kit

### Sprayhead Assemblies



**S05-190**

Sprayhead assembly



**S05-192**

Sprayhead assembly



**S05-204**

304 Stainless steel  
sprayhead assembly

**S05-205**

316 Stainless steel  
sprayhead assembly

### Dust Cover Kits



**S45-2675**

Eyewash cover kit

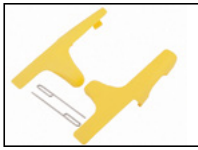

**S45-2676**

Eye/Face wash cover kit

### Ball Valves



**S27-327**

Chrome-plated brass 1/2" ball valve

**S27-328 (not shown)**

Stainless steel 1/2" ball valve

### O-ring and Flow Control



**S65-339**

O-ring and screen



**S88-068**

O-ring and flow  
control

### Handle Kit



**S08-390**

Handle kit



A WATTS Brand

# Emergency Fixtures Replacement Parts

## Spintec™ Showerhead and Drench Shower Parts

- Includes integral 22 gpm flow restrictor
- Fully distributes water throughout spray pattern
- Compact design minimizes footprint in your facility



### S24-192

Plastic shroud and ring  
(showerhead not included)



### S24-193

Stainless steel shroud and ring  
(showerhead not included)



### S24-194

Plastic showerhead and 1"  
diameter 90° elbow



### S24-200

Stainless steel showerhead and  
1" diameter 90° elbow



### S24-195

Plastic shroud with ring, plastic  
showerhead and 1" diameter 90°  
elbow



### S24-196

Stainless steel shroud with ring, plastic  
showerhead and 1" diameter 90° elbow



### S24-202

Plastic showerhead, white steel in-ceiling recessed shroud  
assembly, ring, coupling and 1" diameter 90° elbow



### 154-147

Ring only



### 128-156A

Drench shower handle for standard  
(non-barrier-free) units (27¾" x 9")

### 128-156B

Drench shower handle for flush-mount  
(non-barrier-free) units (36" x 9")

### 128-156C

Drench shower handle (48" x 9")

### 128-156D

Drench shower handle (standard; shipped  
with barrier-free showers) (45½" x 9")

### 128-156E

Drench shower handle (57" x 9")

### 128-156F

Drench shower handle (69" x 9")



### S90-365C

Drench shower handle, 2-piece (48" x 9")

### S90-365D

Drench shower handle, 2-piece (45½" x  
9")



### S30-059

Chrome-plated brass  
1" NPT ball valve with  
lever - recommended for  
optimal performance

### S27-278

Chrome-plated brass 1"  
NPT ball valve only

### S30-061 (not shown)

Stainless steel 1" NPT  
ball valve with lever  
-recommended for optimal  
performance. Required  
to service any product  
purchased before August  
2019.

© 2024 Bradley



A WATTS Brand

# Emergency Fixtures Replacement Parts

## Drench Hose Parts

### Hoses



**S89-002**  
8' thermoplastic hose;  
yellow

**S89-003**  
6' stainless steel hose



**269-053**  
12' thermoplastic  
hose; yellow



**269-054**  
25' thermoplastic  
hose; yellow

### Hose Guide Bracket



**140-226**  
Drench hose  
guide bracket

### Drench Hose Replacement Part Valves



**S39-817**  
Replacement valve  
with drench hose  
sprayhead

### Backflow Prevention



**S27-303**  
Dual-check  
backflow preventer  
compliant with  
ASSE 1024 &  
CSA B64.6 Watts  
Series 7



**S45-2309**  
Dual-check  
vacuum  
breaker  
compliant with  
CSA B64.6  
Watts Series 9



**S45-2310**  
Dual-check backflow  
preventer compliant  
with ASSE 1012 Watts  
Series 9D; includes  
fittings for easy  
installation



A WATTS Brand

# Emergency Fixtures Replacement Parts

## Other

### Safety Signs and Tags

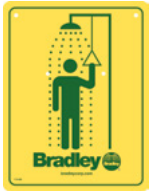

**114-050**

Drench shower  
sign



**114-051**

Eyewash sign

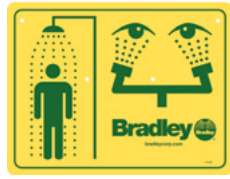

**114-052**

Combination drench  
shower and eyewash  
sign

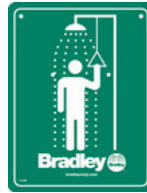

**114-050E**

International safety  
drench shower sign

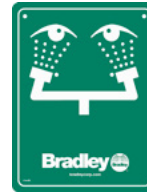

**114-051E**

International safety  
eyewash sign



**114-052E**

International safety  
combination drench  
shower and eyewash  
sign

### Foot Treadle Kits



**S45-572**

Foot treadle and hardware kit (with 3-foot chain) for standard pedestal-mounted eyewashes and combination shower/eyewash units with hand operation; provides supplemental foot operation

**S45-1314SS**

Type 316 stainless steel foot treadle and standard stainless steel hardware kit for stainless steel pedestal-mounted eyewashes and combination shower/eyewash units

**S45-1314SS16**

Type 316 stainless steel foot treadle and 316 stainless steel hardware kit for Type 316 stainless steel pedestal-mounted eyewashes and combination shower/eyewash units



**S39-395**

Foot treadle and hardware kit for wall-mounted eyewashes with hand operation; provides supplemental foot operation

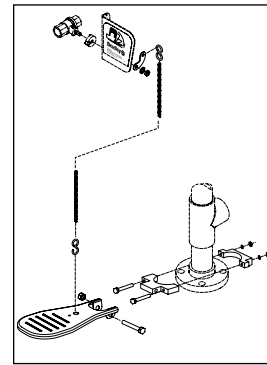

**S45-620**

Foot treadle and hardware kit for model S19-310PVC combination drench shower and eyewash unit with hand operation; provides supplemental foot operation

### On-Site Portables



**S19-949 On-Site Eyewash Kit**

Includes replacement cap, nine foam liners, inspection tag

**269-1379 On-Site Water Foam Liner**

Perforated foam liner (sold individually)



**133-152**

Gravity fed tank

### Miscellaneous Supplies

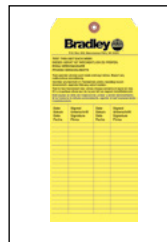

**204-421**

Inspection tag  
(sold individually)



**269-964**

Safety yellow touch-up  
paint. 12-oz aerosol

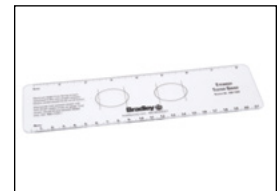

**269-1444**

Eyewash test gauge

© 2024 Bradley

Page 7 of 8 6/19/2024

This information is subject to change without notice.

Bradley\_SafetyReplacementParts

P.O. Box 309, Menomonee Falls, WI 53052-0309  
800 BRADLEY (800 272 3539)

+1 262 251 6000  
bradleycorp.com





A WATTS Brand

# Emergency Fixtures Replacement Parts

## Other

### Freeze and Scald Protection Kits

- **Freeze protection valves** completely open at 35°F (1.6°C) and closes at 45°F (7.2°C)
- **Scald protection valves** completely open at 105°F (40.5°C) and closes at 85°F (29.4°C)



Classic combination units require both drench shower and eyewash protection valves.



#### S45-1703

Freeze protection replacement valve for drench showers and eyewashes

#### S45-1702

Scald protection replacement valve for drench showers and eyewashes

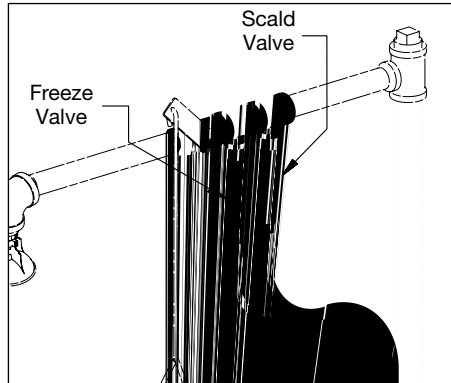

#### S45-1987

Freeze protection kit for drench showers; includes freeze protection valve, tee, nipples, compression fitting, ball valve, tubing, and cable tie

#### S45-1990

Scald protection kit for drench showers; includes scald protection valve, tee, nipples, compression fitting, ball valve, tubing, and cable tie

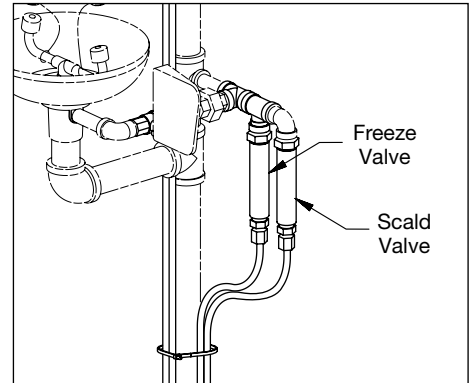

#### S45-1986

Freeze protection kit for eyewashes; includes freeze protection valve, tee, nipples, compression fitting, ball valve, tubing, and cable tie

#### S45-1989

Scald protection kit for eyewashes includes scald protection valve, tee, nipples, compression fitting, ball valve, tubing, and cable tie

### Optional Adapters

#### 153-395

Female, 1 $\frac{3}{16}$ " x 24 — Chrome

#### 153-396

Male,  $\frac{3}{8}$ " NPSM — Chrome

#### 153-401

Female,  $\frac{3}{4}$ " (Garden Hose) — Chrome

© 2024 Bradley