

Dual Sensor Water/Soap Dispenser Installation Manual



750EFDMSDBK / 750EFDMSDC

To assure that the product operates properly, please make sure to follow all procedures within this instruction manual.

Product Specs:

1. Operating Power: 6V / 2A
2. Operating Water Pressure: 10 to 100 PSI
3. Soap Dispensing Time: 0.5-2 seconds
(Factory setting is 2 seconds.)
4. Soap Reservoir Capacity: 1.5L
(Only use foaming soap)
5. Sensor Distance: 1¼-6 in.
(Factory setting is 4 in.)
6. Response Time: 0.2 seconds
7. Shut-Off Time: 1 seconds
8. Operating Temperature: 5-70°C / 41-158°F

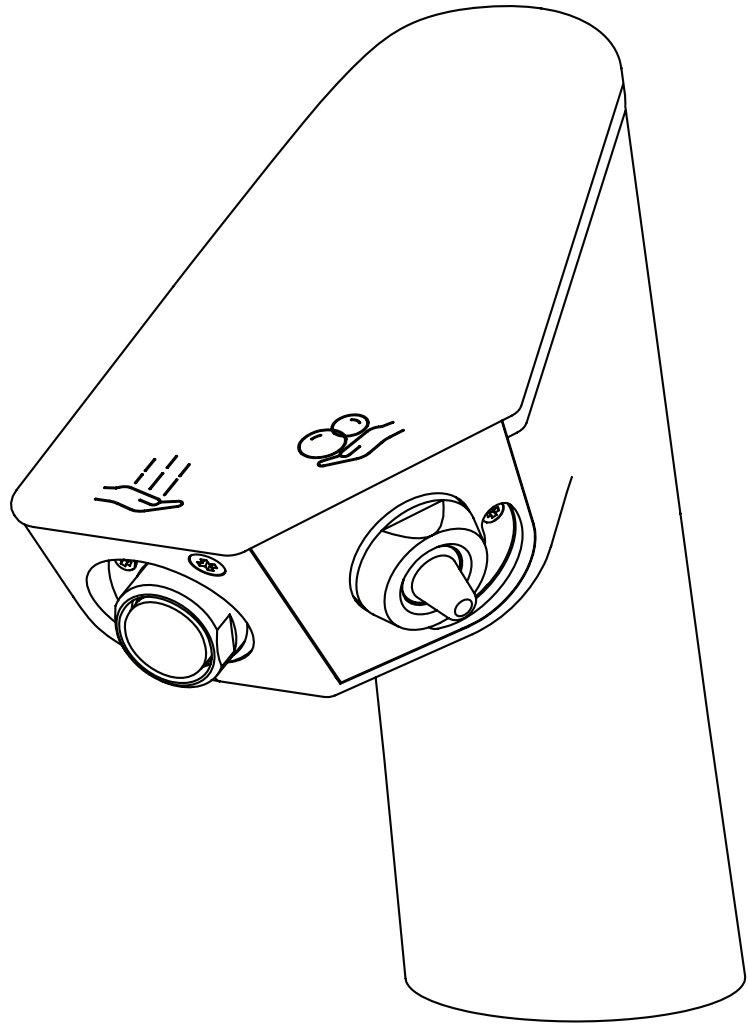

Dual Sensor Water/Soap Dispenser Installation Manual



Faucet Body Component List

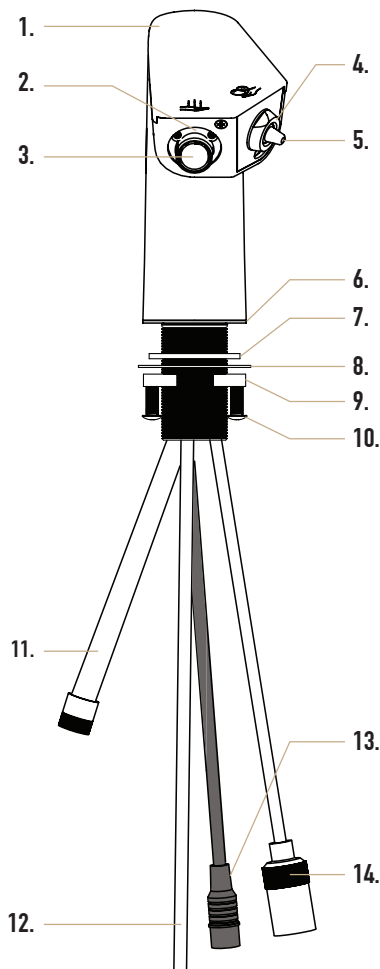

- | | |
|--------------------|-------------------------------------|
| 1. Spout Body | 9. Fixation Nut |
| 2. Faucet Sensor | 10. Tightening Screw |
| 3. Spout | 11. Outlet Hose |
| 4. Soap Sensor | 12. Soap Tube |
| 5. Soap Spout | 13. Sensor Cable for Soap (White) |
| 6. Base Gasket | 14. Sensor Cable for Faucet (Black) |
| 7. Gasket | |
| 8. Fixation Washer | |

Control Module Component List

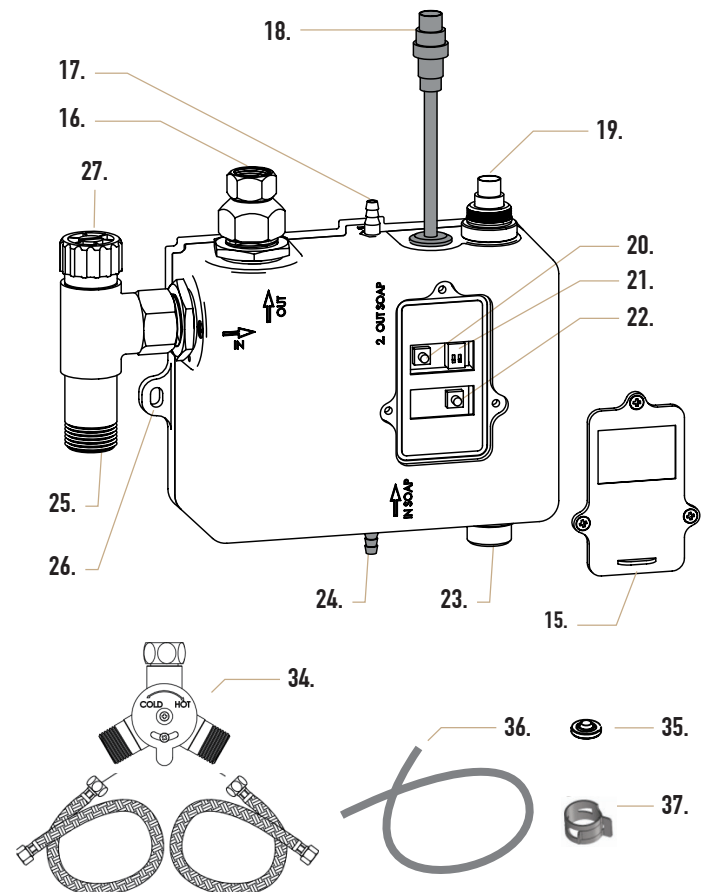

- | | |
|-----------------------------------------|--------------------------------------------|
| 15. Dial Cover | 23. Power Inlet for AC Adapter |
| 16. Outlet for Water | 24. Inlet for Soap (Black Tube) |
| 17. Soap Outlet | 25. Water Inlet |
| 18. Sensor Connector for Soap Dispenser | 26. Fixation Tab |
| 19. Sensor Connector for Faucet | 27. Filter |
| 20. Soap Dispenser Rest/Purge Button | 34. Mixing valve, Hot and Cold Water Hoses |
| 21. Soap Dispenser Setting DIP Switch | 35. Rubber Washer |
| 22. Faucet Reset/Purge Button | 36. Black Tube |
| | 37. Clip Fastener |

Dual Sensor Water/Soap Dispenser Installation Manual



Soap Canister Component List

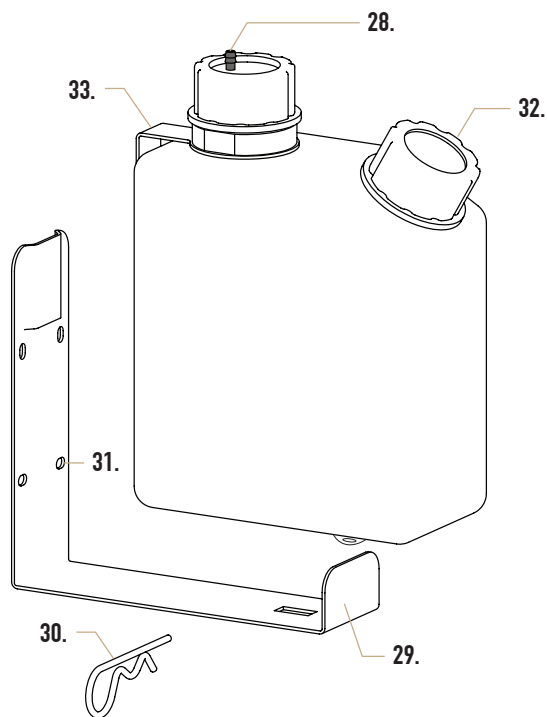

- | | |
|-----------------------------------|----------------------------|
| 28. Soap Outlet to Control Module | 31. Mount Holes |
| 29. Soap Canister Mount | 32. Re-filler Cap |
| 30. Fixation Pin | 33. Canister Fixation Hook |

Installation Diagram

Please note that actual installation may differ based on actual application.

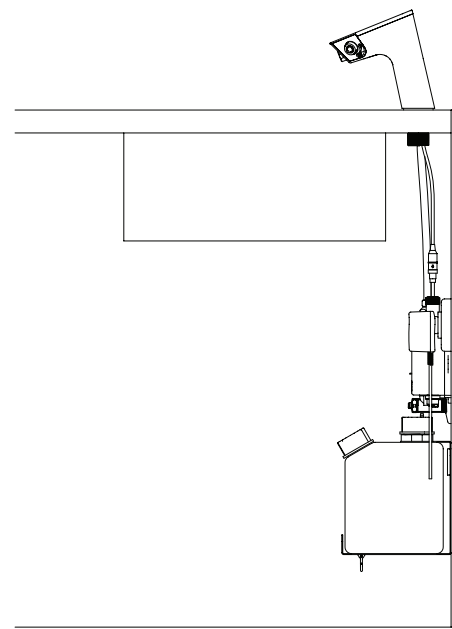
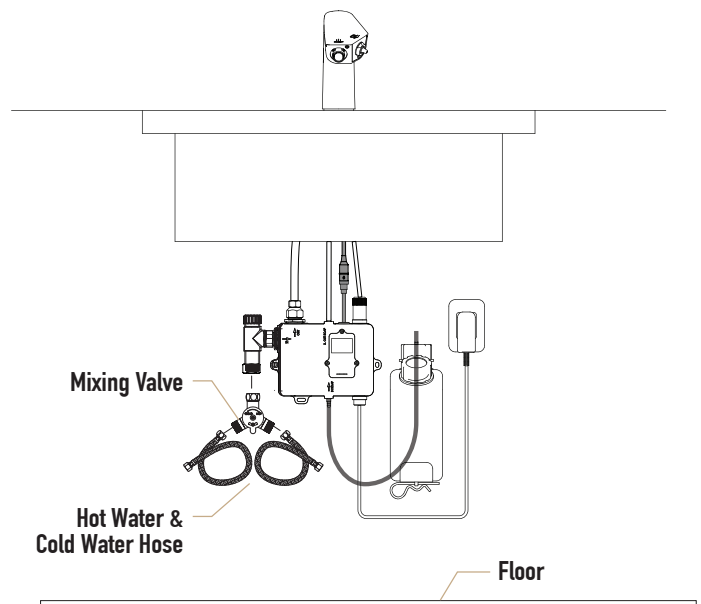

Dual Sensor Water/Soap Dispenser Installation Manual



Installation Diagram

1. Shut off water valve.

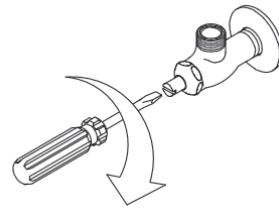

2. Thread the wires and hoses through your counter hole. Make sure spout body and base gasket are flat on the counter.

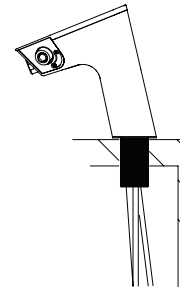

3. Tightly secure the spout body by using the fixation washer, gasket, nut and screw (7, 8, 9, 10).

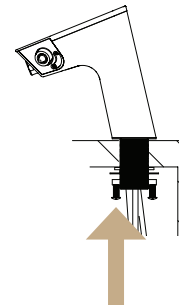

Dual Sensor Water/Soap Dispenser Installation Manual



Installation Diagram

4. Secure the control module to the wall using the provided template.

5. Make sure the control module is tightly fastened.

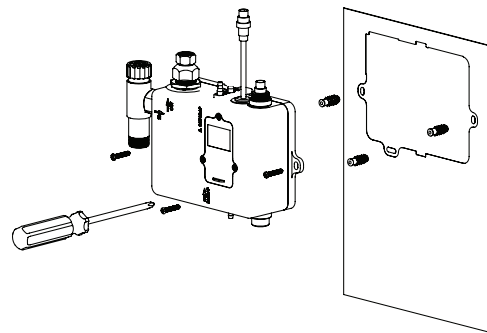

6. Tightly connect mixing valve (34) to water (25) inlet of the control module.

7. Tightly connect the hot water hose (red) to the hot side of mixing valve and do the same for the cold water hose (blue). **DO NOT BEND THE HOSES.**

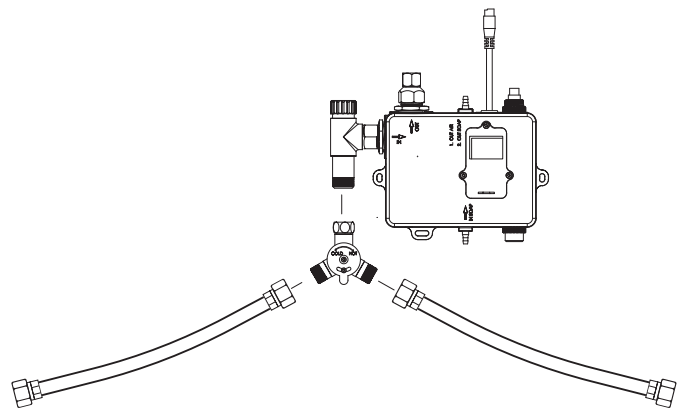

8. Connect the provided rubber washer (35) to the outlet for water (16) on the control module and tighten the outlet hose (11) to it. **MAKE SURE TO USE THE PROVIDED RUBBER WASHER.**

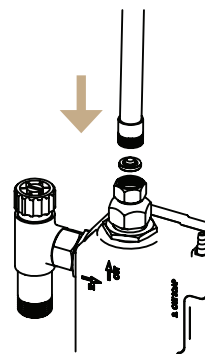

Dual Sensor Water/Soap Dispenser Installation Manual



Installation Diagram

9. Connect tightly the head of sensor cable for soap (white) of the spout body (13) to the sensor connector for soap dispenser (18) of the control module.

10. Connect tightly the head of sensor cable for faucet (14) of the spout body to the sensor connector for faucet (19) of the control module.

11. Connect soap tube (12) of spout body to soap outlet (17) of the control module and fit tightly by using the provided clip fastener (37).

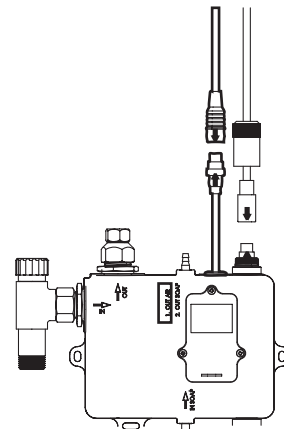

ATTENTION:

Align the direction of the arrow of each head between spout body and control module. Make sure each head of spout body is connected correctly to each head of control module.

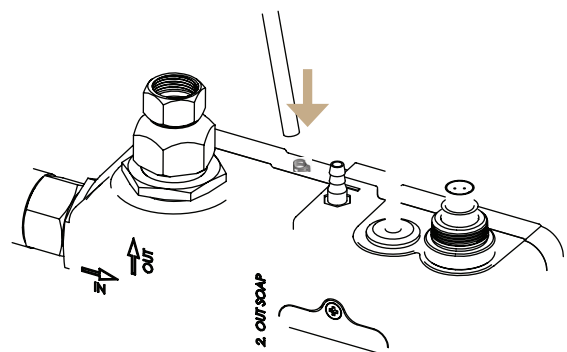

Dual Sensor Water/Soap Dispenser Installation Manual



Installation Diagram

Soap canister mount installation.

12. Drill a screw hole in the wall by using “template for soap canister mount.”

13. Screw in the soap canister mount (29) and make sure it is tightly fastened and does not wobble.

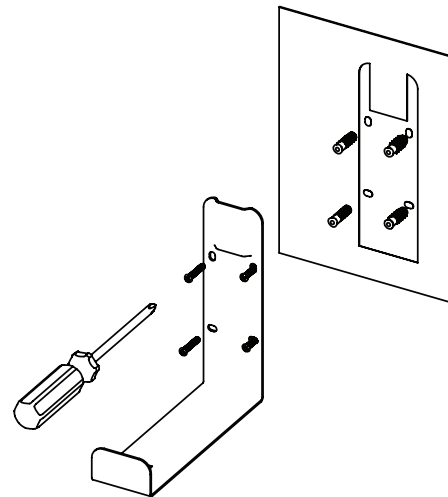

14. Connect the provided black tube (36) to soap outlet (28) to control module of soap canister and fit tightly by using the provided clip fastener (37). Connect the other side of the black tube to the inlet for soap of control module (24) and fit tightly by using the provided clip fastener (37).

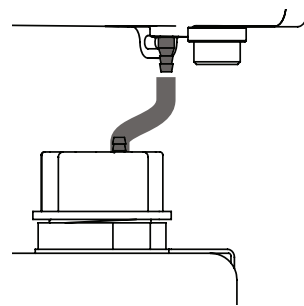

15. Open the refill cap (32) and pour foaming soap into soap canister. After refilling, replace refill cap.
NOTE: ONLY USE FOAMING SOAP.

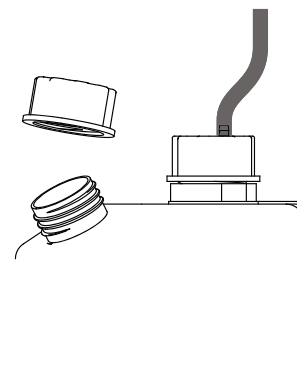

Dual Sensor Water/Soap Dispenser Installation Manual



Installation Diagram

16. Place the soap canister on the soap canister mount (29).

17. Insert the fixation pin (30) into the fixation tab at the bottom of soap canister.

18. Connect AC adapter to the the power inlet (23) of the control module.

The control module will start adjusting sensing distance when power on. Manual sensor distance adjustments may be required.

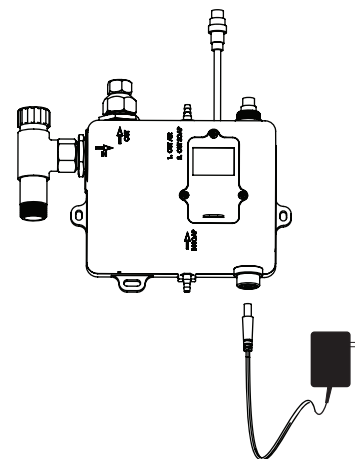
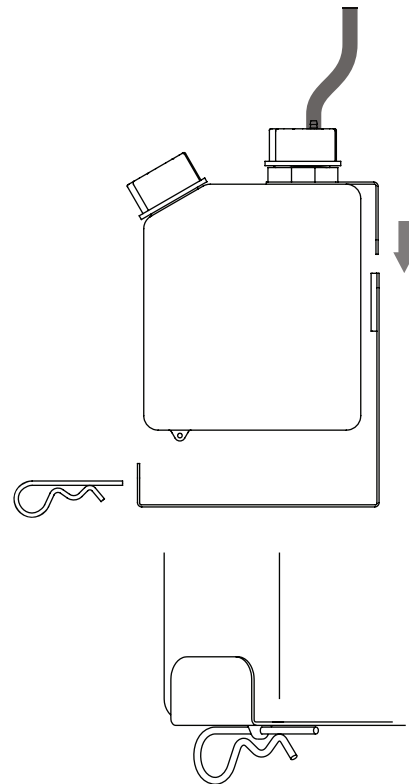

Dual Sensor Water/Soap Dispenser Installation Manual



System Setup

1. Remove the Dial Cover.

2. Setting the Faucet Sensor Distance

- Press and hold the faucet system reset/purge button (22) for about 5-7 seconds to clear CPU setting memory, LED on sensor will turn on and stay lit to enter setting mode.
- Release button, LED will turn off, place your hand at desired sensing distance, LED is flashing and wait until it stays lit to complete new setting.
- If your hand leaves sensing position range, water delay will cut off after 2 seconds. Please reset to shorten sensing distance and ensure water cut off time adjusts to 1 second.
- Remove your hand and test new setting.
- Factory default sensing distance is 4 in.

3. Soap Dispenser Sensor Setup

Distance setting:

- Press and hold soap system reset/purge button (20) for 2 seconds (LED on sensor is flashing).
- Press the reset/purge button again to enter setup mode. Place your hand at the desired sensing distance, LED will flash when the new setting is complete.
- Test the new setting.

Continuously dispensing soap setting:

- Press and hold the soap system reset/purge button (20) for 5 seconds (LED on sensor stays lit) to activate continuously dispensing soap.
- If want to stop dispensing soap, press and hold soap system reset/purge button (20) again for 2 seconds.

Important note: The soap dispenser will dispense soap automatically for one time every 12 hours to prevent clogging. Soap system DIP switch (21) is for soap dispensing time setting. Setting chart to the right. Factory default setting: 1 seconds. After setting, install back the dial cover.

The system is a digital system. Do NOT attempt to tamper with the electronic components in risk of damaging the components.

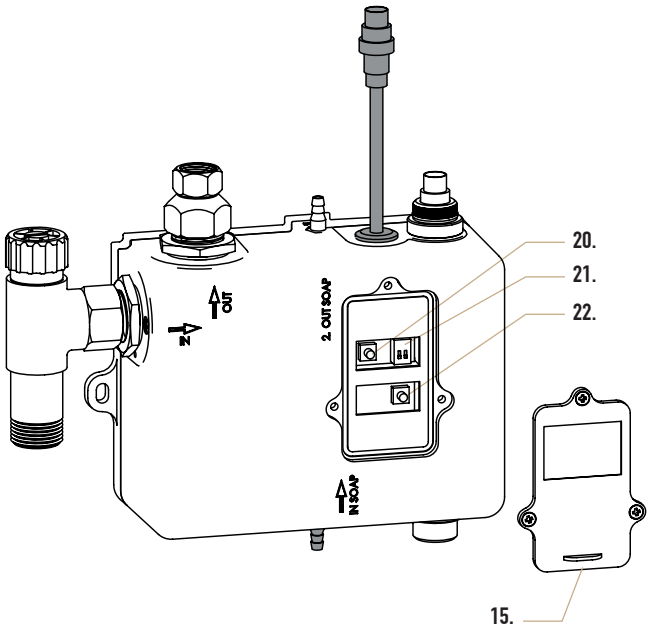

Adjust the time of dispensing soap	Switch 1	Switch 2
0.5 seconds	Off	Off
1.2 seconds	On	Off
1.5 seconds	Off	On
2 seconds	On	On

Dual Sensor Water/Soap Dispenser Installation Manual

