

# Drop-In Sink with Stud Welds and Brackets

## Installation Instructions

### TOOLS REQUIRED (not included)

Pencil  
Saber Saw, Keyhole Saw, or Router  
Power Drill  
Silicone Caulk  
Safety Glasses and Cut-Resistant Gloves  
Wrench

### PARTS:

- Drop-In Sink
- Weld Studs and Brackets
- Cutout Template  
(Available on item page)



## Installation Instructions

Remove all contents from carton. Inspect the drop-in sink for any damage prior to installing. Damaged units should not be installed.

1. Place drop-in sink cutout template at desired location on countertop. This should be cut out along the indicated cut line. Ensure front edge of the drop-in sink is parallel to the countertop edge.
2. Using a pencil, carefully trace along the cutout template cut line onto the countertop. Remove the template from the countertop.
3. Drill a pilot hole inside the cut line.
4. Place the saw inside of the pilot hole and carefully saw along the cut line.
5. Remove the countertop cutout section.
6. Align the drop-in sink in the open space to mark where the four weld studs need to be drilled into the counter.
7. After marking, drill through the counter for each corner of the drop-in sink.
8. Apply sealant around the perimeter of the drop-in sink cut-out. Carefully place the drop-in sink in the cutout hole.
9. Slide the brackets over each weld stud and screw on the nuts. Use a wrench to tighten each nut to secure the drop-in sink to the countertop.
10. Clean away any excess caulk or debris with a cloth. Install drain(s).

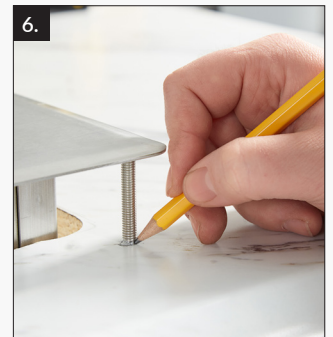

# Drop-In Sink with Mounting Clips

## Installation Instructions

### General Recommendations

Read installation and maintenance instructions thoroughly before installation. Be sure to use proper tools and always wear personal safety accessories for your protection.

### Long-Life Care

Steel sinks are easy to keep looking new with minimal care. For best results, always rinse with a mild soap and wipe after each use. Rub lightly with a soft cloth in the direction of the grain line on a regular basis. To avoid damage and discoloration to the sink surface, never use a steel wool or scouring pad.



### Tools Required

Tape Measure	Ear Protection
Pencil (NOT Ink)	Eye Protection
Silicone Adhesive Sealant	Hacksaw/Jigsaw
Rags	Mounting Clips (Included)

## Installation Instructions

Please carefully read complete instructions before beginning installation.

**Note: These instructions are for installation with solid surface, composite material countertops. It is recommended that a professional countertop installer installs this unit using the instructions below.**

1. Unpack the new sink and check the contents of the materials supplied: Sink and mounting brackets. (Cutout template is available online)  
Place the template on the countertop. Ensure the template is centered on the counter so that it is parallel to the counter edge and the installation hole will not interfere with the structure of the cabinet.
2. Tape the template to the countertop to keep it in place and trace the cutout line on the template with a pencil.



4. Using the appropriate cutting tool for the surface you're cutting, drill a pilot hole.
5. Cut the countertop opening.  
Place the sink into the installation hole to verify the fit. Adjust the cutout if necessary.
6. Attaching the mounting clips:  
Attach the top-mount clips to the sink.

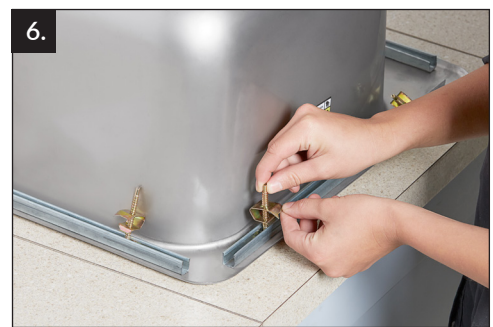
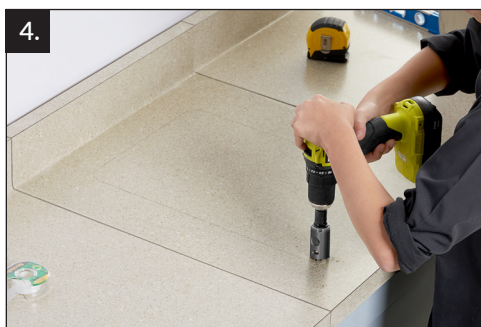

8. Apply silicone sealant (not included) around the underside and lip of the sink.
9. Carefully lower the sink into the counter.
10. Tighten the screws on the top-mount clips evenly until the sink is flush with the counter. Do not overtighten.
11. Wipe excess sealant with a rag.
12. Connect drain and water supply according to manufacturer's instruction.

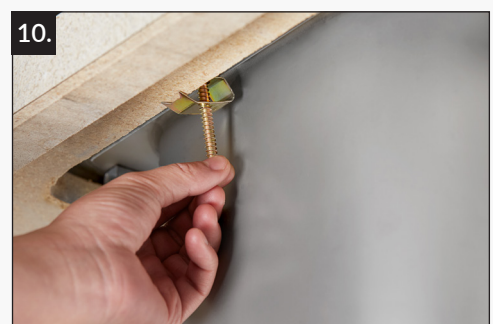

# Drop-In Sink with Side Splash

## Lip Installation Instructions

### WARNING:

Risk of personal injury. Stainless steel edges are sharp and can cause cuts. Use gloves and handle with care.

#### Method 1

Follow above instructions whether your drop in unit comes with stud welds or mounting clips.  
Align the sink with the front edge of your countertop.

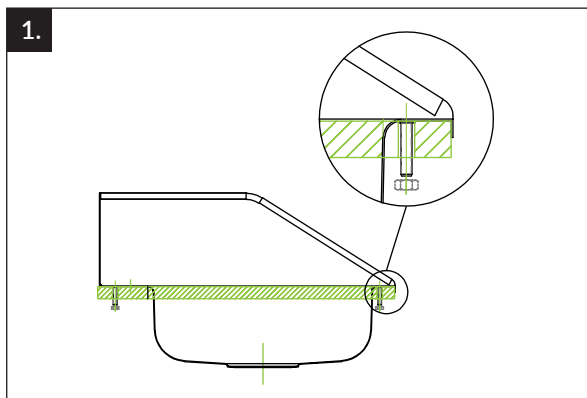

#### Method 2

Hide the sink lip by cutting a small section of your countertop.

