

INSTALLATION GUIDE

STAINLESS STEEL DRAWER



EASY TO INSTALL

This drawer is easy to install with the included Z brackets. Improper installation voids any warranty.

PRIOR TO INSTALLATION

- If you bought your table and drawers at the same time, install the drawers before you assemble the table.
- If you are mounting drawers to an existing table, you can easily remove the tabletop by using an allen wrench to unscrew the legs from the tabletop's gussets and lifting it off.

NOTE DO NOT attempt to install the drawer without disassembling the table first.

INSTALLING THE DRAWER

- 1** Set the tabletop upside down on a surface that won't scratch it before assembling the drawer.

- 2** Attach the Z bracket to the top of the frame with screws. Make sure that the top of the bracket goes outward and the bracket extends a bit further back than the rear of the frame.

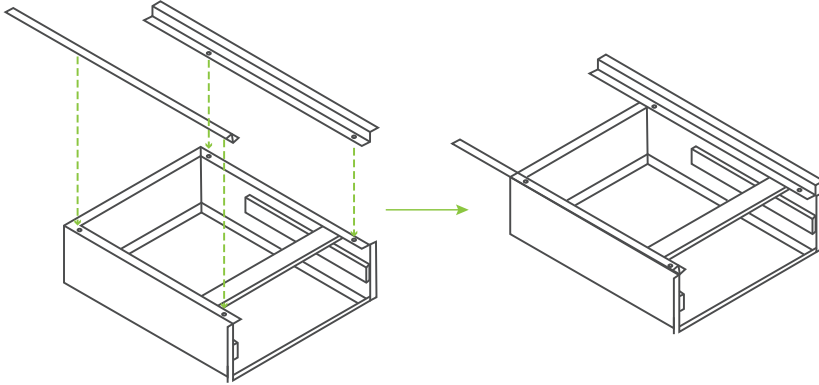

- 3** Flip the drawer over and align it where you want to mount it.

- 4** Try this once with the drawer in the frame to make sure the door will clear the lip of the table. If it doesn't, you'll need to shim with some nuts between the hat channel and the brackets.

- 5** Drill holes in the hat channels and attach the drawer to the table with self-tapping sheet metal screws.

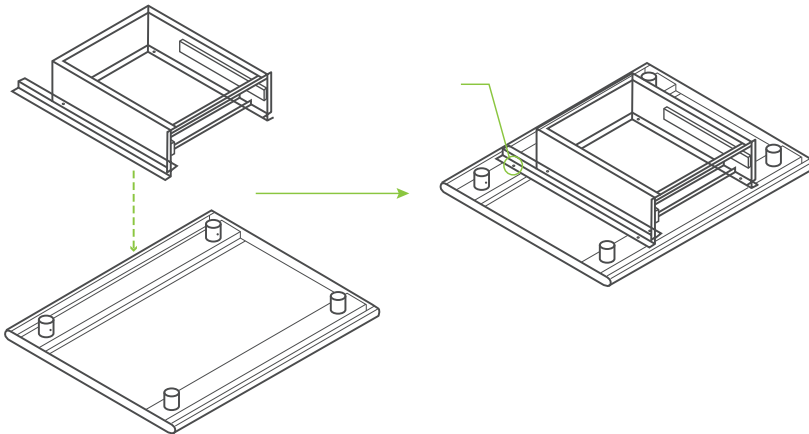

- 6** Reattach the top shelf to the tabletop undershelf and legs and place the pan inside the drawer.

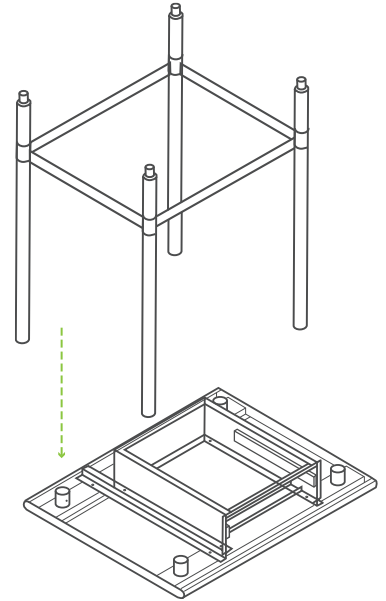

7 (Optional)

Assemble the table undershelf and legs.

