

**-SPECIFICATION-**  
**MODEL: QF081277WLF**

**Standard Features and Specs**

- \* 4" thick NAKS-XPS4 insulation providing R-29 for coolers and R-32 for freezers
- \* 50 year thermal warranty on insulation
- \* 15 year panel warranty
- \* 1 year parts warranty
- Standard Features and Specs
- \* 30" x 76" Left hinged flush door
- \* Temperature regulating thermostat heater wire and heated relief vent on freezer doors
- \* 2 super cam-rise spring assisted hinged
- \* Interior safety lock release handle
- \* Spring actuated door closer
- \* Digital LED thermometer with pilot light switch
- \* Vapor-proof light centered on interior jamb
- \* 26 guage Acrylume, corrosion resistant, stucco embossed on all interior and exterior surfaces.
- \* Smooth aluminum interior floor rated at 600 lb/sq-ft of uniformly distributed load
- \* Walk-in freezer door electrical 115/1/60, 2.2 amp
- \* 30" x 76" Left hinged flush door
- \* Total shipping weight: 1487 lb (1 pallets)

**Refrigeration:**

Customer Approval:

\_\_\_\_\_

Quick Ship Indoor Walk-In, 8' W x 12' L x 7'-7" H Freezer, With Aluminum Floor, Door Centered on Width Side, LHH  
Door

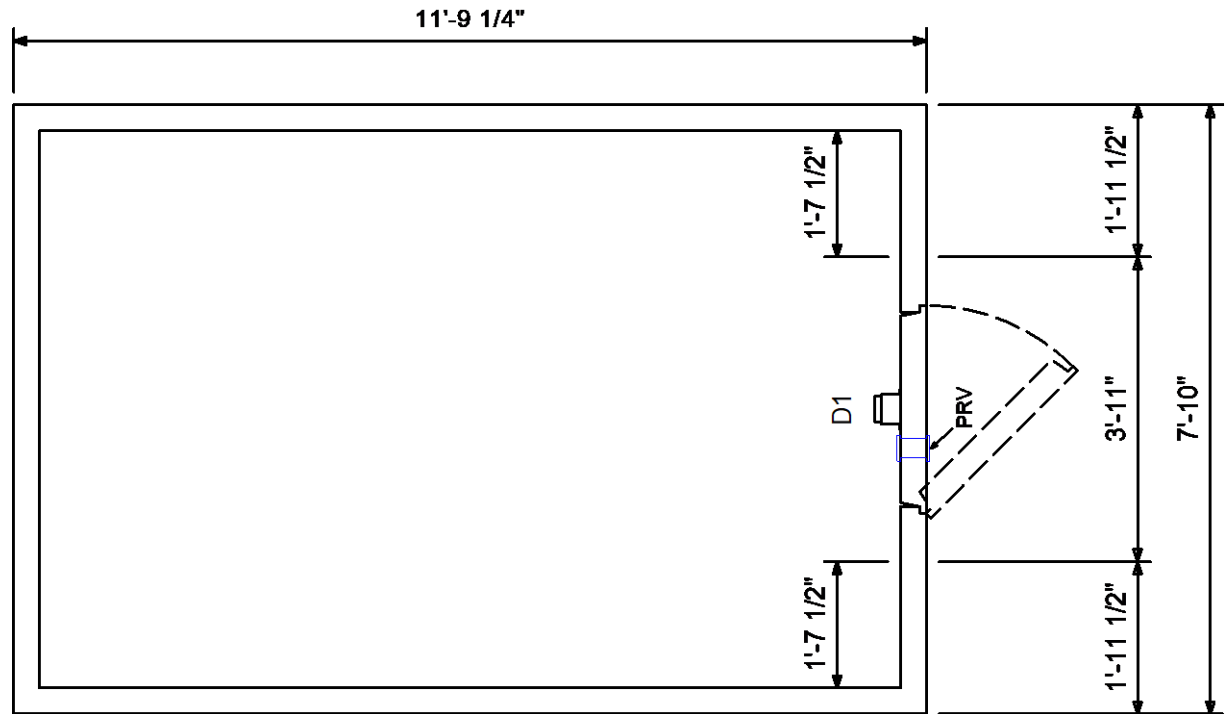

|                    |  |                  |  |
|--------------------|--|------------------|--|
| Quote #: Revision: | Project: 8 x 12 x 7'7 Indoor Freezer With Floor (Width Side) | Date: 08/29/2020 |  |
|                    | Page 1 of 3  |                  |  |

**-SPECIFICATION-Continued**

By others

**Notes:**

- \* Refrigeration is sized based on holding use, no product load was considered. For product load consult factory
- \* Allow a minimum of 2" clearance around all sides of the walk-in for proper air circulation
- \* Floor must be level for proper walk-in installation
- \* Walk-in shipment lead time is subject to terms and conditions
- \* Specifications subject to change without notice

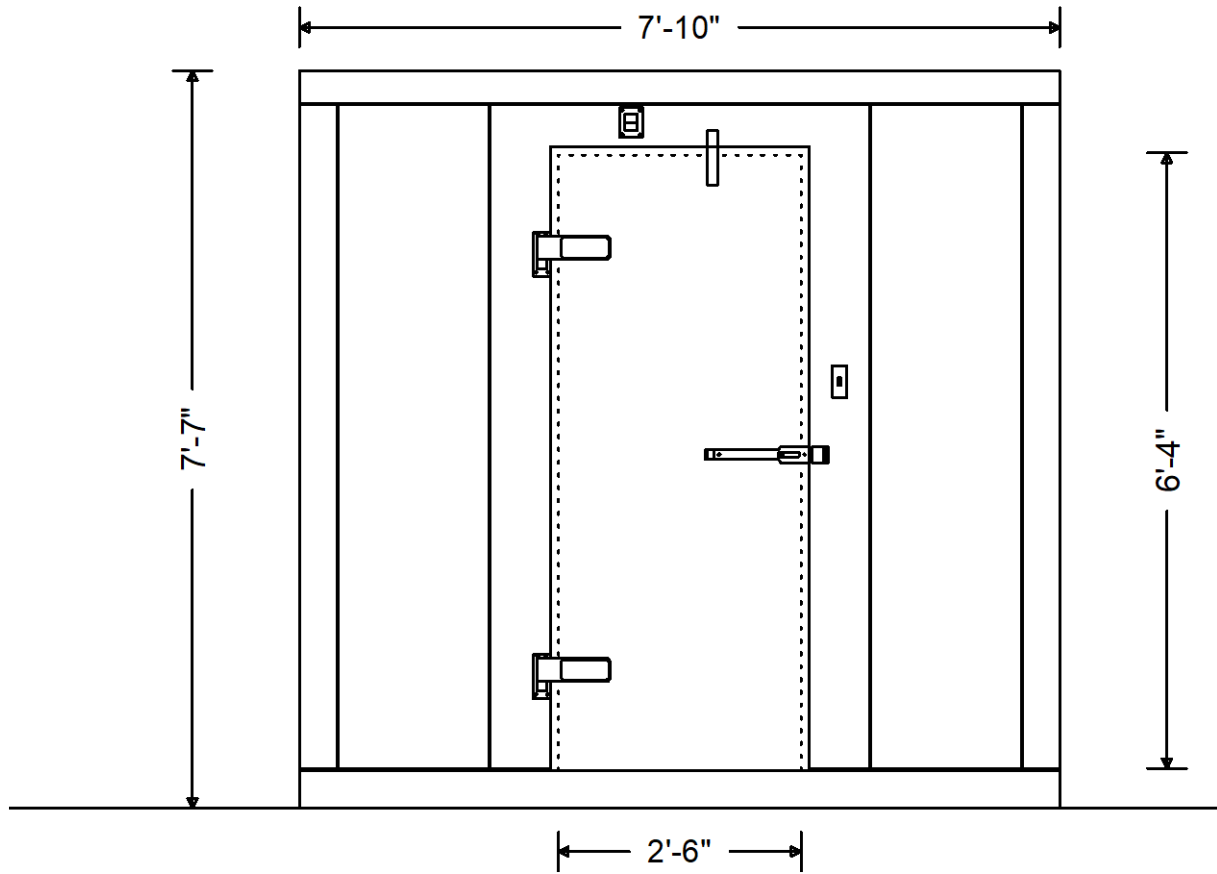

Customer Approval:

\_\_\_\_\_

|                    |  |                  |  |
|--------------------|--|------------------|--|
| Quote #: Revision: | Project: 8 x 12 x 7'7 Indoor Freezer With Floor (Width Side) | Date: 08/29/2020 |  |
|                    | Page 2 of 3  |                  |  |

See customer label note

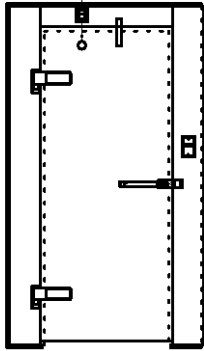

D1

Quote #: Revision:

Project: 8 x 12 x 7'7 Indoor Freezer With  
Floor (Width Side)

Date: 08/29/2020

Page 3 of 3